DEDICA MAESTRO EC900

COFFEE MACHINE
Instruction for use



For more details please check out the
De'Longhi How to videos



DeLonghi

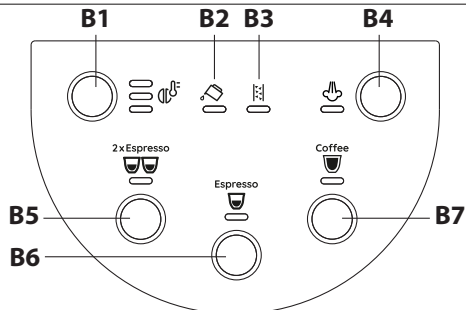
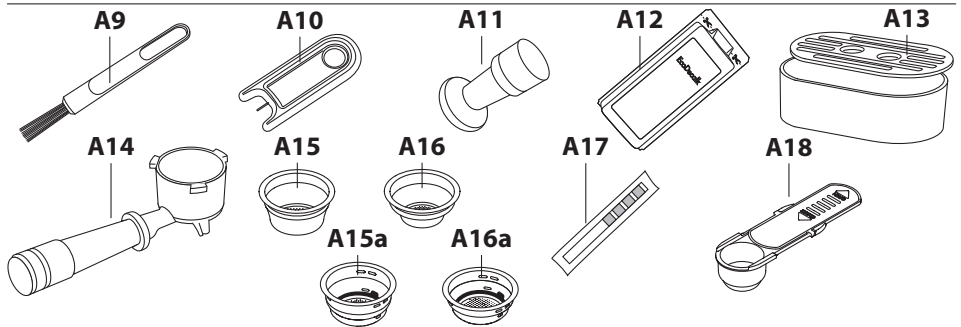
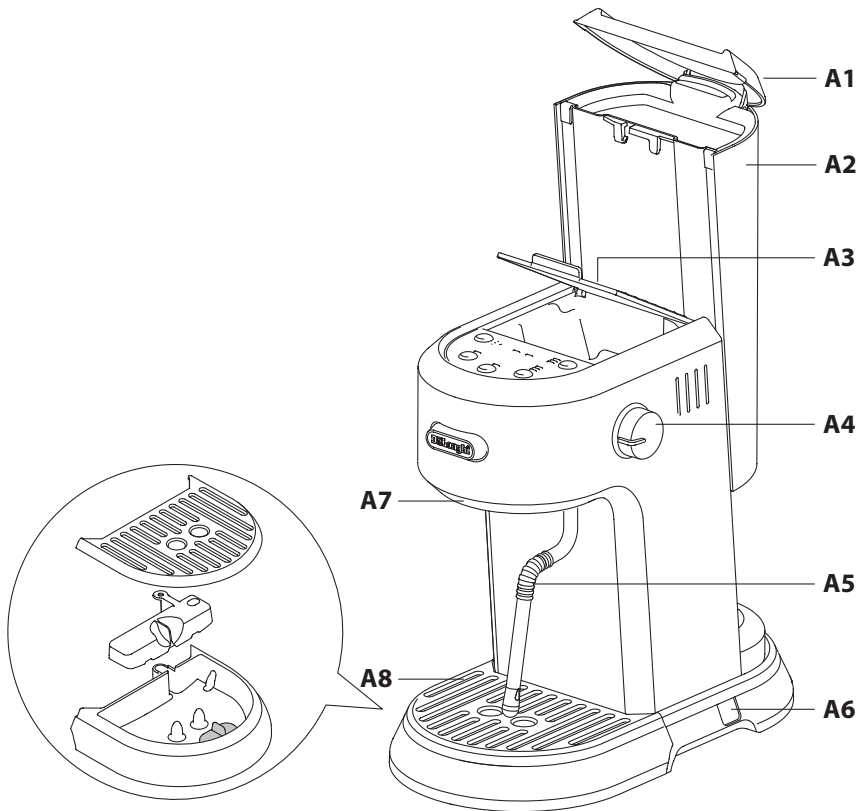

Before using the appliance, always read the safety warnings.

This appliance shall not be used by children.
Keep the appliance and its cord out of reach of children

1. DESCRIPTION OF APPLIANCE

- A1. Water tank lid
- A2. Water tank
- A3. Accessory door
- A4. Steam dial
- A5. Steam wand
- A6. On/Off switch
- A7. Coffee spout
- A8. Drip tray
- A9. Brush
- A10. Cleaning needle
- A11. Tamper
- A12. Descaler (some models only)
- A13. Small cup tray
- A14. Filter holder
- A15. 2 cups filter (single wall filter basket)
- A15a. 2 cups filter (double wall filter basket)
- A16. 1 cup filter (single wall filter basket)
- A16a. 1 cup filter (double wall filter basket)
- A17. Water hardness test indicator paper
- A18. Measuring spoon

1.1 Control panel

- B1. Infusion temperature button
- B2. Water tank indicator light
- B3. Descale indicator light
- B4. Steam button
- B5. 2 x Espresso button
- B6. Espresso button
- B7. Coffee button

2. FIRST USE

- Wash and dry all accessories, including water tank (A2) with warm water and soap. The drip tray and small cup tray, are dishwasher safe.

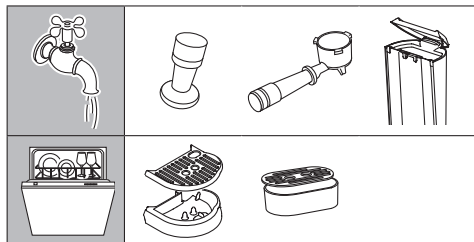

- Extract the water tank by pulling it upwards (fig 1).

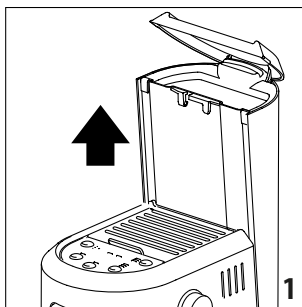

- Open the water tank lid (A1) and fill the water tank (A2) with fresh clean water, taking care not to exceed the MAX level (fig 2).



- Put the water tank back in the machine, pressing lightly to open the valves located on the bottom of the tank.
- Connect the appliance to a mains socket. Turn the machine on by pressing the On/Off switch (A6) (fig. 3).

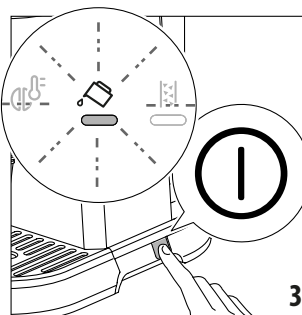

- Place a container with a minimum capacity of 100 ml under the steam wand (A5).
- Turn the steam dial (A4) (fig.4) and wait until delivery from steam wand stops, then turn the dial back.
- Empty the container.



Before using the coffee maker, the internal circuits of the machine must be rinsed. Proceed as follows:

- Place the cups filter (A15), (A15a), (A16) or (A16a) in the filter holder (A14).
- Attach the filter holder to the machine aligning the filter holder handle with "INSERT", then turning the handle to the right until it is aligned in the "CLOSE" position (fig. 5).

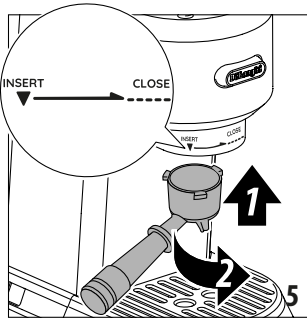

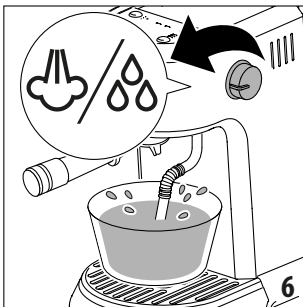

- Place a container under the filter holder and steam wand (A5).
- Press the Espresso (B6) button. The appliance delivers water from the filter holder. Repeat this operation 5 times.
- Turn the steam dial (A4) (fig. 6) and deliver from the steam wand to empty the water tank, then turn the dial back. This is to purge the steam circuit before frothing or steaming your milk.

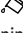

Please note: Never operate the machine without water in the water tank or without the tank.

The appliance has a water levels sensor.

If while brewing the selected beverage, the  (B2) indicator light blinks, the water in the water tank is running out. It is possible to complete the delivery of the selected beverage.

The  (B2) indicator turns on when the water tank is empty. Fill the water tank with fresh water.

It is normal for there to be water in the space under the tank. This should therefore be dried regularly with a clean sponge.

3. MAKING COFFEE

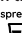
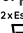
- Turn the machine on by pressing the On/Off switch (A6) (fig. 3). If the machine is in stand-by mode, press any button on the control panel.
- The  and  indicator lights blink to indicate the machine is heating up (fig. 7).

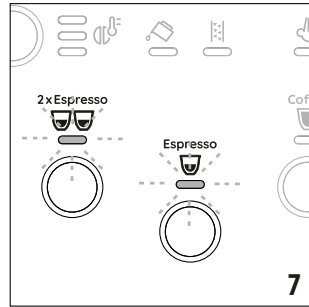

When the lights stop blinking and all the indicator lights on the control panel remain on steadily, the machine is ready for use.

- Place the cup filter (A15), (A15a), (A16) or (A16a) in the filter holder (A14) (fig. 8).

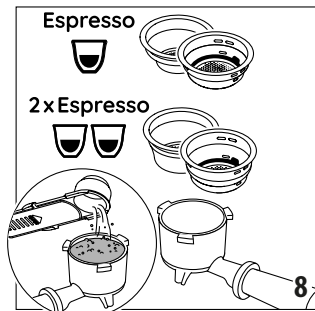

Single wall filter baskets (A15) (A16), also known as non-pressurized filter baskets, are recommended for more experienced baristas when using high quality grinders with fine espresso grinding capabilities. They require

optimal precision over grind size, dose and tamping and are less forgiving than double wall filter baskets.

Barista Tips: Expert baristas prefer to use single wall filter baskets because they allow more control and precision over extraction, to create a full body espresso and richer flavor.



Double wall filter baskets (A15a)

(A16a), also known as pressurized filter baskets, are recommended when using pre-ground coffee, or when the grind size is too coarse. They are easier to use, more forgiving and can help mask inconsistency in the user preparation such as incorrect grind size, dosing or tamping.

Barista Tips: If you are just at the beginning of your espresso journey, we suggest starting with these baskets until you build your expertise and feel comfortable to upgrade to the single wall filter baskets.

- Fill the cup filter with ground coffee using the measuring spoon (A18). Make sure that you are using a fine grind, specific for espresso.
Before filling the coffee filter with ground coffee, make sure there are no coffee residues left in the filter from the last time you made coffee.
- Tap the filter holder several times to distribute the coffee evenly in the cup filter.
- Press down firmly with the tamper (A11). Make sure the coffee is at the recommended dose level after tamping (fig. 9).

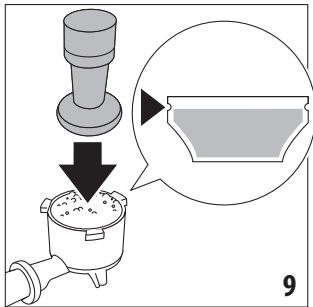

You may need to add some coffee. Tamping correctly the ground coffee is essential to obtain a good espresso. If you press too firmly, the coffee will be delivered slowly and will be strong. If you press too lightly, the coffee will be delivered quickly and will be weak.

Barista Tips: Before placing the filter holder into the machine, run a short flow of water through the coffee spout (A7). This will stabilise the temperature before the extraction.

- Remove any excess coffee from the rim of the filter holder and attach the filter holder to the machine (fig. 5).
- Place one cup or two cups on the drip tray (A8) under the

filter holder spouts. Use small cup tray (A13) for smaller cups.

3.1 Coffee preparation temperature

The water temperature is controlled during the entire preparation process to ensure its stability during the extraction step. The machine has 3 infusion temperatures.

The temperature effectively utilized will depend typically on the variety of beans and the roast: Robusta beans require a lower temperature, and Arabica beans a higher temperature. The same applies for dark roasted beans or for light roasted beans, respectively.

- Press (B1) to set the desired level of infusion temperature:

Temperature level	Corresponding indicator light	Roast level
Min (~ 92°C)		Dark
Med (~ 94°C) (default)		Medium-dark
Max (~ 96°C)		Light - medium

- Press (B6), (B5) or (B7). The machine proceeds to make the coffee and delivery is interrupted automatically. While the machine is making coffee, delivery can be interrupted at any moment by pressing the button pressed previously.
- To remove the filter holder, turn the handle from right to left. To avoid splashes, never remove the filter holder while the machine is delivering coffee. Always wait for a few seconds after delivery.



Please note: You are recommended to warm the cups before making coffee:

Rinsing them with a little hot water or attach the filter holder (A14) to the machine with the cup filter (A15), (A15a), (A16) or (A16a) in place but without adding coffee, using the same cup as will later be used to make the coffee, press the (B6) button and deliver hot water into the cup to heat it.

3.2 Programming the quantities of coffee in the cup

The machine is set by default to automatically deliver standard quantities. To change these quantities, proceed as follows:

- Press the , or button and hold for a least 3 seconds, until the indicator light relative to the selected drink starts to blink, indicating that the machine is in programming mode.
- The coffee maker starts delivering coffee.
- When the desired quantity has been reached, press the , or button again: the quantity is programmed.

	Default quantity	Programmable quantity
Espresso 	35ml	from ≈20 to ≈90 ml
2x Espresso 	70ml	from ≈40 to ≈180 ml
Coffee 	120ml	from ≈80 to ≈180 ml

To return to the quantities of default see instructions in section 6.4.

4. MAKING MILK BEVERAGES

- Fill a jug with fresh cold milk. Milk will up to triple in volume. For a denser more even froth, you must use milk at refrigerator temperature (about 5°C).
- Place the jug under the steam wand (A5) (fig. 10).

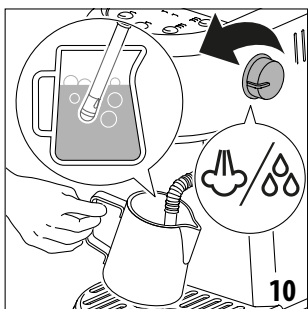

- Press the  (B4) button. The indicator light blinks. When the indicator light comes steady, the appliance is ready to deliver steam.
- Turn the steam dial (A4); the machine proceeds to make the froth.

Please note: Verify to turn the dial completely.



- Once the milk is heated to the desired temperature, press the  (B4) button, then turn the steam dial back.
- Wait till steam stops completely before removing the milk jug.
- After every use, remove with a soft damp cloth any milk residues from the steam wand. Use the steam for a deeper cleaning. Wait that the steam wand cool down and open the hole of the nozzle with the cleaning needle (A10) (fig. 11).

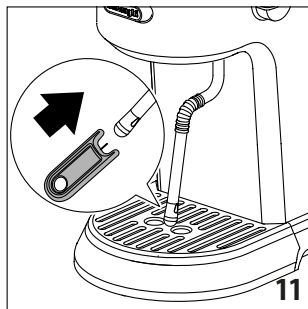

Barista tips: Fresh milk is recommended. Always use fresh milk straight from the fridge.

For best results, always place the jug in the fridge when not in use.

Whole milk is recommended. The appearance and texture of froth depending on the nature of the dairy milk or vegetable beverages utilized.

After frothing the milk, eliminate unwanted bubbles by swirling the jug gently.

When steam is ready, before frothing milk, position an empty container under the frother and open the dial for a few seconds to eliminate any air left in the circuit. Close the dial again and proceed.



5. MAKING HOT WATER

- Place a container under the steam wand (A5).
- Wait for the coffee lights to come on steadily.
- Turn the steam dial to the  position. Hot water is delivered from the steam wand.
- To stop hot water delivery, close the dial

Please note: You should not deliver hot water for more than 60 seconds

6. MENU SETTINGS

Press and hold the  (B1) and  (B4) buttons for 3 seconds to enter the menu settings.



The  (B2) and  (B3) indicator lights blinks.

The following settings will be saved after few seconds, when appliance exit automatically by menu setting.





6.1 Delay time between pre-infusion and infusion

Increasing the delay changes the time the water comes into contact with the coffee, changing the flavor profile.

To set the delay time, press  (B1) button:

-  No preinfusion delay
-  1 second (default)
-  2 seconds

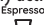

6.2 Descale

To set descale function, press  (B6) button; the  (B3) indicator light blinks and the  indicator light turns on. Press and hold the  (B6) button for 3 seconds to start descaling (see instructions in section Descaling).

If you accidentally activate descaling, you can stop it by pressing and holding the  (B6) button for at least 10 seconds.



6.3 Auto-off

To set the Auto-off time press  (B7) button:

-  5 minutes (default)
-  1.5 hour
-  3 hour



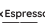



If the machine is in Auto-off mode, press any button on the control panel to turn on the appliance.

6.4 Default values

To reset the default values press  (B5) button; the indicator light blinks. Press and hold the  (B5) button for 3 seconds to resets all menu settings. All settings will be restore to factory.

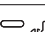
6.5 Water hardness

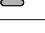
To set the one of the 3 levels of water hardness, press  (B4) button:

Water Hardness Test Result	Corresponding indicator light	Level
■	 	1 soft water
■ ■	 	2 medium water
■ ■ ■ ■ ■ ■ ■ (default)	 	3 hard or very hard water

6.6 Measuring water hardness

The  (B3) indicator light comes on following a predetermined period of operation that depends on a water hardness setting. The machine can also be programmed according to the actual hardness of the local water supply, in which case descaling may

be required less frequently.

- Remove the water hardness test indicator paper (A17)  from its pack.
- Immerse the paper completely in a glass of water for one second.
- Remove the paper from the water and shake lightly. After about a minute, 1, 2, 3, or 4 red squares form, depending on the hardness of the water.

7. CLEANING

Important: Before maintenance or cleaning of the appliance, turn it off, unplug from the main socket and allow to cool.

Do not use solvents, abrasive detergents or alcohol to clean the coffee machine.

Do not use metal objects to remove encrustations or coffee deposits as they could scratch metal or plastic surfaces.

The drip tray and small cup tray, are dishwasher safe.

If the machine is not used for more than one week, before using it again, we strongly recommend you perform a rinse cycle.

The following parts of the machine must be cleaned and dry regularly:

- **drip tray (A8):** the drip tray should be emptied and cleaned after each use or when the level indicator (red) rises through the metal grid. Remove the drip tray, empty the water and clean the drip tray with a cloth, dry and then reassemble the drip tray until you hear a 'click'.
- **caps filter (A15) (A16):** After using the appliance, always rinse the filters under abundant running water. Use the brush (A9) to clean (fig. 12).
- **caps filter (A15a) (A16a):** Extract the perforated filter by pulling the tab and rinse the filters under running water. Make sure the holes are not blocked. If necessary, clean with a needle (fig. 12). Wipe dry with a cloth. Reposition the perforated filter in its seat and push fully home.

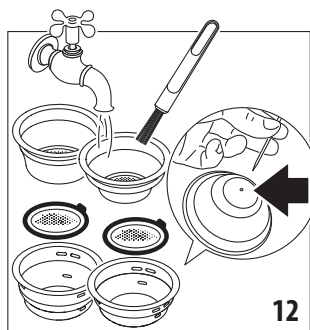

- **coffee spout (A7):** After every 200 coffees, rinse the cof-

fee spout by delivering about 0.5 l of water from the coffee spout (press the  (B6) button without using ground coffee).

- **water tank (A2):** Clean the water tank regularly (about once a week) and whenever you replace the water softener filter (if present) with a damp cloth and a little mild washing up liquid, especially internally in the sensor area (fig. 13); rinse with running water.

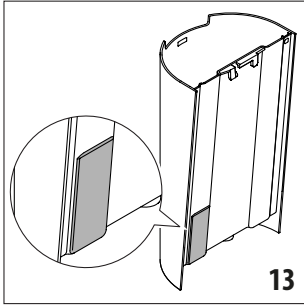



- **steam wand (A5):** After every use, remove with a soft damp cloth any milk residues from the steam wand. Turn the steam dial (A4). The appliance delivers water from the steam wand.
Wait that the steam wand cool down and open the hole of the nozzle with the cleaning needle (A10) (fig. 11).

8. DESCALING





Before use, read the instructions and the labelling on the descaler pack.

It is important to use De'Longhi descaler only. Using unsuitable descaler and/or performing descaling incorrectly may result in faults not covered by the manufacturer's guarantee.



Descaler could damage delicate surfaces. If the product is accidentally spilt, dry immediately.

- Descale the machine when the  (B3) indicator lights turns on.
- Remove and empty the drip tray (A8), then reposition it in the machine.
- Empty the water tank (A2) (if present, remove the water softener filter).
- Pour the descaler into the water tank up to the level 'A' marked on the inside of the tank (corresponding to the contents of one 100 ml pack).
- Add water (1 litre) up to level 'B'. Now reposition the water tank in the machine.
- Make sure the filter holder (A14) is not attached and position a recipient under the hot coffee spout (A7) and steam wand (A5).
- Press and hold the  (B1) and  (B4) buttons for 3 sec-

onds.

- Press  (B6) button; the  (B3) indicator light blinks and the  indicator light turns orange.
- Press and hold the  (B6) button for 3 seconds to start descaling. The indicator light (B6) starts blinking.
- Turn the steam dial to the  position .
- The descale programme starts and the descaler liquid comes out of the steam wand and coffee spout . The descale programme removes limescale deposits from inside the appliance by automatically performing a series of rinses and pauses until the water tank is empty.

Please note: During descaling, to clean the coffee spout, close the steam dial from time to time to deliver small quantities of descaler from the coffee outlet.

- Delivery stops and the  (B2) indicator light turns on, the  indicator light turns white.
- Fill the water tank to MAX level with fresh water and empty the recipient used to collect the descaler solution and replace it empty.
- Press the  (B6) button to start the rinse cycle and turn the steam dial.

Please note: During rinse cycle to clean the coffee spout, close the steam dial from time to time to deliver small quantities of water from the coffee outlet.

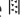
- When the rinsing process is over, the  (B3) indicator light goes out and descaling is complete and the appliance is ready to use.
- Turn the steam dial back.

Please note: If you accidentally activate descaling, you can stop it by pressing and holding the  (B6) button for at least 10 seconds.



9. TECHNICAL DATA

Voltage:	220-240V~ 50-60Hz
Absorbed power:	1450W
Max. water tank capacity:	1.6 l
Size LxDxH:	189x346x328 mm
Weight:	4.5 kg



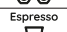

10. STATISTICS

This mode allows you to have all the statistics data.

- Make sure the machine is turned off.
- Press and hold the  (B5) button for 3 seconds and simultaneously press the On/Off switch (A6) to enter the Statistics settings.
- Press the following buttons to select the appliance's data:

Buttons	Data
 2x Espresso	water quantity delivered (liters)
 Espresso	total numbers of coffee beverages
 Coffee	total numbers of descalings
	total numbers of steam delivered

10.1 Indicator light

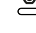
	number of blinks to indicate units (from 1 to 9)
	number of blinks to indicate tens (from 10 to 90)
	number of blinks to indicate hundreds (from 100 to 900)
	number of blinks to indicate thousands (from 1000 to 9000)
	number of blinks to indicate tens of thousands (from 10000 to 90000)

11. TROUBLESHOOTING

Problem	Cause	Solution
There is water in the drip tray (A8)	This water comes from the internal circuits of the machine and is a normal consequence of their operation	Empty and clean the drip tray on a regular basis
No espresso coffee is delivered	No water in the water tank (A2)	Fill the water tank
	Blockage in the cups filter (A15), (A15a), (A16) or (A16a)	Rinse the filters under running water
	The water tank (A2) is not properly in place and the valves at the bottom are not open	Press down lightly on the tank to open the valves at the bottom
	Limescale in the water circuit	Descale the appliance
The espresso coffee drips from the edges of the filter holder (A14) rather than the holes	The filter holder has been inserted incorrectly or is dirty	Attach the filter holder correctly and rotate firmly as far as it will go
	The coffee spout gasket has lost elasticity or is dirty	Clean the coffee spout gasket. Have the coffee spout gasket replaced by Customer Service
The filter holder (A14) cannot be attached to the machine	Too much coffee has been placed in the filter	Use the measuring scoop (A18) supplied and make sure you are using the correct filter for the type of preparation
The coffee crema is too light (delivered from the spout too fast)	The pre-ground coffee is not pressed down firmly enough	Tamp the pre-ground coffee more firmly
	There is not enough pre-ground coffee	Increase the quantity of pre-ground coffee
	The pre-ground coffee is too coarse	Use only pre-ground coffee for espresso coffee makers
	The wrong type of pre-ground coffee is being used	Change the type of pre-ground coffee
The coffee froth is too dark (delivered from the spout too slowly)	The pre-ground coffee is pressed down too firmly	Press the coffee down less firmly
	There is not enough pre-ground coffee	Reduce the quantity of pre-ground coffee
	The espresso coffee spout (A7) is blocked	Clean the coffee spout
	The cup filter (A15), (A15a), (A16) or (A16a) is blocked	Clean the cup filter
	The pre-ground coffee is too fine	Use only pre-ground coffee for espresso coffee makers
	The pre-ground coffee is too fine or damp	Use pre-ground coffee for espresso coffee makers only and make sure it is not too damp



Problem	Cause	Solution
After delivering coffee, the filter remains attached to the coffee spout		Insert the filter holder (A14) again, deliver coffee, then remove the filter holder
The machine will not make any drinks and the water tank light is on	No water in the water tank (A2) or no water tank in the machine	Fill the tank with water or insert the water tank
The water tank indicator (B2) blinking and steam indicator is on (B4).	Air in the hydraulic circuit	Verify water tank position and water presence. Place a container under steam wand (A5). Turn the steam dial (A4) and wait until delivery from steam wand stops, then close steam dial.
The machine will not make any drink and all the lights except (B1) blink	The steam dial (A4) is open	Close the steam dial (A4)
The machine will not make any drink and all the lights flash for a few seconds	No water in the water tank (A2)	Fill the tank with water
	The water tank (A2) is not properly in place and the valves at the bottom are not open	Press down lightly on the tank to open the valves at the bottom
The machine does not function and all the lights flash		Disconnect the machine immediately and contact authorised Customer Services.
No milk froth is formed when making cappuccino	Milk not cold enough	Always use milk at refrigerator temperature
	Steaming procedure could be wrong	Review the "making milk beverage" paragraph
	Frother dirty	Clean the steam wand (A5)
Water sensor in the water tank is not working properly	Water tank is dirty	Clean the water tank internally, and dry the back panel
Descaling led is on	Descaling is required	Perform descaling

Proudly distributed by
De'Longhi Australia Pty Limited
P.O. BOX 4540
CASULA MALL NSW 2170
Customer Service Ph: 1800 126 659
Fax: 1800 706932
www.delonghi.com.au
e-mail: info.au@delonghigroup.com

De'Longhi New Zealand Limited
99 Khyber Pass Road
Grafton 1023
Auckland
New Zealand
P.O. Box 58-056 Botany
MANUKAU 2163
Customer Service Ph: 0508 200 300
Fax: 0508 200 301
www.delonghi.co.nz
e-mail: info.nz@delonghigroup.com

Register Now

www.delonghi.com/register



57132C9030_00_1024