



User Manual

Refrigerator-Freezer

HRF680YPC

HRF680YPS

HRF680YS

Haier

Thank You

Thank you for purchasing a Haier Product.

Please read these instructions carefully before using this appliance. The instructions contain important information which will help you get the best out of the appliance and ensure safe and proper installation, use and maintenance.

Keep this manual in a convenient place so you can always refer to it for the safe and proper use of the appliance.

If you sell the appliance, give it away, or leave it behind when you move house, make sure you also pass this manual so that the new owner can become familiar with the appliance and safety warnings.

Legend



Warning – Important Safety information



General information and tips



Environmental information



Disposal

Help protect the environment and human health. Put the packaging in applicable containers to recycle it. Help to recycle waste of electrical and electronic appliances marked with this symbol with the household waste. Return the product to your local recycling facility or contact your municipal office.

WARNING!

- ▶ Risk of injury or suffocation!
- ▶ Refrigerants and gases must be disposed of professionally. Ensure that the tubing of the refrigerant circuit is not damaged before being properly disposed of. Disconnect the appliance from the mains supply. Cut off the mains cable and dispose of it.
- ▶ Remove the trays and drawers as well as the door catch and seals, to prevent children and pets to get closed in the appliance.

Safety information.....	2
Intended use.....	7
Product description.....	8
Control panel.....	9
Use.....	12
Equipment.....	25
Care and cleaning.....	28
Troubleshooting.....	30
Installation.....	33
Technical data.....	37

Accessories

Check the accessories and literature in accordance with this list:



Warranty
card



User
manual



* Water pipe

Note:*Only for model HRF680YPS/HRF680YPC

Safety information

Before switching on the appliance for the first time read the following safety hints!



WARNING!

Before first use

- ▶ Make sure there is no transport damage.
 - ▶ Remove all packaging and keep out of children's reach.
 - ▶ Wait at least two hours before installing the appliance in order to ensure the refrigerant circuit is fully efficient.
 - ▶ Handle the appliance always with at least two persons because it is heavy.
- ### Installation
- ▶ The appliance should be placed in a well-ventilated place. Ensure a space of at least 10 cm above and around the appliance.
 - ▶ Never place the appliance in a damp area or location where it might be splashed with water. Clean and dry water splashes and stains with a soft clean cloth.
 - ▶ Do not install the appliance in direct sunlight or in the near of heat sources (e.g. stoves, heaters).
 - ▶ Install and level the appliance in an area suitable for its size and use.
 - ▶ **WARNING:** Keep ventilation openings in the appliance or in the in-built structure clear of obstruction.
 - ▶ Make sure that the electrical information on the rating plate agrees with the power supply. If it does not, contact an electrician.
 - ▶ Connect the appliance to the electrical supply (220V-240V 50Hz) with the fitted plug and lead.
 - ▶ Abnormal voltage fluctuation may cause the appliance to fail to start, or damage to the temperature control or compressor, or there may be an abnormal noise when operating. In such case, an automatic regulator shall be mounted.
 - ▶ Do not use multi-plug adapters and extension cables.
 - ▶ **WARNING:** Do not locate multiple portable socket-outlets or portable power supplies at the rear of the appliance.
 - ▶ **WARNING:** When positioning the appliance, ensure the supply cord is not trapped or damaged.



WARNING!

- ▶ Use a separate earthed socket for the power supply which is easy accessible. The appliance must be earthed.

- ▶ **WARNING:** Do not damage the refrigerant circuit.

Daily use

- ▶ This appliance is not intended for use by persons (including children) with reduced physical, sensory or mental capabilities, or lack of experience and knowledge, unless they have been given supervision or instruction concerning use of the appliance by a person responsible for their safety.
- ▶ Children aged from 3 to 8 years are allowed to load and unload, but not allowed to clean or install the refrigerating appliances.
- ▶ Keep away children under 3 years of age from the appliance unless they are constantly supervised.
- ▶ Children should be supervised to ensure that they do not play with the appliance.
- ▶ If cool gas or other inflammable gas is leaking in the vicinity of the appliance, turn off the valve of the leaking gas, open the doors and windows and do not unplug a plug in the power cable of the refrigerator or any other appliance.
- ▶ Notice that the appliance is set for operation at a specific ambient range between 16 and 38 °C. The appliance may not work properly if it is left for a long period at a temperature above or below the indicated range.
- ▶ Do not place unstable articles (heavy objects, containers filled with water) on top of the refrigerator, to avoid personal injury caused by falling or electric shock caused by contact with water.
- ▶ Do not pull on the door shelves. The door may be pulled slant, the bottle rack, may be pulled away, or the appliance may topple.
- ▶ Open and close the doors only with the handles. The gap between the doors and between the doors and the cabinet is very narrow.
- ▶ Do not extend your hands in these areas to avoid pinching your fingers. Open or close the refrigerator doors only when there are no children standing within the range of door movement.
- ▶ Do not store or use inflammable, explosive or corrosive materials in the appliance or in the vicinity.

Safety information



WARNING!

- ▶ Do not store explosive substances such as aerosol cans with a flammable propellant in this appliance.
- ▶ Do not store medicines, bacteria or chemical agents in the appliance. This appliance is a household appliance. It is not recommended to store materials that require strict temperatures.
- ▶ Never store liquids in bottles or cans (besides high percentage spirits) especially carbonated beverages in the freezer, as these will burst during freezing.
- ▶ Check the condition of food if a warming in the freezer has taken place.
- ▶ Do not set unnecessarily low temperature in the refrigerator compartment. Minus temperatures may occur at high settings.
Attention: Bottles can burst
- ▶ Do not touch frozen goods with wet hands (wear gloves). Especially do not eat ice lollies immediately after removal from the freezer compartment. There is the risk to freeze or the formation of frost blisters. FIRST aid: keep immediately under running cold water.
- ▶ Do not pull away!
- ▶ Do not touch the inside surface of the freezer storage compartment when in operation, especially with wet hands, as your hands may freeze onto the surface.
- ▶ Unplug the appliance in the event of a power interruption or before cleaning. Allow at least 5 minutes before restarting the appliance, as frequent starting may damage the compressor.
- ▶ **WARNING:** Do not use electrical devices inside the food storage compartments of the appliance, unless they are of the type recommended by the manufacturer.

Maintenance / cleaning

- ▶ Make sure children are supervised if they carry out cleaning and maintenance. Disconnect the appliance from the electrical supply before undertaking any routine maintenance. Allow at least 5 minutes before restarting the appliance, as frequent starting may damage the compressor.



WARNING!

- ▶ Hold the plug, not the cable, when unplugging the appliance.
- ▶ Do not clean the appliance with hard brushes, wire brushes, detergent powder, petrol, amyl acetate, acetone and similar organic solutions, acid or alkaline solutions. Please clean with special refrigerator detergent to avoid damage.
- ▶ Do not scrape off frost and ice with sharp objects. Do not use sprays, electric heaters like heater, hair dryer, steam cleaners or other sources of heat in order to avoid damage to the plastic parts.
- ▶ **WARNING:** Do not use mechanical devices or other means to accelerate the defrosting process, other than those recommended by the manufacturer.
- ▶ If the supply cord is damaged, it must be replaced by the manufacturer, its service agent or similarly qualified persons in order to avoid a hazard.
- ▶ Do not try to repair, disassemble or modify the appliance by yourself. In case of repair please contact our customer service.
- ▶ Eliminate the dust on the back of the unit at least once in the year to avoid hazard by fire, as well as increased energy consumption.
- ▶ Do not spray or flush the appliance during cleaning.
- ▶ Do not use water spray or steam to clean the appliance.
- ▶ Do not clean the cold glass shelves with hot water. Sudden temperature change may cause the glass to break.

Refrigerant gas information

- ▶ The appliance contains the flammable refrigerant ISOBUTANE(R600a). Make sure the refrigerant circuit is not damaged during transportation or installation. Leaking refrigerant may cause eye injuries or ignite. If a damage has occurred, keep away open fire sources, thoroughly ventilate the room, do not plug or unplug the power cords of the appliance or any other appliance. Inform the customer service. In case of eyes get into contact with the refrigeran, rinse immediately it under running water and call immediately the eye specialist.



WARNING!

This product contains flammable refrigerant isobutane (R600a)
It is hazardous for anyone other than an Authorised Service Person to service this appliance. In Queensland – the authorized Service Person MUST hold a Gas Work Authorisation for hydrocarbon refrigerants, to carry out Servicing or repairs which involve the removal of covers .



The symbol indicates there is a risk of fire since flammable materials are used. Take care to avoid causing a fire by ingiting flammable material.

Intended use

Intended use

This appliance is intended to be used in household and similar applications such as

- staff kitchen areas in shops, offices and other working environments;
- farm houses and by clients in hotels, motels and other residential type environments;
- bed and breakfast type environments;
- catering and similar non-retail applications.

Changes or modifications to the device are not allowed. Unintended use may cause hazards and loss of warranty claims.

Please abandon the refrigerator according to local regulators for it uses flammable blowing gas and refrigerant.

CAUTION!

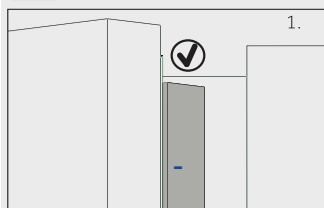

When you close the door, the vertical door strip on the left door should be bent inside (1).

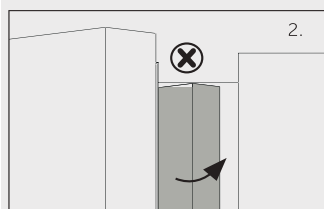

If you try to close the left door and the vertical door strip is unbent (2), you should bend it firstly, otherwise the door strip will hit the fixing shaft or right door. Thus a damage to the door slip or a leak will occur.

There is a heating thread inside the frame. The temperature of the surface will rise a little, which is normal and won't affect the function of appliance.

Product description



Notice

Due to technical changes and different models, some of the illustrations in this manual may differ from your model.

HRF680YPS/HRF680YPC

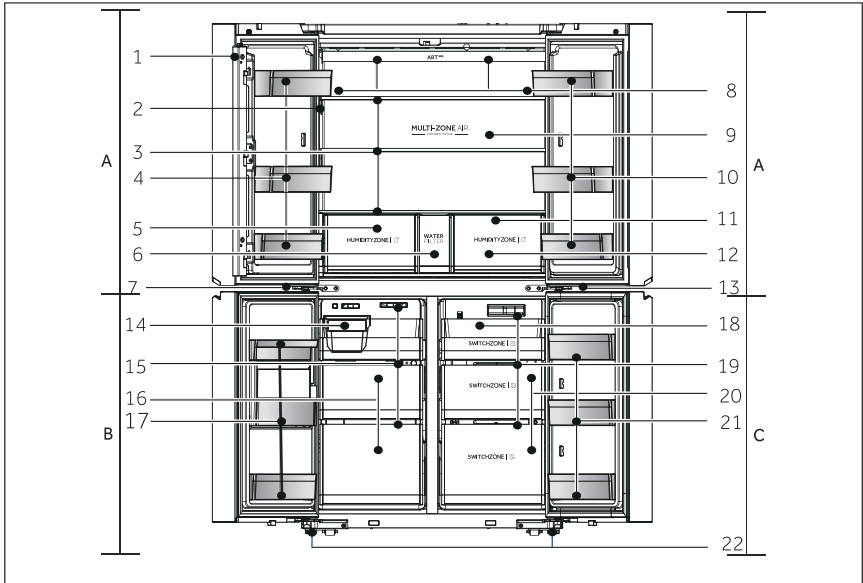

A: Fridge compartment

- 1 Vertical beam
- 2 Control panel
- 3 Cabinet shelves
- 4 Door shelves
- 5 Humidity zone drawer
- 6 Water filter
- 7 Freezer light
- 8 Air duct and sensor (behind panel)
- 9 Fridge compartment light
- 10 Door shelves
- 11 Air duct (behind drawers)
- 12 Humidity zone drawer
- 13 Switch Zone light

B: Freezer compartment

- 14 Ice maker
- 15 Air duct
- 16 Freezer storage drawers
- 17 Door shelves

C: Switch Zone compartment

- 18 Storage tray
- 19 Air duct
- 20 Switch Zone drawers
- 21 Door shelves
- 22 Adjustable feet
- 23 Water dispenser

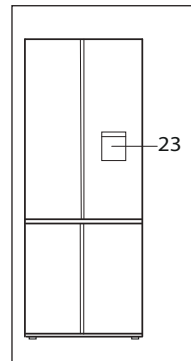

Control panel

Control panel HRF680YPS/HRF680YPC

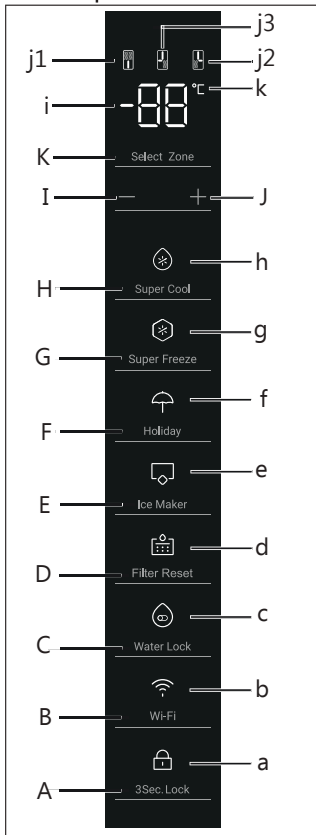

Buttons:

- A Panel lock selector
- B Wi-Fi selector
- C Water Lock selector
- D Filter Reset selector
- E Ice Maker mode selector
- F Holiday mode selector
- G Super Freeze selector
- H Super Cool selector
- I Temperature adjustment button "-"
- J Temperature adjustment button "+"
- K Zone selector

Indicators:

- a Panel lock function
- b Wi-Fi function
- c Water lock function
- d Filter reset function
- e Ice maker mode
- f Holiday mode
- g Super freeze function
- h Super cool function
- i Temperature display
- j1 Fridge indicator
- j2 Freezer indicator
- j3 S-Zone indicator
- k Degree Celsius

Before first use

- ▶ Remove all packaging materials, keep them out of children`s reach and dispose them in an environmentally friendly manner.
- ▶ Clean the inside and outside of the appliance with water and a mild detergent before putting any food in it.
- ▶ After the appliance has been levelled and cleaned, wait for at least 2-5 hours before connecting it to the power supply. See Section INSTALLATION.
- ▶ Precool the compartments at high settings before loading with food. The function Super Freeze helps to cool down the compartments quickly.
- ▶ The refrigerator temperature, Switch Zone temperature and freezer temperature are automatically set to 5°C , - 18°C and -18°C respectively. These are the recommended settings. If desired, you can change these temperatures manually. Please see ADJUST THE TEMPERATURE.

Product description

Notice

Due to technical changes and different models, some of the illustrations in this manual may differ from your model.

HRF680YS

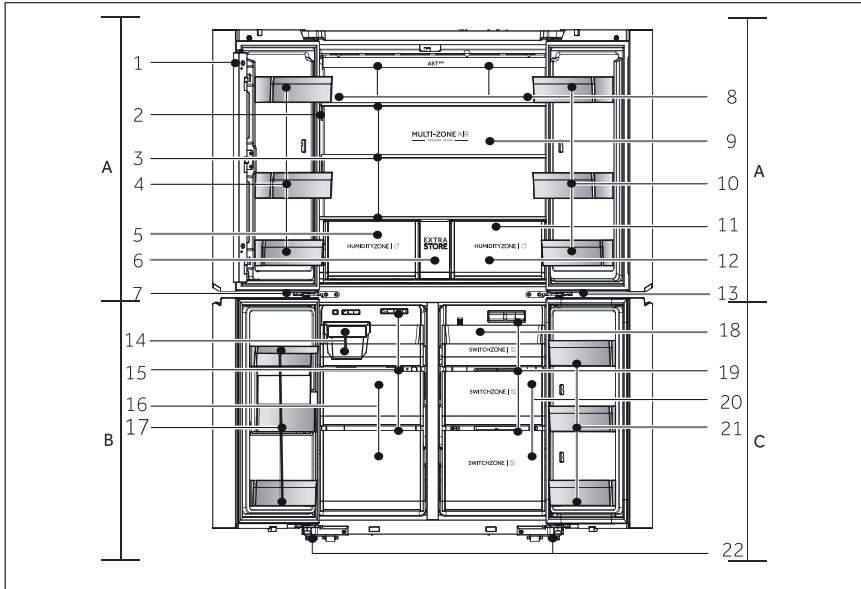

A: Fridge compartment

- 1 Vertical beam
- 2 Control panel
- 3 Cabinet shelves
- 4 Door shelves
- 5 Humidity zone drawer
- 6 Extra store drawer
- 7 Freezer light
- 8 Air duct and sensor (behind panel)
- 9 Fridge compartment light
- 10 Door shelves
- 11 Air duct (behind drawers)
- 12 Humidity zone drawer
- 13 SwitchZone light

B: Freezer compartment

- 14 Storage tray&Ice maker
- 15 Air duct
- 16 Freezer storage drawers
- 17 Door shelves

C: Switch Zone compartment

- 18 Storage tray
- 19 Air duct
- 20 Switch Zone drawers
- 21 Door shelves
- 22 Adjustable feet

Control panel

Control panel HRF680YS

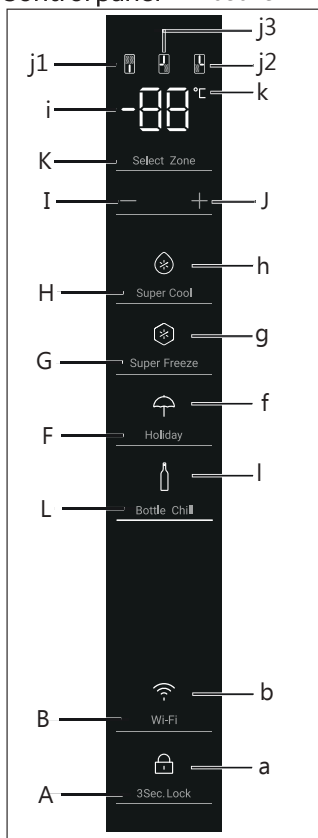

Buttons:

- A Panel lock selector
- B Wi-Fi selector
- F Holiday mode selector
- G Super Freeze selector
- H Super Cool selector
- I Temperature adjustment button "-"
- J Temperature adjustment button "+"
- K Zone selector
- L Bottle Chill selector

Indicators:

- a Panel lock function
- b Wi-Fi function
- f Holiday mode
- g Super freeze function
- h Super cool function
- i Temperature display
- j1 Fridge indicator
- j2 Freezer indicator
- j3 S-Zone indicator
- k Degree Celsius
- l Bottle chill function

For plumbed models (HRF680YPS/HRF680YPC)

Before first use, you need to flush water through the filter to remove impurities or trapped air in the water tank and filter system.

Water

- Press the water dispenser **pedal** to dispense 4L of water - wait for 4 minutes before dispensing again.
- Dispense 4L of water and then wait for another 4 minutes - There may be carbon residue dispensed together with water. This is not harmful and normal during the flushing process.
- Dispense another 4 L of water. - This prevents excessive dripping of water from your dispenser.
- There may be a few drips of water coming out of the dispenser for a few days after installation. This is to clear the remaining trapped air in the dispenser.
- Ensure your refrigerator has cooled for at least 2 hours before use.

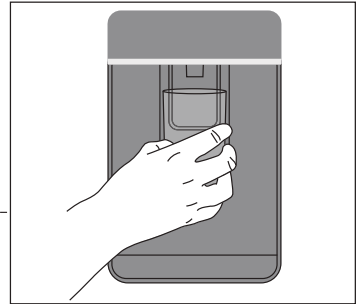

Ice Maker

- 1 Press control panel button "E" to turn on the ice maker function.
- 2 Discard the first full bin of ice. Clean the ice **bin** with water and install it back. Your ice maker is now ready for use.
- 3 Repeat step 2 to remove dust in the ice **bin** collected during manufacture and transport.
- 4 Empty the water, dry the bin and return it correctly.
- 5 Once your Ice maker is turned on the first bin of ice may be discoloured. This is not harmful and normal during the flushing process. Discard the first full bin of ice made. Your Ice maker is now ready for use.



Notice

The performance of your water filter will increase with use, reaching optimum performance after two to three full bins of ice.

Sensor keys

The buttons on the control panel are sensor keys, which already respond when lightly touched with the finger.

Switch on /off the appliance

The appliance is in operation as soon as it is connected to the power supply. When the refrigerator is first powered on, the indicator "i" (Temperature display) illuminates.

The fridge temperature, Switch Zone temperature and freezer temperature are automatically set to 5 °C, -18 °C and -18 °C respectively.

Maybe the panel lock is active.



Notice

The appliance is preset to the recommended temperature of 5 °C (Refrigerator) -18 °C (Switch Zone) and -18 °C (Freezer). Under normal ambient condition you need not to set a temperature.

When the appliance is switched on after disconnection from the main power supply, it may take up to 12 hours for the correct temperatures to be reached.

Empty the appliance before switching off. After switch of the appliance, pull the power cord out of the power socket.

Lock/unlock panel

Under Lock state, long press key "A" for 3 seconds, the panel lock will be unlocked.



Notice

The control panel is automatically blocked against activation if the doors are closed and 30 seconds no button is pressed. For any settings the control panel must be unlocked.

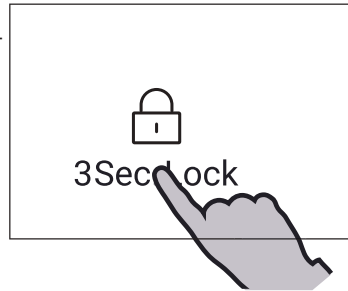

Standby-mode

The display screen turns off automatically 30 seconds after pressing a key. The display will be automatically locked. It lights up automatically when pressing any key or opening any door (Alarm does not light up the display screen)

Manual adjusting mode

If you want to manually adjust the temperature of the appliance, you can set the temperature via a temperature adjust button (refer to ADJUST THE TEMPERATURE)

Adjust the temperature

The indoor temperatures are influenced by the following factors:

- ▶ Ambient temperature
- ▶ Frequency of door opening
- ▶ Amount of stored foods
- ▶ Installation of the appliance

Door alarm

Door alarm will trigger when door opens for long time or not closed properly, as a reminder.

Adjust the temperature for fridge

1. When the display screen is unlocked, press the button "K" (Zone selector). The buzzer rings once, the indicator "j1" (Fridge indicator) flashes, and then here comes the temperature setting mode of the fridge.
2. Press the button "I" (Temperature adjustment button "-") every time, the buzzer rings once, the set temperature of the fridge will be reduced by 1. The fridge temperature will display in the sequence of "9°C ->8°C->7°C->6°C ->5°C -> 4°C->3°C ->2°C ->1°C".

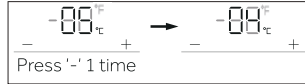

3. Press the button "J" (Temperature adjustment button "+") every time, the buzzer rings once, the set temperature of the fridge will be increased by 1. The fridge temperature will display in the sequence of "1°C ->2°C->3°C ->4°C ->5°C->6°C ->7°C ->8°C ->9°C".

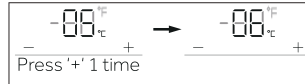

Notice

After setting the temperature, if there is no operation within 5 seconds, the system will be automatically determined and save the set temperature.

Adjust the temperature for freezer

1. When the display screen is unlocked, press the button "K" (Zone selector). The buzzer rings once, the indicator "j2" (Freezer indicator) flashes, and then here comes the temperature setting mode of the freezer.
2. Press the button "I" (Temperature adjustment button "-") every time, the buzzer rings once, the set temperature of the freezer will be reduced by 1. The freezer temperature will display in the sequence of "-14°C ->-15°C ->-16°C ->-17°C ->-18°C->-19°C->-20°C ->-21°C ->-22°C ->-23°C ->-24°C".

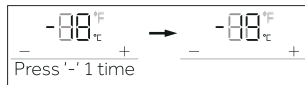

3. Press the button "J" (Temperature adjustment button "+") every time, the buzzer rings once, the set temperature of the freezer will be increased by 1. The freezer temperature will display in the sequence of "-24°C ->-23°C ->-22°C ->-21°C ->-20°C ->-19°C ->-18°C ->-17°C ->-16°C ->-15°C ->-14°C".

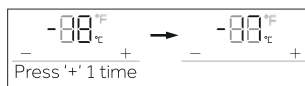

Notice

After setting the temperature, if there is no operation within 5 seconds, the system will be automatically determined and save the set temperature.

Adjust the temperature for Switch Zone (S-Zone)

When the display screen is unlocked, press the button "K" (Zone selector). The buzzer rings once, the indicator "j3" (S-Zone indicator) flashes, and then here comes the temperature setting mode of the S-zone.

1. Press the button "I" (Temperature adjustment button "-") every time, the buzzer rings once, the set temperature of the S-zone will be reduced by 1. The S-zone temperature will display in the sequence of "5°C ->4°C ->3°C->2°C ->1°C ->0°C->-1°C ->-2°C->-3°C->-4°C ->-5°C ->-6°C ->-7°C->-8°C ->-9°C ->-10°C ->-11°C ->-12°C->-13°C ->-14°C ->-15°C ->-16°C ->-17°C->-18°C".

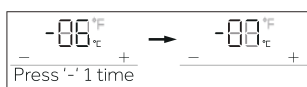

2. Press the button "J" (Temperature adjustment button "+") every time, the buzzer rings once, the set temperature of the S-zone will be increased by 1. The S-zone temperature will display in the sequence of "-18°C ->-17°C ->-16°C ->-15°C->-14°C ->-13°C ->-12°C ->-11°C ->-10°C->-9°C->-8°C ->-7°C ->-6°C ->-5°C->-4°C->-3°C ->-2°C ->-1°C ->0°C->1°C ->2°C ->3°C ->4°C ->5°C".

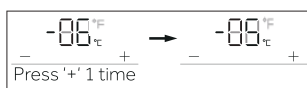

Notice

After setting the temperature, if there is no operation within 5 seconds, the system will be automatically determined and save the set temperature.

Super-Cool function

1. When the display screen is unlocked, press the button "H" (Super-Cool selector), the buzzer rings once, the indicator "h" (Super-Cool function) illuminates, and then the Super-Cool function will be turned on.
2. When the indicator "h" (Super-Cool function) illuminates, press the button "H" (Super-Cool selector), the buzzer rings once, the indicator "h" (Super-Cool function) goes off, and then the Super-Cool function will be turned off.
3. After the Super-Cool function is turned on, the refrigerator will automatically turn off the function when it reaches the set condition. If you want to exit manually, you can press the button "H" (Super-Cool selector) to turn it off.



Notice

Under Super-cool state, the fridge temperature cannot be adjusted. If either button "I" (Temperature adjustment button "-") or button "J" (Temperature adjustment button "+") is pressed to adjust the temperature of fridge, the indicator "j1" (Fridge indicator) will flash with a prompt sound to indicate that this operation cannot be carried out.

Super-Freeze function (Super-Frz)

1. When the display screen is unlocked, press the button "G" (Super-Freeze selector), the buzzer rings once, the indicator "g" (Super-Freeze function) illuminates, and then the Super-Freeze function will be turned on.
2. When the indicator "g" (Super-Freeze function) illuminates, press the button "G" (Super-Freeze selector), the buzzer rings once, the indicator "g" (Super-Freeze function) goes off, and then the Super-Freeze function will be turned off.
3. After the Super-Freeze function is turned on, the refrigerator will automatically turn off the function when it reaches the set condition. If you want to exit manually, you can press the button "G" (Super-Freeze selector) to turn it off.



Notice

Under Super-Freeze state, the freezer temperature cannot be adjusted. If either button "I" (Temperature adjustment button "-") or button "J" (Temperature adjustment button "+") is pressed to adjust the temperature of freezer, the indicator "j2" (Freezer indicator) will flash with a prompt sound to indicate that this operation cannot be carried out.

Super-Freeze function is designed to keep nutrition value of frozen food, it will be freeze food in the shortest time. If large quantities of frozen food are to be frozen at one time, it is recommended that users take food that cannot be frozen out from the S-zone, turn the S-Zone temperature below -18°C, to use it as a freezer. Meanwhile, Super-Freeze function should be set 24h in advance, to make the freezer and S-zone own relatively low temperature and put food in. At this time, the freezing speed of the freezer and S-zone is improved, food can be frozen quickly, the nutrition of food is effectively kept, and the storage becomes quite convenient.

Holiday mode

Holiday mode is designed for not using the fridge for a long time. When the Holiday mode is turned on, the freezer is under normal control, and the temperature of fridge is automatically set to be 17°C. The actual temperature is not higher than 17°C, which prevents peculiar smell caused by overtemperature, and helps reduce energy consumption at the same time.

1. When the display screen is unlocked, press the button "F" (Holiday mode selector), the buzzer rings once, the indicator "f" (Holiday mode) illuminates, and then the Holiday function will be turned on.
2. When the indicator "f" (Holiday mode) illuminates, press the button "F" (Holiday mode selector), the buzzer rings once, the indicator "f" (Holiday mode) goes off, and then the Holiday function will be turned off.

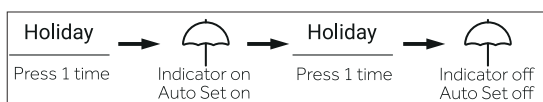

3. Under unlocked state, hold the button "F" (Holiday mode selector) for 3 seconds, the buzzer rings once, then the projection lamp will be turned off. The projection lamp function can likewise be turned with same operation.



Notice

Under Holiday state, the fridge temperature cannot be adjusted. If either button "I" (Temperature adjustment button "-") or button "J" (Temperature adjustment button "+") is pressed to adjust the temperature of fridge, the indicator "j1" (Fridge indicator) will flash with a prompt sound to indicate that this operation cannot be carried out.

Before using the Holiday function, please empty the fridge to prevent food goes bad in it. When the Holiday function is turned on, "Super-Cool" function cannot be turned on at the same time.

Filter reset function (Only for HRF680YPS/HRF680YPC)

When the refrigerator operates for six months, the reminder indicator "d" (Filter Reset function) will light up to remind users to replace with a new filter. When filter is replaced, hold the button "D" (Filter Reset function selector) for 3 seconds to cancel the reminder, the timing will reset with buzzer ringing.



Notice

To replace the water filter, lift open the water filter cover lid, turn the filter counter clockwise for quarter of a turn to remove the used filter, replace with new filter. Make sure the filter is properly fitted with correct orientation.

The normal service life of filter is six months. It is recommended to replace the filter every six months.

Use

Ice maker mode (Only for HRF680YPS/HRF680YPC)

1. Under unlocked state, press the button "E" (Ice maker mode selector), the buzzer rings once, the indicator "e" (Ice maker mode) illuminates, and then the ice maker mode will be turned on.
2. When the indicator "e" (Ice maker mode) illuminates, press the button "E" (Ice maker mode selector), the buzzer rings once, the indicator "e" (Ice maker mode) goes off, and then the ice maker mode will be turned off.

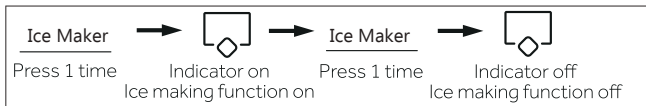

Notice

The ice maker is off by default when the refrigerator is powered on for the first time. The ice maker is designed to automatically dispense ice into the ice storage bin and it will stop when it detects the bin is full. The more ice you use, the more ice it makes.

Water Lock function (Only for HRF680YPS/HRF680YPC)

In unlock state, press key "C" (Water Lock selector), after hearing one beeping sound, the indicator "c" (Water lock function) lights up, Water lock function is enabled, water will not come out from the dispenser when you push the pedal. Press the key "C" (Water Lock selector) again, the indicator "c" (Water lock function) goes off, Water lock function is disabled, water will come out from the dispenser when you push the pedal.



Notice

Note: If the fridge compartment door is open, water will not dispense when pedal is pressed, even when the Water lock function is enabled.

Bottle chill function (Only for HRF680YS)

Bottle Chill rapidly chills your beverages in the freezer for a set time of 15 minutes. Depending on bottle size, you may need to return it to the freezer and reset. In unlock state, press key "L" (Bottle Chill selector), after hearing one beeping sound, the indicator "I" (Bottle Chill function) lights up, Bottle chill function is enabled. An alarm will sound after 15 minutes to remind you to remove your beverage. Press the key "L" (Bottle Chill selector) again, the indicator "I" (Bottle Chill function) goes off, Bottle chill function is disabled.



Notice

Open the fresh food compartment door and press any button on the control panel to silence the alarm.

Wi-Fi function

Your appliance can be connected to your home wireless network and operated remotely using the app.

Under the display screen is unlocked, press the button "B" (WI-FI selector), the buzzer rings once, the indicator "b" (WI-FI function) illuminates and flashes, and then here comes to the WI-FI function. When the indicator "b" (WI-FI function) illuminates, press the button "B" (WI-FI selector) for 3 seconds, the buzzer rings once, the indicator "b" (WI-FI function) goes off, and then the WI-FI function turns off.

Getting started

- Ensure your home WiFi network is turned on.
- You will be given step by step guidance on your mobile device.
- It may take up to 10 minutes to connect your appliance.

On your mobile device:

- ① Download the app from www.fisherpaykel.com/connect
- ② Register and create an account.
- ③ Add your appliance and set up the WiFi connection.

Replacing the water filter

1. Uplift the water filter cover.
2. Remove the disposable water filter.
3. Replace with a new water filter. Insert the new filter into the filter head and rotate it clockwise until the arrow on the new filter lines up with the arrow on the filter head. Swing the filter back into the compartment.
4. Close the water filter cover.

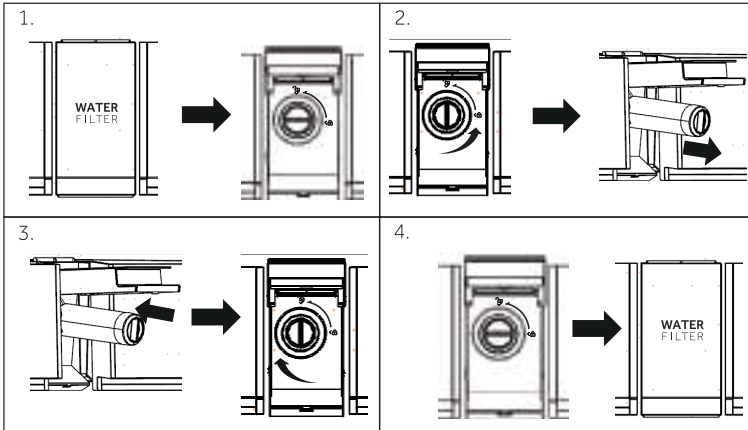

5. Press and hold the **3Sec.Filter Reset** button for 3 seconds.
6. Dispense water for approximately 5 minutes to remove trapped air and contaminants.



CAUTION!

- ▶ Failure to replace filters when required or using non Haier authorised water filters can cause the filter cartridge to leak and result in property damage.

Water Filter

Model: Haier HRXWF

- ▶ System certified by IAPMO R&T against NSF/ANSI Standards 42, 53, 401 and P473 for the reduction of claims specified on the performance data sheet and at iapmo.org.
- ▶ Actual performance may vary with local water conditions.

Application Guidelines/Water Supply Parameters

Service Flow: 0.5 gpm (1.89 lpm)

Water Supply: Potable Water

Water Pressure: 25-120 psi (172-827 kPa)

Water Temperature: 33°F-100°F (0.6°C-38°C)

Capacity: 170 gallons (643.5 liter)

Tips on storing fresh food

Storing into the refrigerator compartment

- ▶ Keep your fridge temperature below 5°C.
- ▶ Hot food must be cooled to room temperature before storing in the appliance.
- ▶ Foods stored in the refrigerator should be washed and dried before storing
- ▶ Food to be stored should be properly sealed to avoid odour or taste alterations.
- ▶ Do not store excessive quantities of food. Leave spaces between foods to allow cold air flowing around them, for a better and more homogeneous cooling.
- ▶ Foods eaten daily should be stored at the front of the shelf.
- ▶ Leave a gap between foods and the inner walls, allowing air flowing. In special way don't store foods against the rear wall: foods could freeze against rear wall. Avoid direct contact of food (especially oily or acidic food) with the inner liner, as oil/acid can erode the inner liner. Clean away oily/acid dirt whenever it is found.
- ▶ Defreeze frozen food in the fridge storage compartment. This way, you can use the frozen food to decrease the temperature in the compartment and save energy.
- ▶ The ageing process of fruit and vegetables such as courgettes, melons, papaya, banana, pineapple, etc. can be accelerated in the refrigerator. Therefore, it is not advisable to store them in the refrigerator. However, the ripening of strongly green fruits can be promoted for a certain period. Onions, garlic, ginger and other root vegetables should also be stored at room temperature.
- ▶ Unpleasant odours inside the fridge are a sign that something has spilled and cleaning is required. See CARE AND CLEANING.
- ▶ Different foods should be placed in different areas according to their properties:



Notice

Please keep the distance more than 10 mm between the food placed and air duct or sensors to ensure the cooling effect.

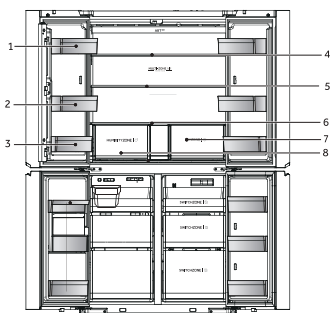

- 1 Butter, cheese, etc.
- 2 Eggs, cans, canned food, spices, etc.
- 3 Drinks and bottled foods.
- 4 Pickled foods, canned food, etc.
- 5 Meat products, snack foods, pasta, canned food, milk, tofu, dairy etc.
- 6 Cooked meat, sausages, etc.
- 7 Humidity zone drawer: Fruit, vegetables, salad, etc.
- 8 Humidity zone drawer: Fruit, vegetables, salad, etc.

Storage into the Switch Zone compartment

Switch Zone compartment allows you to adjust the temperature between -18°C to 5°C according to the demand of food storage and provide you with further flexibility in storage options for your convenience.

-18°C	For general frozen food items that require storage between 1 – 12 months .	Meat, poultry, seafood, pre-cooked foods and leftovers, some fruits and vegetable, ice cream, and other frozen desserts.
-7°C	Allows easy portioning of food and the ability to heat, cook or serve foods straight from the compartment without waiting for it to thaw.	Meats, seafood, soups, sauces, pureed foods, bread, desserts and pastries. Note: Recommended for storage of creamy desserts such as ice cream.
0°C	Providing the perfect storage zone for highly perishable food to ensure they retain their vital freshness and quality.	Highly perishable meats, poultry and seafood. Alcoholic beverages such as beer.
5°C	The ideal mode for fresh foods such as fruit and vegetables, dairy products, meats and drinks.	Fruit and vegetables, dairy products, jams and chutneys/preserves, meats and drinks.

Storage into the freezer compartment

- ▶ Keep the freezer temperature at -18°C.
- ▶ 24 hours before freezing switch on the Super-freeze function; -for small quantities of food 4-6 hours are sufficient.
- ▶ Hot food must be cooled to room temperature before storing in the freezer compartment.
- ▶ Food cut into small portions will freeze faster and be easier to defrost and cook. The recommended weight for each portion is less than 2.5 kg
- ▶ It is better to pack food before putting it into the freezer. The outside of the packaging must be dry to avoid bags sticking together. Packaging materials should be odour-free, airtight, non-poisonous and nontoxic.
- ▶ In order to avoid expiration of storage periods, please note the freezing date, time limit and name of the food on the packaging according to the storage periods of different foods.
- ▶ **WARNING!** Acid, alkali and salt etc. could erode the internal surface of the freezer. Do not place the food having these substances (e.g. sea fish) directly on the internal surface. Salt water in the freezer should be cleaned up immediately.
- ▶ Do not exceed the food storage times recommended by the manufacturers. Only take the required amount of food out of the freezer.
- ▶ Consume defrosted food quickly. Defrosted food cannot be re-frozen unless it is first cooked, otherwise it may be less edible.
- ▶ Do not load excessive quantities of fresh food in the freezer compartment. Refer to the freezing capacity of the freezer – See TECHNICAL DATA or data at the type plate.
- ▶ Food can be stored in the freezer at a temperature of at least -18°C for 2 to 12 months, depending on its properties (e.g., meat: 3-12 months, vegetables: 6-12 months)
- ▶ When freezing fresh food, avoid bringing it in contact with already frozen food. Risk of thawing!

When storing commercially frozen foods, please follow these guidelines:

- ▶ Always follow manufacturers' guidelines for the length of time you should store food for. Do not exceed these guidelines!
- ▶ Try to keep the length of time between purchase and storage as short as possible to preserve food quality.
- ▶ Buy frozen foods, which have been stored at a temperature of -18 °C or below.
- ▶ Avoid buying food which has ice or frost on the packaging – This indicates that the products might have been partially defrosted and refrozen at some point – temperature rises affect the quality of food.



Notice

- ▶ Please keep the distance more than 10 mm between the food placed and air duct to ensure the cooling effect.

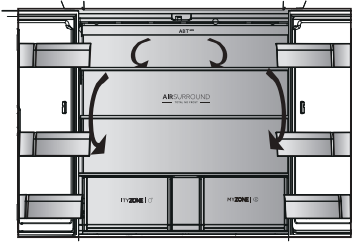

Multi-air-flow

The refrigerator is equipped with a multi-air-flow system, with which cool air flows are located on every shelf level. This helps to maintain a uniform temperature to ensure that your food is kept fresher for longer.

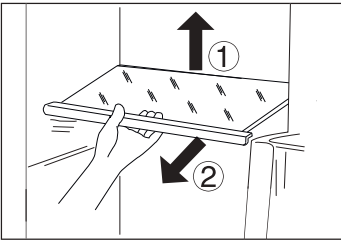

Adjustable shelves

The height of the shelves can be adjusted to fit your storage needs.

1. To relocate a shelf, remove it first by uplifting its hind edge (1) and pulling it out (2).
2. To reinstall it, put it on the lugs on both sides and push it to the most rearward position until the rear of the shelf is fixed inside the slots in the sides



Notice:

Ensure that all ends of a shelf are level.

Humidity zone drawer

In this compartment the humidity level is around 85%. It is controlled automatically by the system and is suitable to store fruits, vegetables, salads etc.



Notice:

- ▶ Do not remove the plastic cover inside the two zones. They maintain the humidity.
- ▶ Cold-sensitive fruits like pineapple, avocado, bananas, grapefruits and vegetables such as potatoes, aubergines, beans, cucumbers, zucchini and tomatoes and cheese should not be stored in these two drawers.

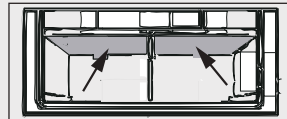

Removable door shelves

The door **shelves** can be removed for cleaning:

Place hands on each side of the **shelves**, lift it upwards (1) and pull it out (2).

In order to insert the door **shelves**, the above steps are carried out in reverse order.

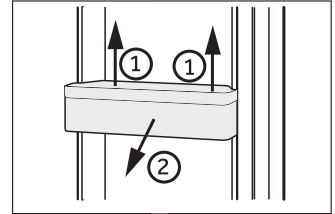

The Light

The LED interior light comes on when the door is opened and it will automatically go off if the door is left open for more than 7 minutes. The performance of the lights is not affected by any of the appliances other settings.

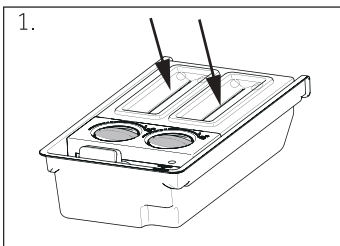

Ice cube make (Only for HRF680YS)

1. Pour fresh drinking water into each ice-making box as per the scale mark inside the measuring cup, do not exceed the scale mark



Notice:

Do not bring water between the 2 buttons, otherwise the buttons maybe frozen and the ice cubes cannot drop into the storage box.

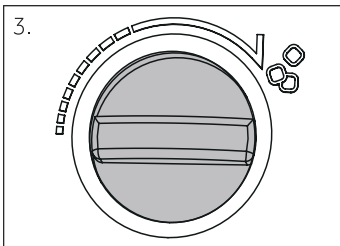

2. Put the box into the freezing compartment.
3. After water becomes ice, take off the ice maker out of the appliance and rotate the button by hand. Then, ice blocks will fall into the ice box automatically. Remove the cover and fetch the ice cubs.



Energy saving tips

- ▶ Make sure the appliance is properly ventilated (see INSTALLATION).
- ▶ Do not install the appliance in direct sunlight or in the near of heat sources (e.g. stoves, heaters).
- ▶ Avoid unnecessarily low temperature in the appliance. The energy consumption increases the lower the temperature in the appliance is set.
- ▶ Functions like Super- Freeze consume more energy.
- ▶ Allow warm food to cool down before placing it in the appliance.
- ▶ Open the appliance door as little and as briefly as possible.
- ▶ Do not overfill the appliance to avoid obstructing the air flow.
- ▶ Avoid air within the food packaging.
- ▶ Keep door seals clean so that the door always closes correctly.
- ▶ Defreeze frozen food in the fridge storage compartment.
- ▶ The most energy-saving configuration requires the appliance keep drawers, food box and shelves on factory-fresh condition, and food should be places as far as possible without blocking the air outlet of the duct.

Care and cleaning



WARNING!

Disconnect the appliance from the power supply before cleaning.

Cleaning

Clean the appliance when only little or no food is stored.

The appliance should be cleaned every four weeks for good maintenance and to prevent bad stored food odors.



WARNING!

- ▶ Do not clean the appliance with hard brushes, wire brushes, detergent powder, petrol, amyl acetate, acetone and similar organic solutions, acid or alkaline solutions. Please clean with special refrigerator detergent to avoid damage.
 - ▶ Do not spray or flush the appliance during cleaning.
 - ▶ Do not use water spray or steam to clean the appliance.
 - ▶ Do not clean the cold glass shelves with hot water. Sudden temperature change may cause the glass to break .
 - ▶ Do not touch the inside surface of the freezer storage compartment, especially with wet hands, as your hands may freeze onto the surface.
 - ▶ In case of heating check the condition of frozen goods.
-
- ▶ Always keep the door gasket clean.
 - ▶ Clean the inside and housing of the appliance with a sponge dampened in warm water and neutral detergent.
 - ▶ Rinse and dry with soft cloth.
 - ▶ Do not clean any of the parts of the appliance in a dishwasher.
 - ▶ Allow at least 5 minutes before restarting the appliance as frequent starting may damage the compressor.

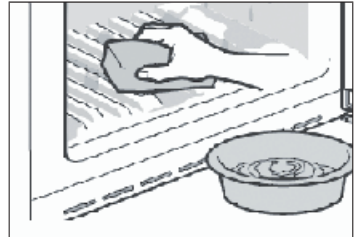

Defrosting

The defrosting of the refrigerator and the freezer compartment are done automatically; no manual operation is needed.

Replacing the LED light



WARNING!

Do not replace the LED light by yourself, it must only be replaced by either the manufacturer or the authorised service agent.

The light adopts LED as its light source, featuring low energy consumption and long service life. If there is any abnormality, please contact the customer service. See CUSTOMER SERVICE.

Parameters of the lamp:

Refrigerator compartment: 12 V max 5 W

Non-use for a longer period

If the appliance is not used for an extended period of time, and you will not use only the Holiday-function or the fridge off function for the refrigerator:

- ▶ Take out the food.
- ▶ Unplug the power cord.
- ▶ Clean the appliance as described above.
- ▶ Keep the doors open to prevent the creation of bad odours inside.

Cleaning the ice cube maker (Only for HRF680YS)

1. Take off the ice cube maker out of the appliance.
2. Remove cover (A) and (B).
3. Clean the ice cube maker with warm water and liquid dishwashing detergent. Make sure all soap is rinsed off.
4. Close the covers, refill with drinking water and replace the ice cube maker inside the appliance.

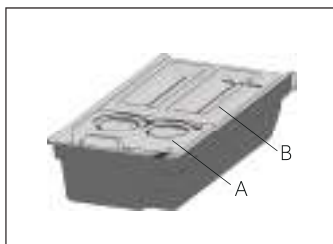

Care and cleaning

Cleaning the ice cube tray (Only for HRF680YPS/HRF680YPC)

- 1 Turn off the icemaker function via the display panel, hold down the handle of the icemaker, and use strength to pull out the icemaker.
- 2 Remove the icemaker assembly from the refrigerator and turn over the icemaker, so that the ice cube tray is visible.
- 3 Pull the oval shaped fastener on the ice tray in the direction of arrow 1. Tilt the ice tray upward and pull it out in the direction of arrow 2.

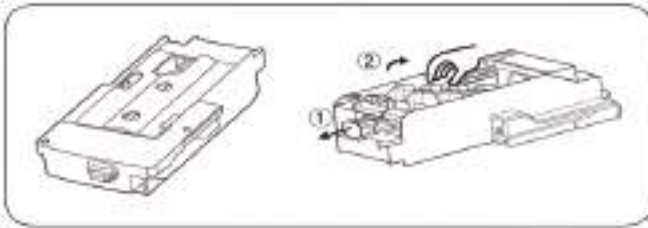

4. After cleaning the tray, put it back in, then firmly push in the icemaker, close the freezer drawer, and switch on the icemaker function via the display panel.

Icemaker usage precautions

For newly installed appliance, you should wait for 24 hours. This will enable the freezer compartment to cool down, so that it can make ice.

- The ice machine will make 8 ice cubes each time; but the specific ice-making quantity will depend on the indoor temperature, frequency that the doors are opened, water pressure, freezer compartment temperature, etc.
- In order to ensure that the ice tray gets filled up with ice cubes, the ice tray should be frequently pulled out so that the ice cubes get evenly distributed.
- It is a normal phenomenon that some of the ice cubes will clump together during removing.
- When the freezer compartment reaches or is below -8°C , the icemaker will start making ice (if you are just beginning to use the icemaker, or it has not been used to make ice in a long time, you should discard the first several ice cubes, so that impurities in the water line get run out.)
- The icemaker must be installed in the refrigerator through an authorized service agency.
- NEVER expose the water pipe to temperatures below 0°C to avoid freezing.
- Test the tubing for leaks by flushing the tube through with water, until the water runs clear.
- After the appliance has been sited into the location of your choice, make sure that the water tube is arranged so it does not incur damage through bends and kinks and is clear of any heat sources.
- Once the temperature inside the freezer is at -8°C ice production will begin.
- DO NOT touch the ice cube outlet with your hands, or any implements to avoid injury or damage.

- The icemaker can only be supplied with water via the container on top of the left door unit. It can not be connected directly to an external drinking water supply.
- DO NOT manually add water - this is an automatic water system. If the ice maker is turned on but the appliance is not connected to water, the ice maker will not work.

If you occasionally hear unusual sounds in the refrigerator

You may occasionally hear some "crunching" sounds, but these are just normal sounds that are emitted during ice making, so do not worry.

If you do not often use ice cubes

"Old" ice cubes will become cloudy, and will not taste fresh; therefore, please periodically clean the ice cube tray and wash it out with warm water. Before replacing the ice cube tray, be sure to cool it down, otherwise, ice will stick to other parts of the ice machine and affect the ice making function.

If the icemaker in the freezer compartment is not used for a long time

If not used for a long time, please remove the automatic icemaker and any residual ice cubes in the ice storage compartment, wash the ice cube tray and the ice storage compartment with warm water, wipe them dry with a clean towel and put them somewhere else in order to increase storage space.

The water reservoir should be removed, any residual water should be drained out.

How the Icemaker Works

The ice making capacity is 0.8kg/24 hours(this figure is the test result in lab under the 32°C ambient temperature condition). During the daily use of the appliance, due to the different ambient temperature and water pressure, the ice making capacity may differ a little.

Do not store ice cubes, which are produced during the first batch of cubes following appliance start up, or after a prolonged break. Discard these cubes.

To allow the ice cube tray to fill to maximum capacity, you will need to manually arrange the ice cubes periodically.

Some ice cubes may stick together when dropped into the storage box - you will need to separate these to allow maximum use of the icebox.

Throw out the first few batches of ice cubes if you are making ice for the first time or have not made it for a long time.

If the cubed ice becomes smaller, this may suggest that the filter is blocked from the impurities

Troubleshooting

Many occurring problems could be solved by yourself without specific expertise. In case of a problem please check all shown possibilities and follow below instructions before you contact an after sales service. See CUSTOMER SERVICE.



WARNING!

- ▶ Before maintenance, deactivate the appliance and disconnect the mains plug from the mains socket.
- ▶ Electrical equipment should be serviced only by qualified electrical experts, because improper repairs can cause considerable consequential damages.
- ▶ A damaged supply should only be replaced by the manufacturer, its service agent or similarly qualified persons in order to avoid a hazard.

Problem	Possible Cause	Possible Solution
The compressor does not work.	<ul style="list-style-type: none"> • Mains plug is not connected in the mains socket. • The appliance is in the defrosting cycle 	<ul style="list-style-type: none"> • Connect the mains plug. • This is normal for an automatic defrosting
The appliance runs frequently or runs for a too long period of time.	<ul style="list-style-type: none"> • The indoor or outdoor temperature is too high. • The appliance has been off power for a period of time. • A door/drawer of the appliance is not tightly closed. • The door/drawer has been opened too frequently or for too long. • The temperature setting for the freezer compartment is too low. • The door/drawer gasket is dirty, worn, cracked or mismatched. • The required air circulation is not guaranteed. 	<ul style="list-style-type: none"> • In this case, it is normal for the appliance to run longer. • Normally, it takes 8 to 12 hours for the appliance to cool down completely. • Close the door/drawer and ensure the appliance is located on a level ground and there is no food or container jarring the door. • Do not open the door/drawer too frequently. • Set the temperature higher until a satisfactory refrigerator temperature is obtained. It takes 24 hours for the refrigerator temperature to become stable. • Clean the door/drawer gasket or replace them by the customer service. • Ensure adequate ventilation.
The inside of the refrigerator is dirty and/ or smells.	<ul style="list-style-type: none"> • The inside of the refrigerator needs cleaning. • Food of strong odour is stored in the refrigerator. 	<ul style="list-style-type: none"> • Clean the inside of the refrigerator. • Wrap the food thoroughly..

Troubleshooting

Problem	Possible Cause	Possible Solution
It is not cold enough inside the appliance.	<ul style="list-style-type: none"> The temperature is set too high. Too warm goods has been stored. Too much food has been stored at one time. The goods are too close to each other. A door/drawer of the appliance is not tightly closed. The door/drawer has been opened too frequently or for too long. 	<ul style="list-style-type: none"> Reset the temperature. Always cool down goods before storing them. Always store small quantities of food. Leave a gap between several foods allowing air flowing. Close the door/drawer. Do not open the door/drawer too frequently.
It is too cold inside the appliance.	<ul style="list-style-type: none"> The temperature is set too low. The Power- freeze function is activated or is running too long. 	<ul style="list-style-type: none"> Reset the temperature. Switch off the Power- freeze function
Moisture formation on the inside of the refrigerator compartment.	<ul style="list-style-type: none"> The climate is too warm and too-damp. A door/drawer of the appliance is not tightly closed. The door/drawer has been opened too frequently or for too long. Food containers or liquids are left open. 	<ul style="list-style-type: none"> Increase the temperature. Close the door/drawer. Do not open the door/drawer too frequently. Let hot foods cool to room temperature and cover foods and liquids.
Moisture accumulates on the refrigerators outside surface or between the doors/door and drawer.	<ul style="list-style-type: none"> The climate is too warm and too damp. The door/drawer is not closed tightly. The cold air in the appliance and the warm air outside it condensates. 	<ul style="list-style-type: none"> This is normal in damp climate and will change when the humidity decreases. Ensure that the door/drawer is tightly shut.
Strong ice and frost in the freezer compartment.	<ul style="list-style-type: none"> The goods were not adequately packaged. A door/drawer of the appliance is not tightly closed. The door/drawer has been opened too frequently or for too long. The door/drawer gasket is dirty, worn, cracked or mismatched. Something on the inside prevents the door/drawer to close properly. 	<ul style="list-style-type: none"> Always pack the goods well. Close the door/drawer. Do not open the door/drawer too frequently. Clean the door/drawer gasket or replace them by new ones. Reposition the shelves, door racks, or internal containers to allow the door/drawer to close.
The sides of the cabinet and door strip get warm.	<ul style="list-style-type: none"> - 	<ul style="list-style-type: none"> This is normal.

Troubleshooting

Problem	Possible Cause	Possible Solution
The appliance makes abnormal sounds.	<ul style="list-style-type: none">• The appliance is not located on level ground.• The appliance touches some object around it.	<ul style="list-style-type: none">• Adjust the feet to level the appliance.• Remove objects around the appliance.
A slight sound is to be heard similar to that of flowing water.	<ul style="list-style-type: none">• -	<ul style="list-style-type: none">• This is normal.
You will hear an alarm beep.	<ul style="list-style-type: none">• The fridge storage compartment door is open.	<ul style="list-style-type: none">• Close the door or silence the alarm manually.
You will hear a faint hum.	<ul style="list-style-type: none">• The anti-condensation system is working	<ul style="list-style-type: none">• This prevents condensation and is normal
The interior lighting or cooling system does not work.	<ul style="list-style-type: none">• Mains plug is not connected in the mains socket.• The power supply is not intact. • The LED-lamp is out of order.	<ul style="list-style-type: none">• Connect the mains plug. • Check the electrical supply to the room. Call the local electricity company!• Please call the service for changing the lamp.

Power interruption

In the event of a power cut, food should remain safely cold for about 12 hours. Follow these tips during a prolonged power interruption, especially in summer:

- ▶ Open the door/drawer as few times as possible.
- ▶ Do not put additional food into the appliance during a power interruption.
- ▶ If prior notice of a power interruption is given and the interruption duration is longer than 12 hours, make some ice and put it in a container in the top of the refrigerator compartment.
- ▶ An inspection of the goods is required immediately after the interruption.
- ▶ As temperature in the refrigerator will rise during a power interruption or other failure, the storage period and edible quality of food will be reduced. Any food that defrosts should be either consumed, or cooked and refrozen (where suitable) soon afterwards in order to prevent health risks.

Memory function during power interruption

After restoration of power the appliance continues with the settings that were set before the power failure.

Installation

Unpacking



WARNING!

- ▶ The appliance is heavy. Always handle with at least two persons.
- ▶ Keep all packaging materials out of children's reach and dispose them in an environmentally friendly manner.
- ▶ Take the appliance out of the packaging.
- ▶ Remove all packaging materials.

Environmental conditions

The room temperature should always be between 16° C and 38° C, since it can influence the temperature inside the appliance and its energy consumption. Do not install the appliance near other heat-emitting appliances (ovens, refrigerators) without isolation.

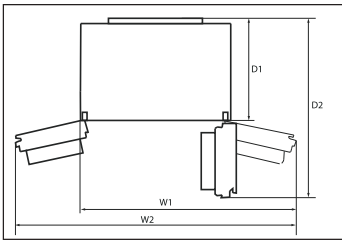

Space requirement

Required space when door is opened:

W1=1217mm

W2=1528mm

D1=629mm

D2=1110mm

**Notice: Dimensions above are for reference only.
Please make the object as the standard.**

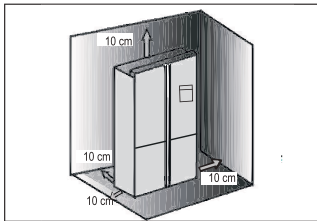

Ventilation cross-section

To achieve sufficient ventilation of the appliance for safety reasons, the information of the required ventilation cross sections must be observed.

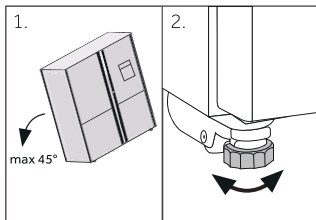

Aligning the appliance

The appliance should be placed on a flat and solid surface.

1. Tilt the appliance slightly backwards.
2. Set the feet to the desired level.

Make sure the distance to the wall on the hinge side is at least 10 mm for the door to open properly.

3. The stability can be checked by alternately bumping on the diagonals. The slightly swaying should be the same in both directions. Otherwise the frame can warp; possible leaking door seals are the result. A low tendency to the rear facilitates the closing of the door.

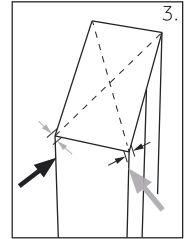

Fine tuning of the doors

If the doors are not in one level, this mismatch can be remedied by following:

Using adjustable foot

Rotate the adjustable foot according to the direction of arrow to turn up or down the foot.

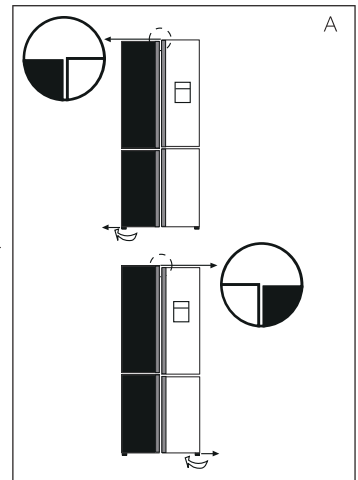

Notice

In the future use of refrigerator, doors uneven phenomenon may occur to the weight of stored food. Then please adjust according to the above methods.

Installation

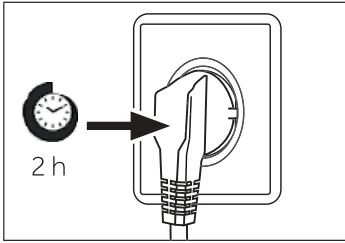

Waiting time

To the maintenance-free lubrication oil is located in the capsule of the compressor. This oil can get through the closed pipe system during slanting transport. Before connecting the appliance to the power supply you have to wait 2-5 hours so that the oil runs back into the capsule.

Electrical connection

Before each connection check if:

- ▶ power supply, socket and fusing are appropriate to the rating plate.
- ▶ the power socket is earthed and no multi-plug or extension.
- ▶ the power plug and socket are strictly according.

Connect the plug to a properly installed household socket.



WARNING!

To avoid risks a damaged power cord must be replaced by the customer service (see warranty card).

Ice and Water

Your Ice and Water and Automatic ice refrigerator must be installed by a qualified plumber or Haier trained and supported service technician as incorrect plumbing can lead to water leaks.

Haier appliances does not accept responsibility for damage (including water damage) caused by faulty installation or plumbing.

(Only for HRF680YPS/HRF680YPC)



WARNING!

- ▶ Only connect to drinking water supply. The water filter only filters impurities in the water and makes ice clean and hygienic. It cannot sterilize or destroy germs or other harmful substances.
- ▶ Too high water pressure in the hose can damage the appliance. Install a pressure reducer when the water pressure in the hose exceeds 0.6 MPa.
- ▶ Before connection, check whether the water is clean and clear.



Notice: Water connection

- ▶ Pressure of the cold water has to be 0.15-0.6 MPa.
- ▶ The maximum permitted length of water hose is 8 metres. Longer hoses will affect the ice cubes and cold water content.
- ▶ Ambient temperature has to be 0°C minimum.
- ▶ Keep the water hose away from heat sources.

1. Connect the end of pipe (B2) to one of the adapters "D" suits to the water main.
2. Connect the end of B1 to the valve assembly at the back of appliance .
3. Open the water tap to check if the system is leak free and flush the pipe.

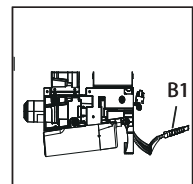
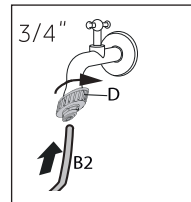

WARNING!

- ▶ Ensure always that the connections are firm, dry and leak free!
- ▶ Take care the hose never to be crushed, kinked, or twisted

Technical data

Trade mark	Haier
Model No.	HRF680YPC/ HRF680YPS/HRF680YS
Category of the model	Cooled Appliance
Voltage / Frequency	220V-240V~/50Hz
Energy Star	4.5 Stars
Frostfree system	Yes
Product group	5T
Total product volume	623L
Fresh food compartment volume	358L
Freezer compartment volume	130L
Convertible compartment volume	135L
Climate class	T
Refrigerant	R600a 75g
Insulation blowing gas	CYCLOPENTANE
Dimension (DxWxH)	750x908x1775mm
Protection class	I

2022 Version A

Haier



0060533903