





Refrigerator  
**SIDE-BY-SIDE SERIES**

# USER MANUAL

**MDRS925FIM45AP**



**SmartHome**



Download the app  
& activate product

Warning notices: Before using this product, please read this manual carefully and keep it for future reference. The design and specifications are subject to change without prior notice for product improvement. Consult with your dealer or manufacturer for details.

The diagram above is just for reference. Please take the appearance of the actual product as the standard.

## THANK YOU LETTER

Thank you for choosing Midea! Before using your new Midea product, please read this manual thoroughly to ensure that you know how to operate the features and functions that your new appliance offers in a safe way.

# CONTENTS

<b>SPECIFICATIONS</b> -----	05
<b>PRODUCT OVERVIEW</b> -----	06
<b>PRODUCT INSTALLATION</b> -----	07
<b>OPERATION INSTRUCTIONS</b> -----	11
<b>APP SETUP AND OPERATION</b> -----	15
<b>CLEANING AND MAINTENANCE</b> -----	16
<b>TROUBLESHOOTING</b> -----	18
<b>TRADEMARKS, COPYRIGHTS AND LEGAL STATEMENT</b> -	21
<b>DISPOSAL AND RECYCLING</b> -----	21
<b>DATA PROTECTION NOTICE</b> -----	21

EN

# LANGUAGES

**EN** English

# SPECIFICATIONS

Product model	MDRS925FIM45AP
Rated Voltage	220-240V-
Rated Current	2.2A
Fresh Food Storage Compartment Volume	433L
Frozen Food Storage Volume	267L
Refrigerant ,Amount	R290,62g
Dimensions	910x735x1775mm



Wireless network module	MWB-S-WB01
Standard	IEEE 802.11b/g/n
Antenna Type	Printed PCB antenna
Frequency Band	2400-2483,5 MHz
Operating Temperature	0 °C - 85 °C / 32 °F - 185 °F
Operation Humidity	10% - 85%
Maximum Transmission Power	<20 dBm
Power Input	DC 5V/500mA

EN

# PRODUCT OVERVIEW

## Parts Description

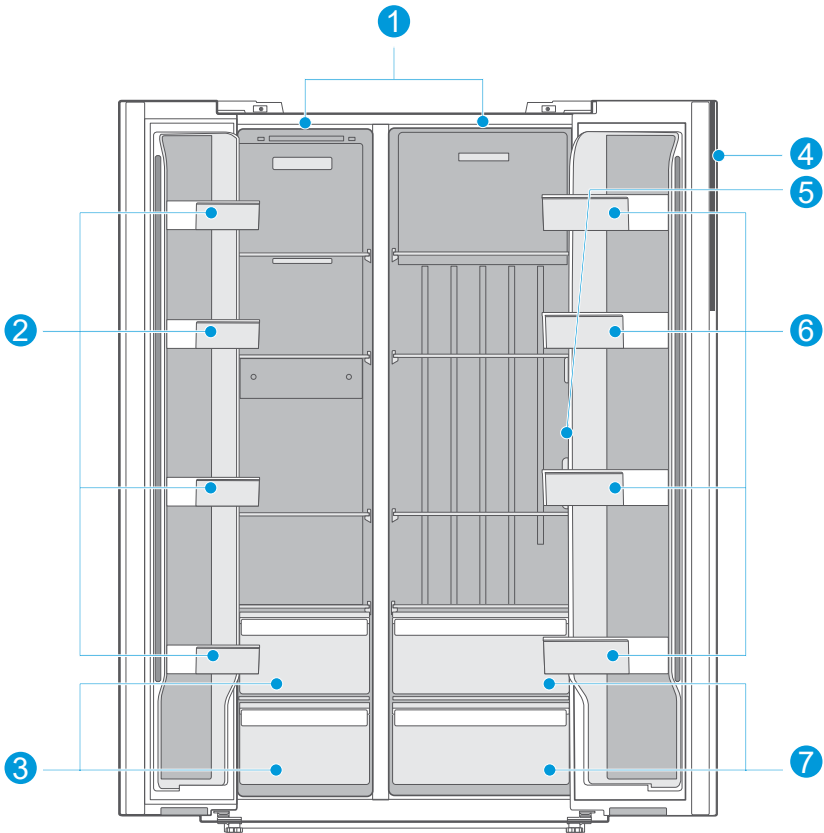

- |   |                  |   |                 |
|---|------------------|---|-----------------|
| 1 | LED Light        | 5 | Control Panel   |
| 2 | Freezer Door Bin | 6 | Fridge Door Bin |
| 3 | Freezer Drawer   | 7 | Crisper Drawer  |
| 4 | Induction Lamp   |   |                 |

### ATTENTION

The picture above is for reference only. The actual configuration will depend on the physical product or statement by the distributor.

# PRODUCT INSTALLATION

## Installation Instructions

### Refrigerator Location

- Your refrigerator is designed to be free standing, and is not to be recessed or built in.
- Place the refrigerator in a well-ventilated location where the floor is flat and sturdy.
- Keep the refrigerator away from direct sunlight.
- Avoid locations exposing your refrigerator to high humidity and moisture.

### Clearances

- Inadequate clearance from adjacent items may result in the degradation of freezing capability and increased electricity costs. Allow over 100 mm of clearance at both sides and the top, and 50-75 mm at the back when installing the appliance.

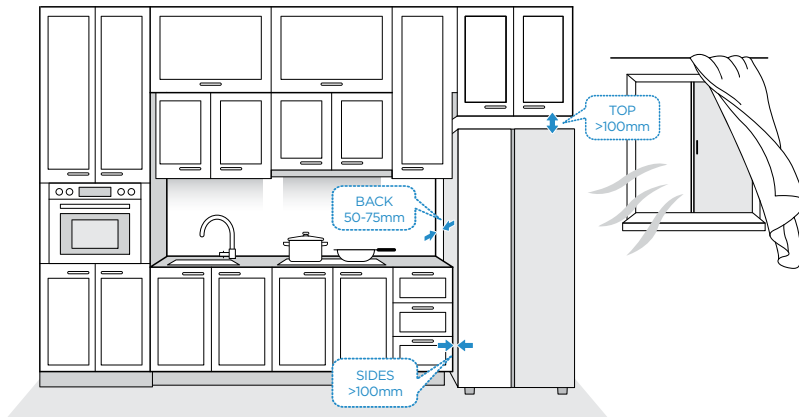

EN

### Connecting to Power

- A 240 V AC, 50 Hz electrical supply is required.
- The power cord is equipped with a 3-prong plug with grounding which mates with standard 3-prong wall outlet. The ground minimizes the possibility of electrical shock.

## CAUTION

The refrigerator should be plugged into a dedicated electrical circuit rated to match the requirements of the refrigerator, 240 V AC, 50 Hz

Never unplug the refrigerator by pulling on the power cord. Always grip the plug firmly and pull straight out from the outlet.

When positioning the refrigerator, ensure the power cord is not trapped or damaged.

Dimensions

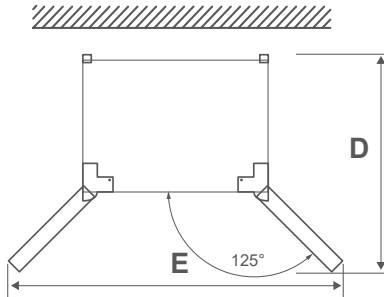
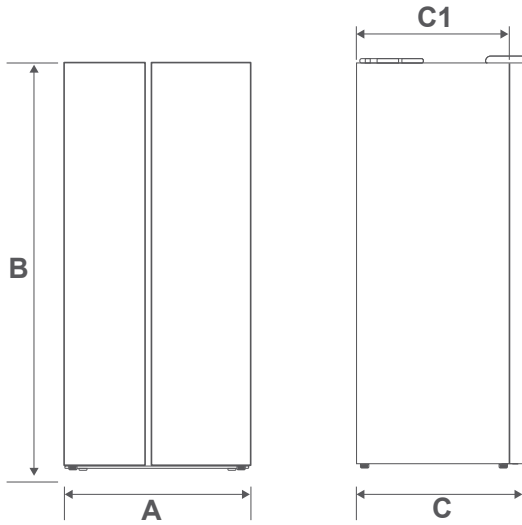

EN

Width	Overall Height	Depth	Depth (Only Cabinet)	Depth (doors open 125°)	Width (doors open 125°)
A	B	C	C1	D	E
910mm	1775mm	735mm	636mm	1127mm	1458mm

## Leveling Feet

To avoid vibration, the appliance must be leveled.

If required, adjust the leveling feet (located on both sides of the bottom front) to compensate for the uneven floor.

The front should be slightly higher than the rear to aid in door closing.

Leveling feet can be turned by tipping the cabinet slightly.

Turn the leveling feet counterclockwise ↺ to raise the unit, or clockwise ↻ to lower it.

## Aligning the Doors

If the upper edge of the door on the refrigerator is not aligned, place 1-2 shims between the lower hinge self-locking and the nut of the lower door to adjust the height.

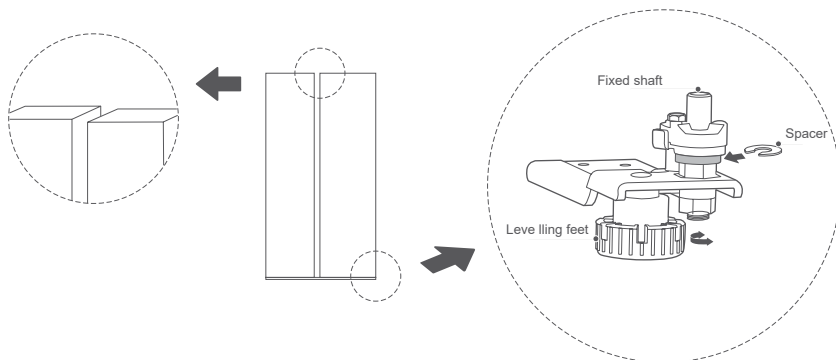

EN

## Moving the Appliance

1. Remove all items from inside the appliance.
2. Pull the power plug out, insert and fix it into the power plug hook at the rear or on top of the appliance.
3. Tape parts such as shelves and the door to prevent from falling off while moving the appliance.
4. Move the appliance with more than two people carefully. When transporting the appliance over a long distance, keep the appliance upright.
5. After installing the appliance, connect the power plug into a socket outlet to switch on the appliance.

## Connecting the Appliance

After installing the appliance, connect the power plug into a socket outlet.

### ATTENTION

After connecting the power supply cord (or plug) to the outlet, wait 2 or 3 hours before you put food into the appliance. If you add food before the appliance has cooled completely, your food may spoil.

Precautions before operation:

- Before making changes, the refrigerator must be disconnected from power.
- Precautions should be taken to prevent any personal injury.

## Tips for Energy Saving

- Do not place the appliance near cookers, radiators or other heat sources. If the ambient temperature is high, the compressor will run more frequently and for longer, resulting in increased energy consumption.
- Ensure that there is sufficient ventilation at the base of the appliance, on the sides of the appliance and at the back of the appliance. Never cover ventilation openings.
- Please also observe the spacing dimensions in the chapter "Installation".
- The arrangement of drawers, shelves and racks as shown in the illustration offers the most efficient use of energy and should therefore be retained as far as possible. All drawers and shelves should remain in the appliance to keep the temperature stable and save energy.
- To obtain a larger storage space (e.g. for large refrigerated/frozen goods), the middle drawers can be removed. The top and bottom drawers and shelves should be removed last if necessary.
- An evenly filled refrigerator/freezer compartment contributes to optimal energy use. Therefore, avoid empty or half-empty compartments.
- Allow warm food to cool before placing it in the refrigerator/freezer. Food that has already cooled down increases energy efficiency.
- Allow frozen food to defrost in the refrigerator. The coldness of the frozen food reduces the energy consumption in the refrigerator compartment and thus increases the energy efficiency.
- Open the door only as briefly as necessary to minimise cold loss. Opening the door briefly and closing it properly reduces energy consumption.
- The door seals of your appliance must be perfectly intact so that the doors close properly and energy consumption is not increased unnecessarily.

# OPERATION INSTRUCTIONS

## Control Panel

The control panel is located inside the refrigerator compartment.

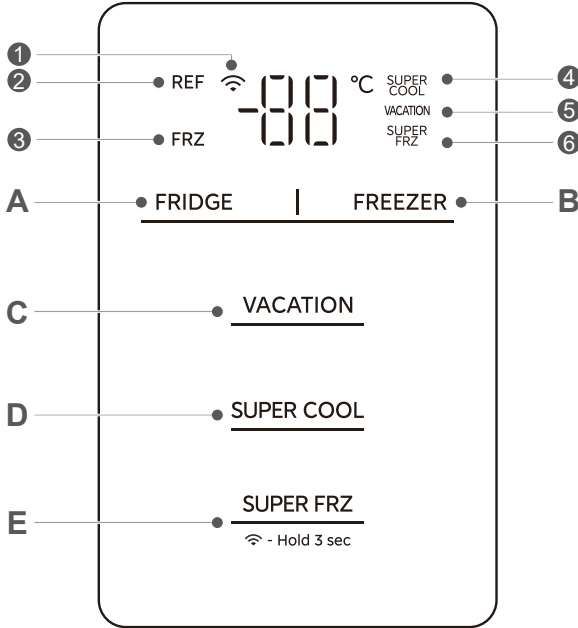

EN

Icons		Buttons	
1	Wireless network	A	Refrigerator temperature adjustment
2	Refrigerator	B	Freezer temperature adjustment
3	Freezer	C	Vacation mode
4	Super cool	D	Super cool
5	Vacation mode	E	Super freeze
6	Super freeze		

### ATTENTION

The actual control panel may vary depending on the model.

## Use and Functions

### Display

- When the refrigerator is electrified, the display screen is fully displayed for 3 seconds, meanwhile the start-up bell rings, then the display screen enters the normal display of operation. (When powered on for the first time, the temperature of the refrigerator compartment and freezer compartment is set to 5°C / -20°C by default).
- If there is a fault, the fault code is displayed. The refrigerating chamber's set temperature is displayed when there is no fault.
- If the door is closed and no button is pressed for 30 seconds, the screen will be locked. The display will be off after 30 seconds, and will be on again when any button is pressed. When there is a "fault code visible" type of fault, the display will light up, and will turn off after 30 seconds.

### Lock/Unlock

- The screen automatically enters the locked state after 10 seconds waiting.
- In the locked state, press any button to enter the unlocked state.

### Refrigerator temperature setting

- Press the **FRIDGE** button to adjust the temperature of refrigerator compartment. Each time you press the button, the temperature increases or decreases by 1°C.
- The setting range of the refrigerator compartment is 2 - 8°C.
- The setting takes effect after 10 seconds (screen locked).

### Freezer temperature setting

- Press the **FREEZER** button to adjust the temperature of freezer compartment. Each time you press the button, the temperature increases or decreases by 1°C.
- The setting range of the freezer compartment is -24 - -16°C.
- The setting takes effect after 10 seconds (screen locked).

### Super cool mode

- Press the **SUPER COOL** button to enter/exit the super cool mode. When super cool mode is set, the temperature of the refrigerator compartment is automatically set to 2°C, and the **SUPER COOL** icon is on.
- The super cool mode will be automatically exited after 6 hours. When exited, the temperature will return to that set before entering super cool mode.

### Super freeze mode

- Press the **SUPER FRZ** button to enter/exit the super freeze mode. When super freeze mode is set, the freezer compartment temperature is automatically set to -24°C, and the **SUPER FRZ** icon is on.
- The super freeze mode will be automatically exited after 40 hours. When exited, the temperature will return to that set before entering super freeze mode.

### ATTENTION

The super freeze function is designed to maintain the nutritional value of the food in the freezer. It can freeze the food in the shortest time. If a large amount of food is frozen at one time, it is recommended that the user turn on the super freeze function and put the food in. At this time, the freezing speed of the freezer compartment is increased, which can quickly freeze the food, effectively lock the nutrition of the food, and facilitate storage.

### Vacation mode

- Press the **VACATION** button to enter/exit the vacation mode. When the vacation mode is set, the freezing chamber is automatically set to -18°C and the refrigerating chamber is turned off.

- When the refrigerator enters the vacation mode, it will automatically exit the super cool and super freeze mode.

### Forced AP mode

- Press and hold SUPER FRZ for 4 seconds to force the refrigerator's wireless network module into AP mode ("AP" appears in the temperature display area). After the module enters AP mode and is successfully configured, it will automatically exit AP mode and the temperature display area will return to normal temperature display.
- After setting the AP mode, if the module is not successfully configured for 10 seconds, the AP mode will be forcibly exited, and the temperature display area will return to the normal temperature display.

### Turning off the door opening tone

- Press the FRIDGE and FREEZER buttons simultaneously for 3 seconds to turn the door opening tone on or off (the tone is turned off by default).
- If the door is left open for 2 minutes or longer, the door opening alarm will activate and sound intermittently until the door is closed. It will sound three beeps the first time, four beeps after 1 minute, five beeps after another minute, and so on. If left unattended, it will sound 30 beeps per minute.

### Sabbath Mode

- **Mode Entry/Exit:** Press and hold the SUPER FRZ button and the VACATION button simultaneously for 3 seconds to enter Sabbath Mode. Once activated, "On" will be displayed for 2 seconds, and the screen will automatically return to the normal interface. To exit Sabbath Mode, press and hold the SUPER FRZ button and the VACATION button simultaneously for 3 seconds again. Once deactivated, "OF" will be displayed for 2 seconds, and the screen will automatically return to the normal interface.
- If the refrigerator is connected to the internet, you can also enter or exit Sabbath Mode via the corresponding function button in the refrigerator control interface of the app.
- **Mode Operation:** After entering Sabbath Mode, the display will turn off 6 seconds after being locked, the buzzer will not sound, and the light will not turn on when the door is opened.
- When the refrigerator operates in Sabbath Mode for the preset duration (fixed at 48 hours when entered via buttons), it will automatically exit the mode.

### Fault indication

- When the following fault codes appear on the display screen, it indicates a problem with the refrigerator. Although the refrigerator in the following fault case can still provide cooling/freezing functions, the user should contact maintenance personnel to ensure the normal use of refrigerator.

Fault Code	Fault Description
E1	Refrigerator chamber temperature sensor fault
E2	Freezer chamber temperature sensor fault
E5	Freezer chamber defrosting sensor fault
E6	Communication fault
E7	Ambient temperature sensor fault
L3	Freezer fan fault
L4	Freezer fan speed is abnormal
L5	Condenser fan fault
L6	Condenser fan speed is abnormal

## Storing Food

### Freezer Compartment

- The freezer compartment is designated for the storage of food frozen at very low temperature, long-term storage of frozen food, and for the production of ice.
- Use the shelves in the door of the freezer only for storing frozen food, not for storing hot food intended for freezing.
- Do not put fresh and frozen food next to each other. The frozen food may thaw.
- When freezing fresh food (such as meat, fish or chopped meat), cut them into parts that can be used at the same time.
- Storing frozen food: instructions are usually stated on the packages, which must be followed. If there is no information on the packaging, food should not be stored for longer than three months from the date of purchase.
- When purchasing frozen food, make sure that it was frozen at a suitable temperature and that the packaging is not damaged.
- Frozen food should be kept in suitable packages to retain the quality and should be returned to the freezer compartment as soon as possible.
- If a package of frozen food shows moisture or abnormal bulging, it is probable that it was stored at the wrong temperature and the content is spoiled.
- The storage period for frozen food depends on the room temperature, the thermostat setting, the frequency of opening the door of the freezer, the type of food and the time of transporting the product from the shop to the household. Always follow the instructions printed on the packaging and never exceed the maximum storage time stated on the package.

### Refrigerator Compartment

To reduce moisture and subsequent ice build-up, never put liquid into the fridge compartment in unsealed containers. Frost tends to concentrate in the coolest parts of the evaporator. Storing uncovered liquids results in a more frequent need for defrosting.

Never put warm foods in the fridge compartment. These should first cool down at room temperature and then be placed so as to ensure adequate air circulation in the fridge compartment.

Foods or food containers should not touch the back wall of the fridge because they could freeze to the wall. Do not keep regularly opening the door of the refrigerator.

Meat and clean fish (packed in a package or plastic foil) can be placed in the fridge compartment, which can be used in 1-2 days.

Fruit and vegetables without packaging can be placed in the part designated for fresh fruit and vegetables

### Recommended Temperature

The optimal temperature setting for food storage:

- Fridge: 5°C; freezer: -20°C

#### ATTENTION

The optimal temperature setting of each compartment depends on the ambient temperature. Above optimal temperature is based on the ambient temperature of 25°C.

# APP SETUP AND OPERATION

## Download the SmartHome App

On an app market (Google Play Store, Apple App Store), search for “SmartHome” and find the SmartHome app. Download and install it on your phone. You can also download the app by scanning the QR code below.



## Register and log in

Open the SmartHome app, and create a new account to start (you can also register through a third-party account). If you already have an existing account, use the account to log in.



## Connect your devices to SmartHome

1. Please make sure your mobile phone is connected to a wireless network. If it is not, go to Settings and enable wireless networks and Bluetooth.
2. Please power on your devices.
3. Open SmartHome App on your phone.
4. If a message of “Smart devices discovered nearby” appears, click to add.
5. If no message appears, select “+” on the page and select your device in the list of nearby devices available. If your device is not listed, please add your device manually by the device category and device model.
6. Connect your device to the wireless network according to instructions on app. If the connection fails, please follow the instructions provided by the app to continue with the operation.



EN

# CLEANING AND MAINTENANCE

## CAUTION

Disconnect the appliance from the electrical supply before performing any routine maintenance. Allow at least 5 minutes before restarting the appliance, as frequent starting may damage the compressor.

Hold the plug, not the cable, when unplugging the appliance.

Do not scrape off frost and ice with sharp objects. Do not use sprays, electric heaters, hair dryers, steam cleaners or other sources of heat in order to avoid damage to the plastic parts.

Eliminate the dust on the back of the unit at least once in the year to avoid hazard by fire, as well as increased energy consumption.

Check the door gasket regularly to make sure there is no debris. Clean the door gasket with a soft cloth dampened with soapy water or diluted detergent.

The interior of the product should be cleaned regularly to avoid odor.

Use a soft cloth or sponge to clean the inside of the product, with two tablespoons of baking soda and a quart of warm water. Then rinse with water and wipe clean. After cleaning, open the door and let it dry naturally before turning on the power.

For areas that are difficult to clean in the product (such as narrow gaps or corners), it is recommended to wipe them regularly with a soft rag, soft brush, etc. and when necessary, combined with some auxiliary tools (such as thin sticks) to ensure no contaminants or bacteria accumulation in these areas.

Do not use soap, detergent, scrub powder, spray cleaner, etc., as these may cause odors in the interior of the product or contaminated food.

Wipe the outer surface of the product with a soft cloth dampened with soapy water, detergent, etc., and then wipe dry.

Do not use hard brushes, clean steel balls, wire brushes, abrasives (such as toothpastes), organic solvents (such as alcohol, acetone, isoamyl acetate, etc.), boiling water, acid or alkaline items, which may damage the fridge surface and interior. Boiling water and organic solvents such as benzene may deform or damage plastic parts.



Do not rinse directly with water or other liquids during cleaning to avoid short circuits or affect electrical insulation after immersion.

## ATTENTION

The appliance shall run continuously once it is started. Generally, the operation of the appliance shall not be interrupted; otherwise the service life may be impaired.

## Defrosting

The refrigerator is made based on the air-cooling principle and thus has an automatic defrosting function. Frost formed due to change of season or temperature may also be manually removed by disconnecting the appliance from power supply or by wiping with a dry towel.

## CAUTION!

Don't use sharp objects to remove frost from the freezer.

Only after the interior completely dry should the appliance be switched back on and plugged back into the mains socket.

## Cleaning the Door Bin

- > According to the direction arrow in the figure, use both hands to squeeze the bin and push it upward, then you can remove it.
- > After washing the removed bin, you can adjust its installation height to suit your needs.

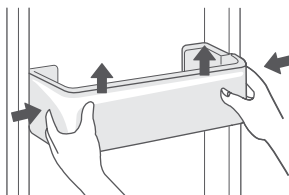

## Cleaning the Glass Shelf

- > As the innermost part of the refrigerator liner where contacting the shelves has a backstop, you shall raise the shelves upward, rotate the shelf as indicated, then you can take it out.
- > Adjust or clean the shelves as needed.

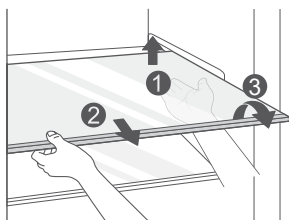

## Cleaning the Drawers

- > Remove the contents of the drawer. Hold the handle of the drawer and pull the drawer out completely until it stops.
- > Lift up the drawer and pull it out.

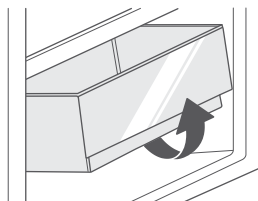

## Replacing the Light

Any replacement or maintenance of the LED lamps is intended to be made by the manufacturer, its service agent or similar qualified person.

# TROUBLESHOOTING

The following simple issues can be handled by the user. Please call the after-sales service department if the issues are not solved.

Problem	Possible Causes
Failed operation	<ul style="list-style-type: none"> <li>• Check whether the appliance is connected to power or whether the plug is in well contact</li> </ul>
	<ul style="list-style-type: none"> <li>• Check whether the voltage is too low</li> </ul>
	<ul style="list-style-type: none"> <li>• Check whether there is a power failure or partial circuits have tripped</li> </ul>
Odor	<ul style="list-style-type: none"> <li>• Odorous foods shall be tightly wrapped</li> </ul>
	<ul style="list-style-type: none"> <li>• Check whether there is any spoiled food</li> </ul>
	<ul style="list-style-type: none"> <li>• Clean the inside of the refrigerator</li> </ul>
Long-time operation of the compressor	<ul style="list-style-type: none"> <li>• Long operation of the refrigerator is normal in summer</li> </ul>
	<ul style="list-style-type: none"> <li>• When the ambient temperature is high, it is not recommended to have too much food in the appliance at the same time</li> </ul>
	<ul style="list-style-type: none"> <li>• Food shall get cool before being put into the appliance</li> </ul>
	<ul style="list-style-type: none"> <li>• The doors are opened too frequently</li> </ul>
Light fails to get lit	<ul style="list-style-type: none"> <li>• Check whether the refrigerator is connected to power supply and whether the illuminating light is damaged</li> </ul>
	<ul style="list-style-type: none"> <li>• Have the light replaced by a specialist</li> </ul>
Door does not close properly	<ul style="list-style-type: none"> <li>• The door is stuck by food packages. Too much food is placed</li> </ul>
	<ul style="list-style-type: none"> <li>• The refrigerator is tilted</li> </ul>
Loud noises	<ul style="list-style-type: none"> <li>• Check whether the floor is level and whether the refrigerator is placed stably</li> </ul>
	<ul style="list-style-type: none"> <li>• Check whether accessories are placed at proper locations</li> </ul>
Door seal is not tight	<ul style="list-style-type: none"> <li>• Remove foreign matter from the door seal</li> </ul>
	<ul style="list-style-type: none"> <li>• Heat the door seal and then cool it for restoration (or blow it with an electric dryer or use a hot towel for heating)</li> </ul>
Water pan overflows	<ul style="list-style-type: none"> <li>• There is too much food in the chamber or food stored contains too much water, resulting in heavy defrosting</li> </ul>
	<ul style="list-style-type: none"> <li>• The doors are not closed properly, resulting in frosting due to entry of air and increased water due to defrosting</li> </ul>

Problem	Possible Causes
Hot housing	<ul style="list-style-type: none"> <li>Heat dissipation of the built-in condenser via the housing, which is normal. When housing becomes hot due to high ambient temperature, storing too much food, or compressor shutdown, provide sound ventilation to facilitate heat dissipation.</li> </ul>
Surface condensation	<ul style="list-style-type: none"> <li>Condensation on the exterior surface and door seals of the refrigerator is normal when the ambient humidity is too high. Just wipe the condensate with a clean towel.</li> </ul>
Abnormal noise	<ul style="list-style-type: none"> <li><b>Buzz:</b> The compressor may produce buzzes during operation, and the buzzes are loud particularly upon start or stop. This is normal.</li> <li><b>Creak:</b> Refrigerant flowing inside of the appliance may produce creak, which is normal.</li> </ul>

Do you hear these abnormal sounds as below? Usually these sounds are normal.

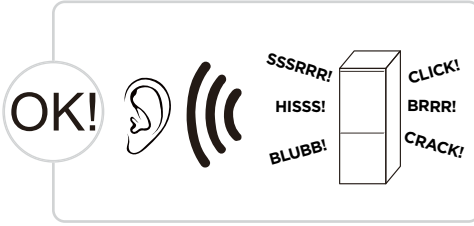

**CLICK:** Some electrical parts in the refrigerator, such as electric valve will make this noise when working. This is normal.

**HISS:** When the refrigerant flows into the evaporator, it will make this noise. This is normal.

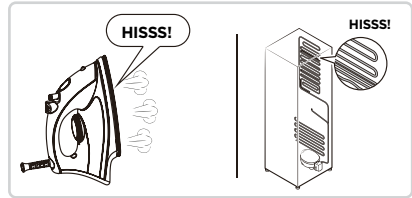
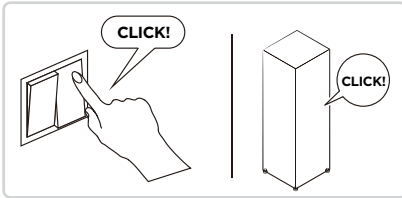

**BRRR:** The compressor will make this noise when working, and the buzzes are loud particularly upon start or stop. This is normal.

**SSSRRR:** The fan motor in the No Frost refrigerator will make this noise when working. This is normal.

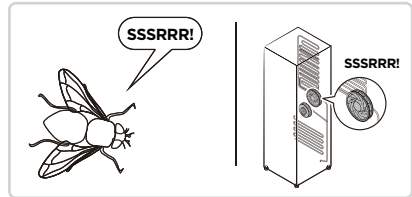
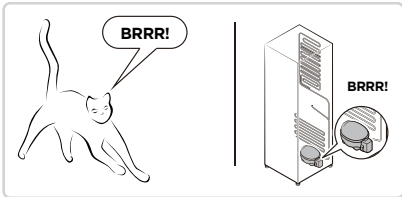

**BLUBB:** Refrigerant flowing through the pipes in the refrigerator will make this noise. This is normal.

**CRACK:** Cracking sound or broken ice sound: the overall structure of the refrigerator, air duct frost will be with the thermal expansion and contraction of the expansion sound, these are also normal physical phenomenon.

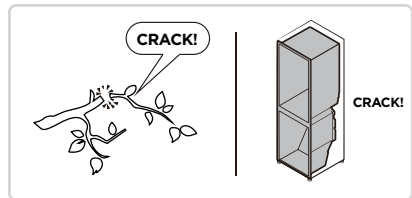
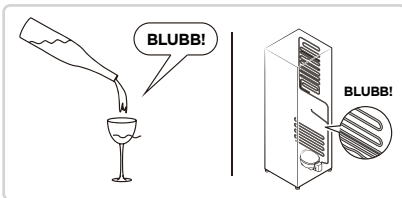

EN

# TRADEMARKS, COPYRIGHTS AND LEGAL STATEMENT

 logo, word marks, trade name, trade dress and all versions thereof are valuable assets of Midea

Group and/or its affiliates ("Midea"), to which Midea owns trademarks, copyrights and other intellectual property rights, and all goodwill derived from using any part of an Midea trademark. Use of Midea trademark for commercial purposes without the prior written consent of Midea may constitute trademark infringement or unfair competition in violation of relevant laws.

This manual is created by Midea and Midea reserves all copyrights thereof. No entity or individual may use, duplicate, modify, distribute in whole or in part this manual, or bundle or sell with other products without the prior written consent of Midea.

All the described functions and instructions were up to date at the time of printing this manual. However, the actual product may vary due to improved functions and designs.

## DISPOSAL AND RECYCLING

### Important instructions for environment

This symbol indicates that this product shall not be disposed with other household wastes at the end of its service life. Used device must be returned to official collection point for recycling of electrical electronic devices. To find these collection systems please contact to your local authorities or retailer where the product was purchased. Each household performs important role in recovering and recycling of old appliance. Appropriate disposal of used appliance helps prevent potential negative consequences for the environment and human health.



EN

### Compliance with RoHS Directive

The product you have purchased complies with EU RoHS Directive (2011/65/EU). It does not contain harmful and prohibited materials specified in the Directive.

### Package information

Packaging materials of the product are manufactured from recyclable materials in accordance with our National Environment Regulations. Do not dispose of the packaging materials together with the domestic or other wastes. Take them to the packaging material collection points designated by the local authorities.



## DATA PROTECTION NOTICE

For the provision of the services agreed with the customer, we agree to comply without restriction with all stipulations of applicable data protection law, in line with agreed countries within which services to the customer will be delivered, as well as, where applicable, the EU General Data Protection Regulation (GDPR).

Generally, our data processing is to fulfil our obligation under contract with you and for product safety reasons, to safeguard your rights in connection with warranty and product registration questions. In some cases, but only if appropriate data protection is ensured, personal data might be transferred to recipients located outside of the European Economic Area.

Further information are provided on request. You can contact our Data Protection Officer via [MideaDPO@midea.com](mailto:MideaDPO@midea.com). To exercise your rights such as right to object your personal data being processed for direct marketing purposes, please contact us via [MideaDPO@midea.com](mailto:MideaDPO@midea.com). To find further information, please follow the QR Code.



*make yourself at home*



[www.midea.com](http://www.midea.com)

© Midea 2025 all rights reserved