

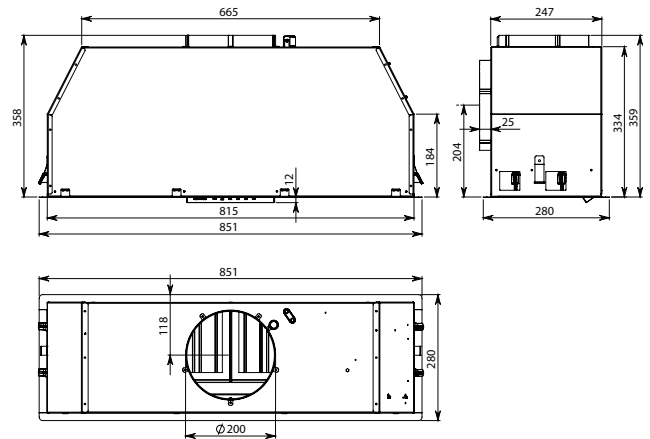

Product Features

| | |
|--------------------------------|---|
| Motor Type | Off Board Motor |
| Dimensions | 851(W) x 358(H) x 280(D)mm Suits 75cm-100cm Cooking Surfaces |
| Cut-Out | 822 x 250mm |
| Filtration Type | 2 x Baffle Filters |
| Lighting Type | Dynamic LED Strip |
| Finish | 304 Stainless Steel |
| Install | Flush Frame |
| Controls | Touch Control |
| Speed Settings | 3 Speed + Boost |
| Timer Function | 15 min Auto Shut-Off |
| Ducting | 200mm Circular Outlet + 6m of Flexible Ducting Supplied |
| Installation Info | Quick Install Clips |
| Remote Control | Optional |
| Grease Filter Alarm | Yes |
| Dishwasher Safe Filters | Yes |

Dimensioned Drawings



| Model Code | Motor Output | Motor Solution |
|------------------|------------------------|---------------------|
| FP3ML90S2-IR765 | 765m ³ /hr | In Roof Motor |
| FP3ML90S2-ER765 | 765m ³ /hr | External Roof Motor |
| FP3ML90S2-EW765 | 765m ³ /hr | External Wall Motor |
| FP3ML90S2-IR1140 | 1140m ³ /hr | In Roof Motor |
| FP3ML90S2-ER1140 | 1140m ³ /hr | External Roof Motor |
| FP3ML90S2-EW1140 | 1140m ³ /hr | External Wall Motor |

Charts: Air flow 50 Hz

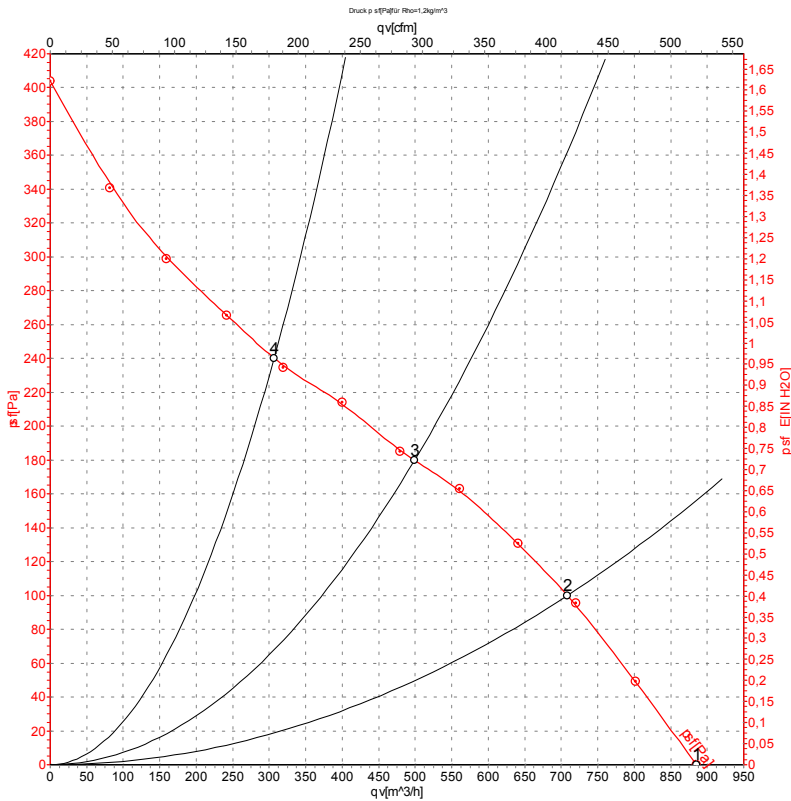

Measurement: LU-130008

Air performance measured as per ISO 5801 Installation category A. For detailed information on the measuring set-up, please contact ebm-papst. Suction-side noise levels: LwA measured as per ISO 13347 / LpA measured with 1m distance to fan axis. The values given are valid under the measuring conditions mentioned above and may vary according to the actual installation situation. With any deviation from the standard set-up, the specific values have to be checked and reviewed with the unit installed.

Measured values

| | U | f | n | P _e | I | qv | P _{sf} |
|---|-----|----|-------------------|----------------|------|-------------------|-----------------|
| | V | Hz | min ⁻¹ | W | A | m ³ /h | Pa |
| 1 | 230 | 50 | 2350 | 80 | 0.36 | 885 | 0 |
| 2 | 230 | 50 | 2240 | 86 | 0.38 | 710 | 100 |
| 3 | 230 | 50 | 2100 | 88 | 0.39 | 500 | 180 |
| 4 | 230 | 50 | 2185 | 86 | 0.38 | 305 | 240 |



Charts: Air flow 50 Hz

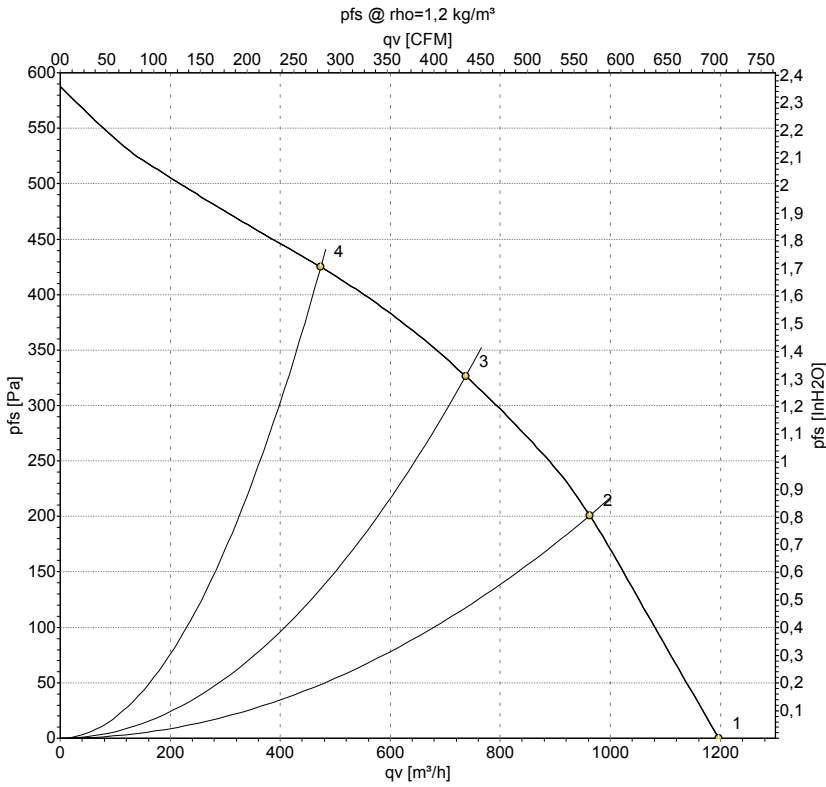

Measurement: LU-154575

Air performance measured as per ISO 5801 Installation category A. For detailed information on the measuring set-up, please contact ebm-papst. Suction-side noise levels: LwA measured as per ISO 13347 / LpA measured with 1m distance to fan axis. The values given are valid under the measuring conditions mentioned above and may vary according to the actual installation situation. With any deviation from the standard set-up, the specific values have to be checked and reviewed with the unit installed.

Measured values

| | U | f | n | P _e | I | qv | p _{fs} |
|---|-----|----|-------------------|----------------|------|------|-----------------|
| | V | Hz | min ⁻¹ | W | A | m³/h | Pa |
| 1 | 230 | 50 | 2660 | 130 | 0.57 | 1195 | 0 |
| 2 | 230 | 50 | 2500 | 155 | 0.68 | 965 | 200 |
| 3 | 230 | 50 | 2560 | 150 | 0.65 | 735 | 325 |
| 4 | 230 | 50 | 2615 | 139 | 0.61 | 475 | 425 |

U = Supply voltage · f = Frequency · n = Speed · P_e = Power input · I = Current draw · LpA_{in} = Sound pressure level inlet side · LwA_{in} = Sound power level inlet side · qv = Air flow
 p_{fs} = Pressure increase

