

Excelair

By Excelsior

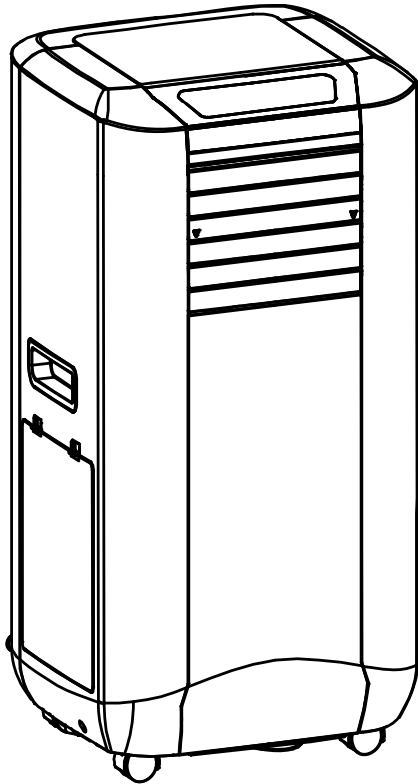

Portable Air Conditioner

Instruction Manual for
EPA20A

☆ **Read and retain these
instructions for future
reference**

SPECIFICATION

Model no.	EPA20A
Power supply	220-240V~, 50Hz
Cooling capacity	5.3kW
Power/Ampere consumption	1900W/8.5A
Air Volume	675m ³ /hr
Moisture Removal	51 ltr/day
Compressor	Rotary
Refrigerant	R-410A
Fan speed	3
Timer	1 ~ 24 hours
Working temperature	18 ~ 32°C
Exhaust pipe	Ø 165 x 1500 mm
Net Weight	42.5 kg
Dimension (WxDxH)	453 x 427 x 806 mm

REMARK:

1. Measuring condition for above is as per EN 14511 : DB=35°C , WB=24°C
 - DB = temperature of dry bulb = room temperature
 - WB = temperature of wet bulb = relative humidity.
2. Test condition for data in our rating label is as per safety regulation: EN 60335-2-40
3. Current & Fuse : F2L250V or T2L250V

BEFORE USE

- FOR INDOOR USE ONLY.
- DO NOT USE IN CABINETS, CLOSETS, BOATS, CARAVANS OR SIMILAR LOCATIONS.
- LEAVE THE UNIT TO STAND FOR 12 HOURS BEFORE CONNECTING TO THE MAINS SUPPLY AFTER TRANSPORT OR WHEN IT HAS BEEN TILTED (E.G. DURING CLEANING).
- ONLY USE IN THE UPRIGHT POSITION ON A FLAT LEVEL SURFACE AND AT LEAST 50CM FROM ANY OBJECTS.
- DO NOT USE THE UNIT IN A POTENTIALLY EXPLOSIVE ENVIRONMENT CONTAINING COMBUSTIBLE LIQUIDS, GASES OR DUSTS.
- DO NOT USE THE UNIT NEAR SWIMMING POOLS, WASHROOMS OR SIMILAR WET AREAS.
- DO NOT PLACE OBJECTS ON THE UNIT OR RESTRICT AIR INLET / OUTLET.
- ENSURE THAT THERE IS AT LEAST 50CM BETWEEN THE SIDES OF THE APPLIANCE AND ANY FLAMMABLE, HEATING MATERIALS.
- AVOID ANY WATER GETTING INSIDE THE UNIT.
- CLOSELY SUPERVISE ANY CHILDREN AND PETS WHEN UNIT IS IN USE.
- THIS APPLIANCE IS NOT INTENDED FOR USE BY PERSONS (INCLUDING CHILDREN) WITH REDUCED PHYSICAL, SENSORY OR MENTAL CAPABILITIES, OR LACK OF EXPERIENCE AND KNOWLEDGE, UNLESS THEY HAVE BEEN GIVEN SUPERVISION OR INSTRUCTION CONCERNING USE OF THE APPLIANCE BY A PERSON RESPONSIBLE FOR THEIR SAFETY. CHILDREN SHOULD BE SUPERVISED TO ENSURE THAT THEY DO NOT PLAY WITH APPLIANCE.
- SWITCH OFF AND UNPLUG WHEN NOT IN USE.
- DO NOT PULL THE UNIT ALONG BY THE CORD.
- AVOID OVER-TWISTING, -COILING, -PULLING THE POWER CORD, NEVER USE NYLON OR IRON WIRE TO TIE THE POWER CORD.
- NEVER REACH TO RETRIEVE THE UNIT IF IT HAS FALLEN IN WATER. IN SUCH CASE, IMMEDIATELY PULL THE PLUG. HAVE THE UNIT CHECKED BEFORE USING IT AGAIN.

BEFORE USE

- DO NOT USE EXTENSION CORDS.
- IF THE SUPPLY CORD IS DAMAGED, IT MUST BE REPLACED BY AN ELECTRICIAN OR SIMILARLY QUALIFIED PERSON.
- THE MAINS SUPPLY MUST CONFORM TO THE SPECIFICATION SHOWN ON THE RATING PLATE AT THE BACK OF THE UNIT.
- THE APPLIANCE SHALL BE INSTALLED IN ACCORDANCE WITH NATIONAL WIRING REGULATIONS.
- DO NOT EXCEED THE RECOMMENDED ROOM SIZE FOR MAX. EFFICIENCY.
- CLOSE THE DOORS AND WINDOWS WHEN IN USE.
- KEEP CURTAINS OR BLINDS CLOSED DURING THE SUNNIEST PART OF THE DAY.
- KEEP FILTERS CLEAN.
- ONCE ROOM HAS REACHED THE DESIRED CONDITIONS, REDUCE TEMPERATURE AND VENTILATION SETTING.
- ONLY A LICENSED PROFESSIONAL IS ALLOWED TO DISMANTLE OR MODIFY THE APPLIANCE.
- THE MACHINE IS TO BE USED ONLY FOR ITS PRESCRIBED PURPOSE. ANY OTHER USE IS DEEMED TO BE A CASE OF MISUSE. THE USER/OPERATOR, NOT THE MANUFACTUER WILL BE LIABLE FOR ANY DAMAGE OR INJURIES OF ANY KIND CAUSED AS A RESULT OF THIS.
- NEVER STORE UNIT ON SIDE OR UPSIDE DOWN.

PARTS

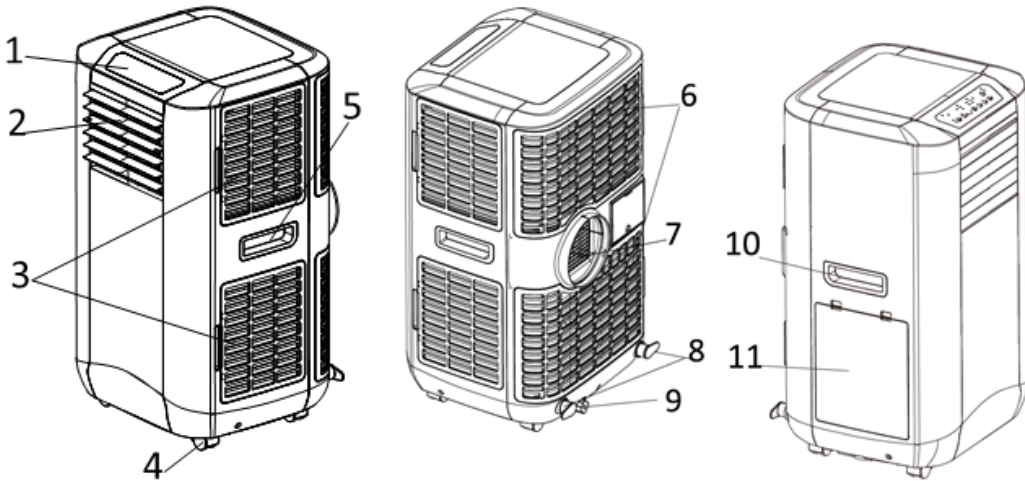

- | | |
|--------------------------------|---|
| 1. Control Panel | 7. Exhaust air outlet |
| 2. Air outlet | 8. Cord hanger |
| 3. Side air filter (air inlet) | 9. Drainage knob / drainage point |
| 4. Caster | 10. Handle |
| 5. Handle | 11. Water bottle (for energy efficiency boosting) |
| 6. Air filter (air inlet) | |

Accessories

12. Exhaust hose.
13. Remote control
14. Drain tube for continuous drainage
15. Round Adapter –for connecting the unit and the exhaust pipe
16. Flat Adaptor – for connecting the exhaust pipe and the window spacer
17. Window spacer - for filling the open window space
18. Window spacer - for filling the open window space
19. Window spacer - for filling the open window space and with hole for connection to exhaust hose
20. Active carbon filter

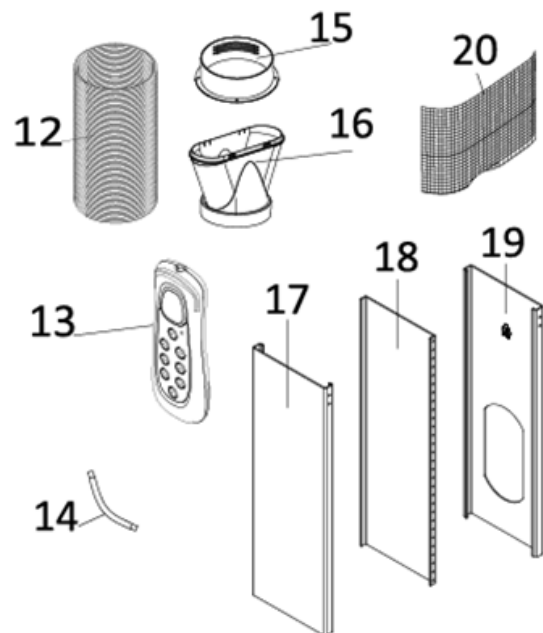

INSTALLATION

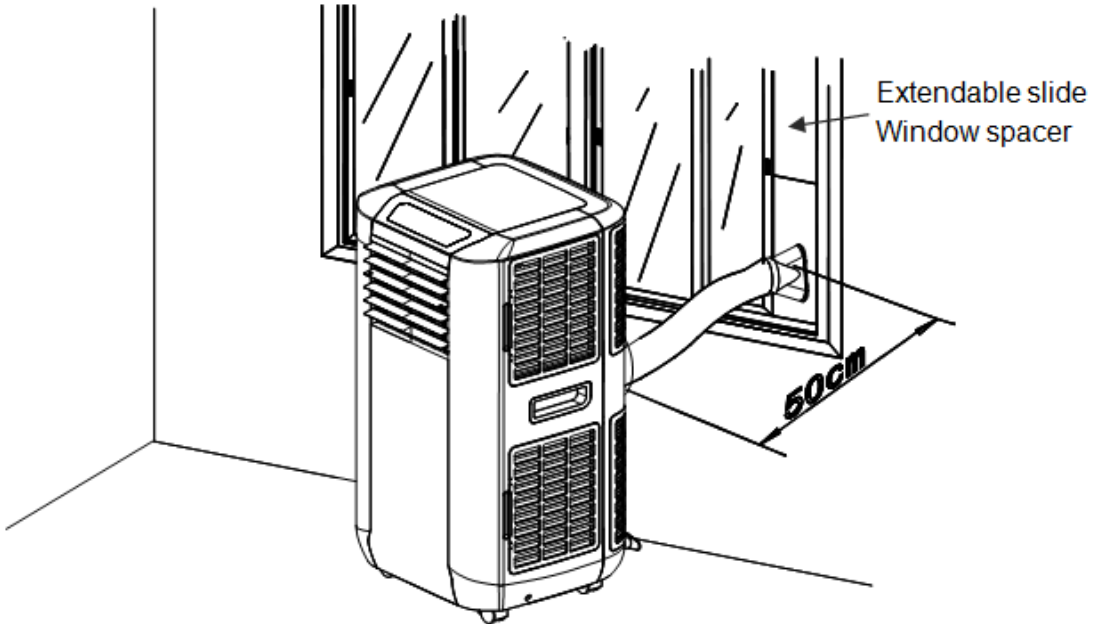

The unit is a portable air conditioner that may be moved from room to room.

1. Using the supplied window spacer

- Insert window spacer in window gap and adjust the length as you need.
- Feed exhaust hose through the window spacer and slide window across so that spacer is held securely. This technique may also be used for sash windows.

- Use only the hose provided and clip exhaust hose and unit adaptor to the back of the air conditioner

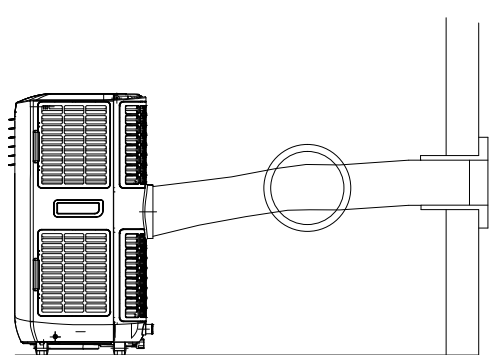

- Avoid kinks and bends in the exhaust hose as this will cause expelled moist air to build up causing the unit to overheat and shut down.

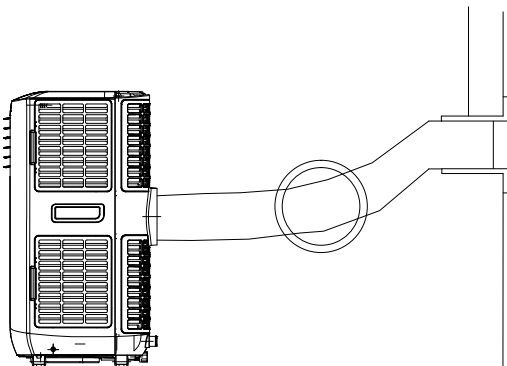

- The hose may be extended from 300mm to 1500mm but for maximum efficiency use the shortest length possible.

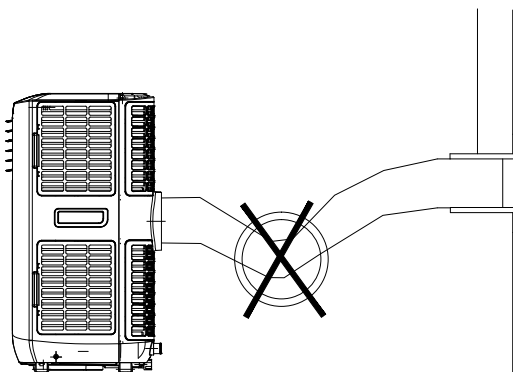

WARNING!

The length of the exhaust pipe is specially designed according to the specification of this product. Do not replace or prolong it with your own private hose as this could cause the unit to mal-function.

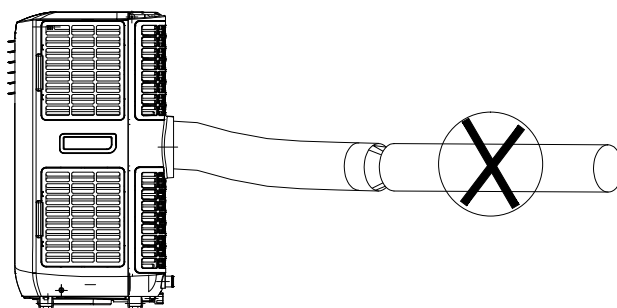

Installation of the carbon filter

This machine is equipped with the active carbon filter. The activated carbon is charcoal that has been treated with oxygen to open up millions of tiny pores between the carbon atoms. It is used to get rid of unwanted odors (smoke, fumes, and animal odor). Please note, the carbon filter is not washable, its life span is variable and depends on the ambient conditions where the unit is used. The filter should be checked periodically and replaced if necessary (normally, it's 6 months), below is the installation of the active carbon filter along with this unit:

1. Separate the filter frame the unit.

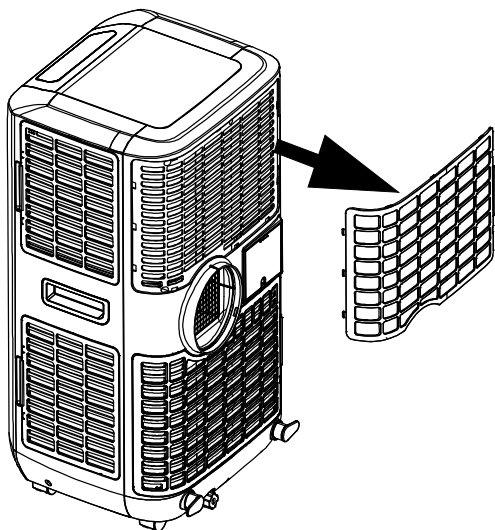

2. Take out the carbon filter from its bag.

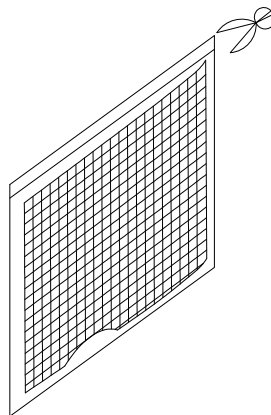

3. Apply the carbon filter on the unit.

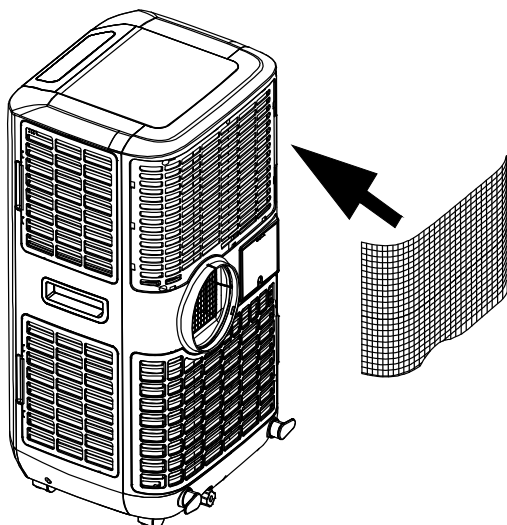

4. Fix back the filter frame on the unit.

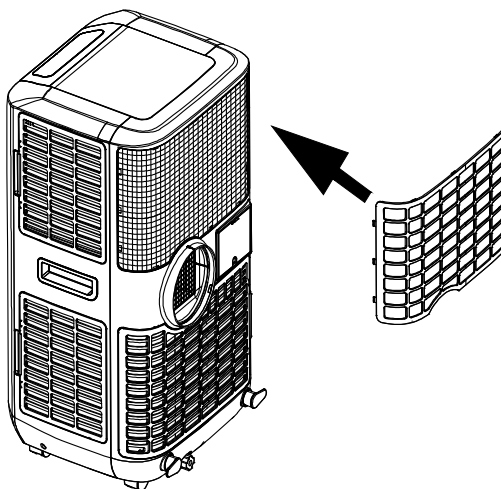

OPERATION

Soft Touch Control panel

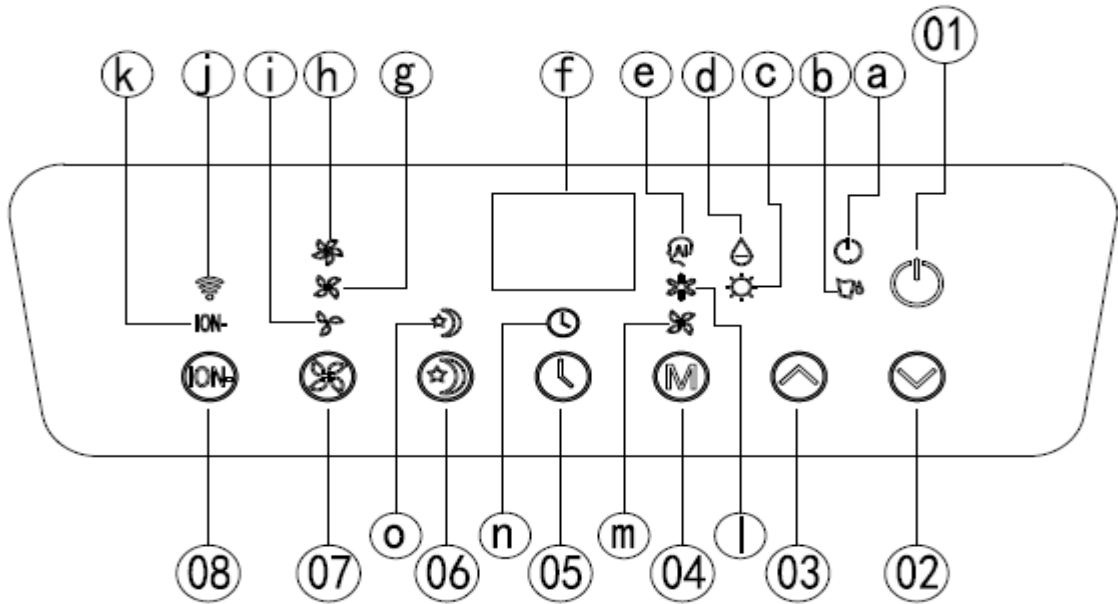

1. ON/OFF (POWER) button
2. TEMPERATURE DOWN button
3. TEMPERATURE UP button
4. MODE button
5. TIMER button
6. SLEEP button
7. SPEED (ventilation) button
8. IONIZER/Tio2 button (optional, only for the model with this function)
9. COOL mode indicator
10. FAN mode indicator
11. Timer indicator
12. Sleep mode indicator
13. Display window
14. Compressor operation indicator

Adjust the air vent

Before using the unit, please do open the horizontal louver! Then Adjust the louvers to your desired direction

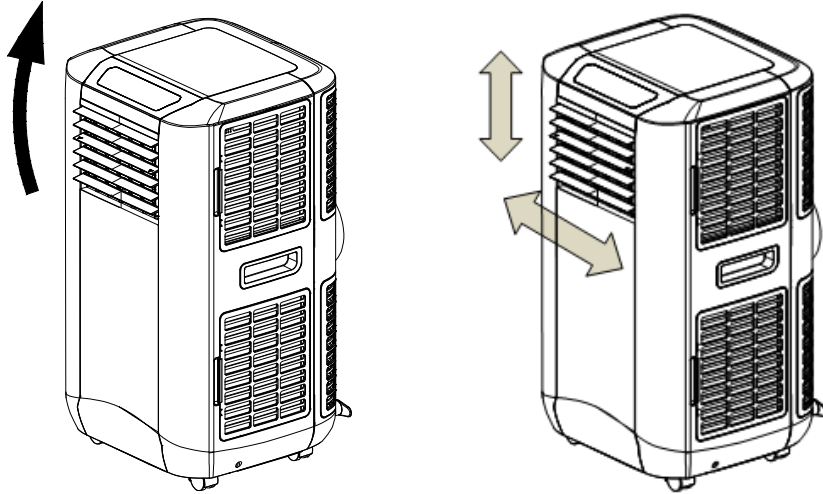

Turning ON/OFF

Press ON/OFF button, the unit will start in AUTO (automatic) mode.

Automatic mode

In automatic mode, the unit can cool, ventilate and heat depending on ambient temperature and setpoint adjustment. The unit is preset as follows:

1. **If ambient temperature is $> 23^{\circ}\text{C}$** , the unit will be in automatic cooling mode. Default setting 24°C . During this operation, the indicator for AUTO and COOL mode light up.
2. **If the ambient temperature is $< 24^{\circ}\text{C}$, but $> 20^{\circ}\text{C}$** , the unit will work in ventilation mode. During this operation, the indicator for AUTO and FAN mode light up.
3. **If the ambient temperature is $< 20^{\circ}\text{C}$** , the unit will work in heating mode. During this operation, the indicator for AUTO and HEAT mode light up.

Setpoint setting in automatic cooling mode 18-32°C

If you set the setpoint at 24°C the unit starts to cool at 27°C (Setpoint + 3°C). It cools down to 25°C (Setpoint + 1°C) and then switches back to the ventilation.

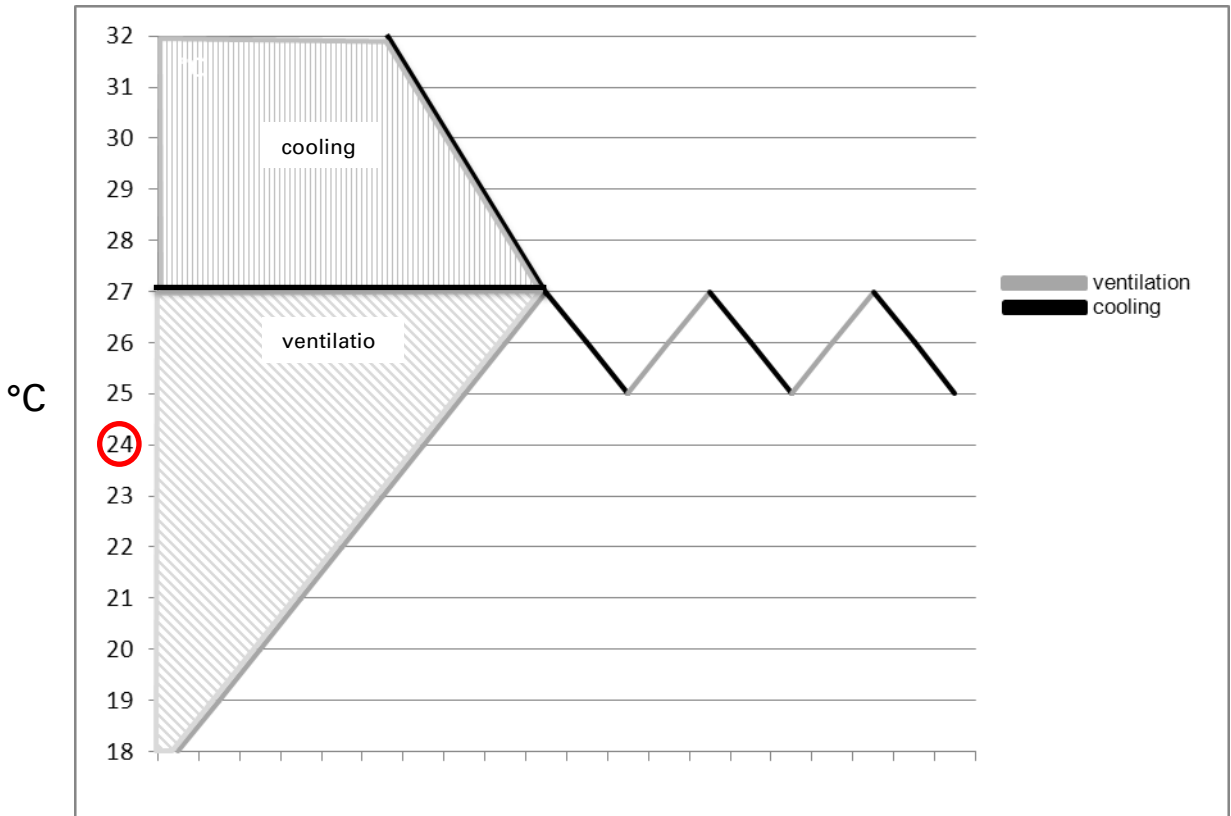

Setting mode/function

Time

Press MODE button to select required working mode: cooling, fan or dehumidify (dry)
Sign of your selected mode comes on.

Setting temperature

1. Press 'Temperature up' or 'Temperature down' button to regulate the temperature you desired.
2. The display window will show the temperature you set as you press 'Temperature up' or 'Temperature down' button. Otherwise, it will always show the ambient temperature.
3. The pre-setting temperature of this machine is: 24°C for cooling.

Setting ventilation speed

Press SPEED button to choose the ventilation speed you need, high, medium or low. The sign of high or low ventilation will light on at the same time.

Setting timer

1. Touch TIMER button to set the operating hours you desired (1 to 24 hours, the sign of timer will light on). When the set time has been reached, the machine will turn off automatically. The display window will show the hour(s) you set as you press TIMER button. If the timer button is not pressed, the unit will work continuously.
2. By touching the timer but without turning on the other functions, you can PRE-SET the time for the machine to work. For example, if you press the timer to '2', the unit will work automatically after 2 hours.

Sleep function

1. In cooling mode, by pressing the SLEEP button, the set temperature will increase 1°C at the 1st hour; another 1°C at the second hour, then keeps at that temperature.
2. In sleep mode, the ventilation will keep at low speed. Re-press the SLEEP button, the setting temperature and ventilation speed will return to the pre-selected one.
3. The unit will shut down automatically after the SLEEP function running for 12 hours.
4. ***Please note, the sleep function is not available while the machine is working in ventilation, dehumidification or auto mode. Only available in cooling mode.***
5. ***When the machine is in Sleep function, the Fan Speed would turn to be LOW speed.***

Dehumidify (DRY) mode

In dehumidify (DRY) mode, the temperature cannot be adjusted, the ventilation will fix at low speed. When the unit is operating in Dehumidify (DRY) mode, humidity extracted from the air is collected in an internal tank. If the tank reaches full, the compressor and motor cut out automatically. At the same time, the "Water Full" indicator comes on. An alarm will also sound. When the tank is full, drain the water as shown in the page concerning "DRAINAGE". You may also use the unit without having to empty the tank so often by using "continuous drainage", please also refer to the page about "DRAINAGE".

Self-diagnosis

This machine is equipped with self-diagnosis function. If something is wrong in the machine, the LED will show the word “E1” or “E2”.

- E1 means the sensor wire for room temperature does not connect well (this wire is located in the centre of the evaporator).
- E2 means the sensor wire for anti-frost does not connect well (this wire is located at the side of evaporator). ☆ **Self-diagnosis “E2” is only for cool & heat model.**

As this time, please contact your retailer. Please **DO NOT** dismantle the machine in any case.

All the above functions can also be performed with the supplied remote control. This remote control requires 2 pcs AAA batteries to operate (battery is not supplied along with the unit).

EFFICIENCY BOOSTING

This unit is equipped with “energy efficiency boosting” function, by adding water (3L max.) to the water gate at the side of the unit, the energy efficiency can be elevated. The principle is: while the machine is working, the condenser will be getting hot, if you add the water into the unit after the unit has been worked for more than one hour, the water will cool down the condenser, thus it consumes less power, i.e. saving energy.

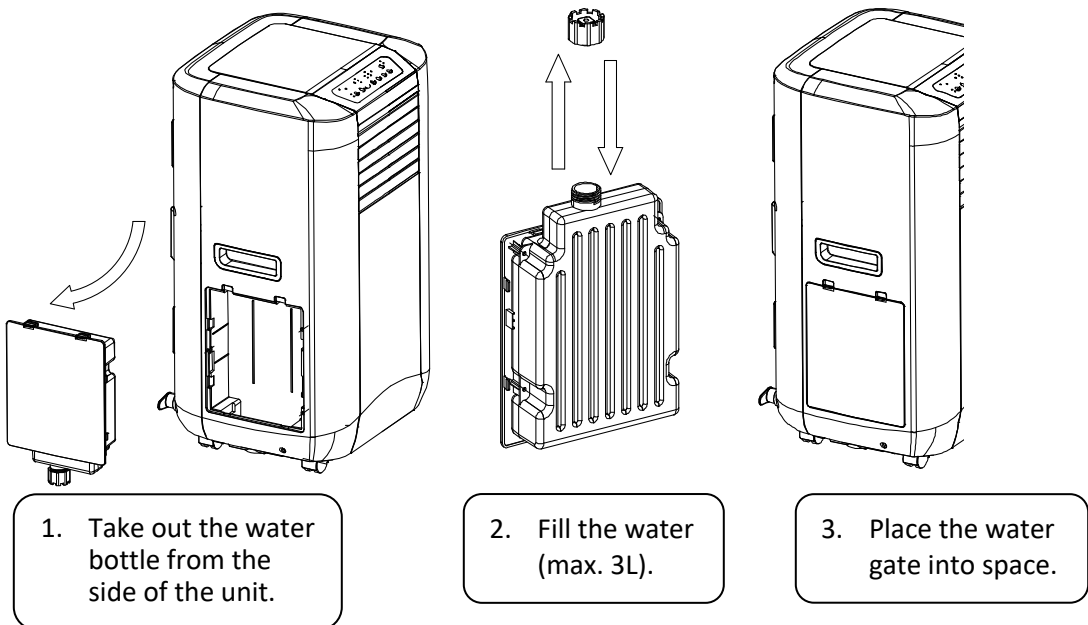

NOTE

1. This efficiency feature by adding water is proposed to do after one hour operation and the water should NOT be over 3L, otherwise, the “water full” indicator will light in red and the unit will stop working.
2. In case the “water full” indicator is in red, please drain the water from the drain point at the back side of the unit until the red light goes out. The unit should work again now.

IMPORTANT !

1. To prolong the compressor's life, after switch-off of the unit, please wait for 3 minutes (at least) before re-switch.
2. The cooling system will switch off if the ambient temperature is lower than the set one. The ventilation, however, keeps working on the set level. If the ambient temperature rises above the selected level, the cooling will return to work.
3. This machine is equipped with ANTI-FROST function. While using the heating function during low temperature, sometimes the heating will stop for a while in order to melt the frost. As this occurs, just wait for the heating returns to work.

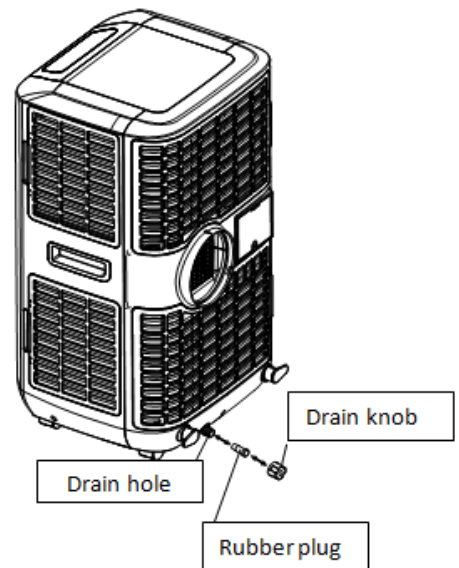

DRAINAGE

When the unit is operating in Cooling or Dehumidify (DRY) mode, humidity extracted from the air is collected in an internal tank. If the tank reaches full, the compressor and motor cut out automatically. At the same time, the “Water Full” indicator comes on. An alarm will also sound. When the tank is full, carry out the following instructions:

1. Turn off the air conditioner and avoid moving it when full.
2. Position a container (a water tray for example) underneath the drain hole.
3. Remove the drain knob & rubber plug from the drain hole and allow the water to drain out.
4. When the container is almost full, replace the rubber plug in the drain hole and empty the water tray.
5. Repeat until the unit is emptied.
6. Replace the rubber plug and tighten the drain knob firmly.
7. Switch on the unit - the full water or compressor operating indicator should not be flashing.

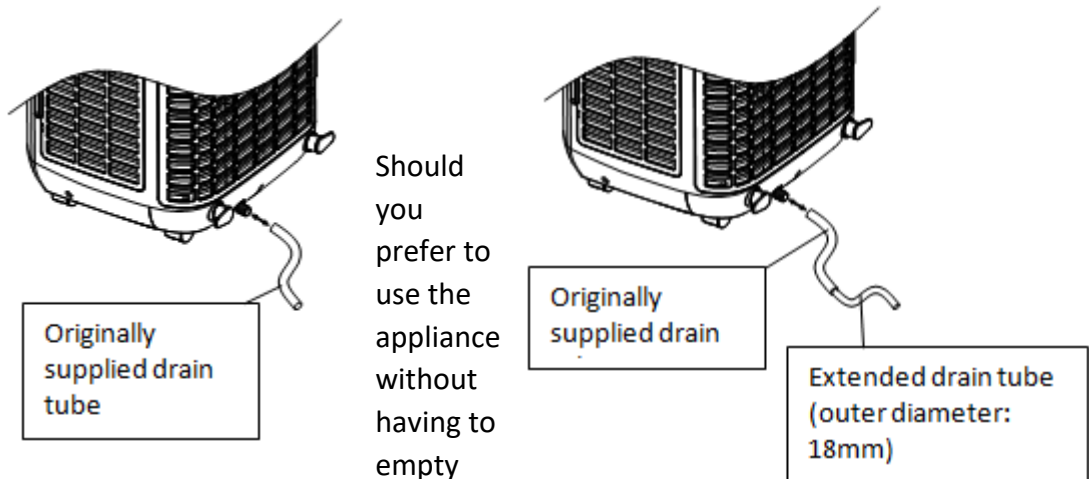

the tank every so often, proceed as follows :

- Remove the drain knob and rubber plug and retain for future use.
- Connect the drain tube supplied to the water outlet as shown and locate the other end into a drain.
- The drain tube may be extended by adding an extension tube and using a suitable connector.

Please note

1. The drain must be at a lower level than the drain hole on the unit.
2. Flashing 'Water Full' indicator will not function in this mode of drainage.
3. If you want to extend the water tube, you can connect it with another tube (OD: 18mm). *The extended tube is NOT supplied along with the unit.

MAINTENANCE

Always unplug the air conditioner from the mains before cleaning.
To maximize the efficiency of the air conditioner, clean the unit regularly.

Cleaning the housing

Use a soft, damp cloth to wipe the body clean.

Never use aggressive chemicals, gasoline, detergents, chemically treated cloths, or other cleansing solutions. These all could possibly hurt the cabinet.

Cleaning the filter

Use a vacuum cleaner or tap the filter lightly to remove loose dust and dirt from the filters and then rinse thoroughly under running water (no hotter than 40°C).

Dry thoroughly before replacing.

Notice! Never operate the unit without the filters.

End of season storage

- Drain any water in the unit before completely operating the unit on ventilation only mode for a few hours, to thoroughly dry the inside.
- Clean or change the filter
- Unplug and store the power cord on the cord hanger.
- Replace in the original carton or cover for storage.

FAULT CHECK LIST

- The air conditioner does not run**
- Is the air conditioner plugged in?
 - Is there a power failure?
 - Is the 'full water' indicator flashing?
 - Is the room temperature below the set temperature?
- The machine seems to do little**
- Is there direct sunshine? (Please put down the curtain.)
 - Are too many windows or doors open?
 - Are there too many people in the room?
 - Is there something in the room producing lots of heat?
- The machine seems to do nothing.**
- Is the filter dusty, contaminated?
 - Is the air intake or output blocked up?
 - Is the room temperature below your selected temperature?
- Too noisy**
- Is the machine positioned unevenly so as to create vibration?
 - Is the floor underneath the machine uneven?
- The compressor doesn't run.**
- Is so, it is possible the overheat protection of the compressor is on. Just wait for the temperature to drop.

☆ **Never try to repair or dismantle the unit yourself**

WARRANTY

For all warranty claims please return to place of purchase. If unit is deemed to be faulty it will be replaced during the 24 month warranty period.

Excelair

By Excelsior

For any queries or assistance call
Customer Service
(Australia Only)
1300 174 876
Hours of operation:
Monday to Friday 8am - 5pm EST

IMPORTANT: RETAIN THESE INSTRUCTIONS FOR FUTURE USE.

Excelair™ is a trademark of Sitro Group Australia
www.excelsiorproducts.com.au