

USER MANUAL

INALTO

INALTO.HOUSE

8kg Heat Pump Clothes Dryer

MODEL CODE

IHPD800S2W



AUSTRALIAN OWNED

V1.0 0725

Welcome

Congratulations on purchasing your new Clothes Dryer!

Residentia Group Pty Ltd
ACN. 600 546 656
165 Barkly Avenue
Burnley, Victoria 3121
Australia

—
Applico Ltd
635 Great South Road
Penrose, Auckland 1061
New Zealand

—
InAlto
www.inalto.house
f /inalto.house
@ /inalto.house

The InAlto brand is proudly distributed within Australia by Residentia Group Pty Ltd and within New Zealand by Applico Ltd.

Please refer to the warranty card at the rear of this manual for information regarding your product's parts and labour warranty, or visit online at:

- www.residentia.group
- www.applico.co.nz
- www.inalto.house

Both Residentia Group & Applico are customer obsessed and our Support Teams are there to ensure you get the most out of your appliance. Should you want to learn more about recommended usage, the various features of your appliance, and importantly taking care of the unit when cleaning, our Support Teams are here to help.

Telephone Contacts:

- AU: 1300 11 4357
- NZ: 0800 763 448

It is important that you read through the following use and care manual thoroughly to familiarise yourself with the installation and operation requirements of your appliance to ensure optimum performance.

Again, thank you for choosing an InAlto appliance and we look forward to being of service to you.

SCAN ME

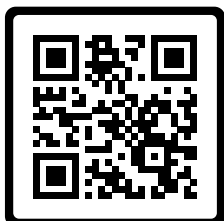

Scan to Register your InAlto Appliance or go to:

- AU: www.inalto.house/en-au/registration
- NZ: www.inalto.house/en-nz/registration

By registering your product, you will receive advanced support, stay updated with the latest from InAlto and find out about new products and promotions.

Contents

[02 Welcome](#)

[04 Safety Information](#)

[07 Your Clothes Dryer](#)

[08 Installation Instructions](#)

[10 Operation Instructions](#)

[16 Technical Specifications](#)

[17 Cleaning & Maintenance](#)

[19 Troubleshooting](#)

[21 Purchase Details](#)

[22 Warranty Information](#)

Customer Care

InAlto recommends the use of original spare parts. When contacting our customer service team on 1300 11 4357, please ensure that you have the following information at hand (which can be found on your appliances' rating plate).

- Model Number
- Serial Number













Safety Information

General Use

- This appliance is intended only for indoor, domestic use and for drying water-washed textiles.
- It is not intended for commercial or industrial use.
- Maximum dry load capacity: 8kg.
- Do not use the dryer if industrial chemicals have been used to clean garments.
- Do not dry unwashed items in the dryer.
- Keep ventilation openings clear to prevent the backflow of combustion gases from fuel-burning appliances, including open fires.
- The dryer must not be installed:
 - Behind a lockable door
 - Behind a sliding door
 - Behind a door with a hinge on the opposite side of the dryer
 - if it restricts the full opening of the dryer door.

Dryer Care Symbols

Please ensure your clothing is suitable for machine drying. Do not use the dryer for garments that are unsuitable for machine drying or labelled with the following symbols:

 Dry	 Normal	 Not tumble dry normal	 Do not dry
 Line dry / hang to dry	 Drip dry	 Dry flat	 In the shade
 Dry clean	 Do not dry clean	 Dry clean normal cycle with any solvent	 Dry clean normal cycle petroleum solvent only

Important Safety Instructions

CAUTION: Fire hazard!

- To protect the safety of yourself and others, and to prevent property damage, please follow these important safety instructions:
- This product is an electrical appliance intended solely for drying textiles that have been washed in water in a household setting. It is not intended for commercial or industrial use.
- Always observe proper electrical safety when operating this appliance. Ensure the power source is earthed reliably. The earth wire must be grounded and must not be connected to public utilities such as water pipes or gas lines. The earth and neutral wires must be correctly distinguished and must not be connected together.
- The maximum dry load capacity for this appliance is 8 kilograms.
- This tumble dryer must not be used if garments have been cleaned using industrial chemicals. Do not dry unwashed clothing in the tumble dryer.
- Adequate ventilation must be provided to prevent the backflow of gases from other appliances that burn fuel, including open flames.
- **WARNING:** Never stop the dryer mid-cycle unless all items are immediately removed and laid out to allow heat to dissipate.
- Exhaust air must not be discharged into a flue system used to extract fumes from gas- or fuel-burning appliances.
- Do not install the appliance behind a lockable door, a sliding door, or a door with hinges on the opposite side to that of the dryer, as this may restrict full opening of the dryer door.
- Keep pets away from the appliance.

Safety Information (Continued)

Fire and Explosion Hazards

Items affected by oil can ignite spontaneously, especially when exposed to heat sources such as inside a tumble dryer. These items become warm, causing oxidation in the oil, which generates heat. If the heat cannot escape, the items may become hot enough to catch fire. Piling or stacking such items may increase this risk.

If it is unavoidable to dry items that contain vegetable or cooking oils, or that have been contaminated by hair care products, they must be washed in hot water with extra detergent before drying. This will reduce, but not eliminate, the risk of fire.

Do not dry clothing that has come into contact with flammable substances such as petrol, acetone, alcohol, kerosene, turpentine, waxes, wax removers, or spot removers without first washing them thoroughly in hot water with extra detergent.

Do not dry the following items in the tumble dryer:

- Foam rubber (latex foam)
- Shower caps
- Waterproof textiles
- Rubber-backed items
- Pillows or clothing containing foam rubber pads

Follow the usage instructions on fabric softeners or similar products carefully.

Remove any objects from clothing pockets, such as lighters or matches.

WARNING: Never stop a tumble dryer before the drying cycle has completed unless all items are quickly removed and laid out to allow heat to dissipate.

This appliance contains the environmentally friendly refrigerant R290, which is flammable. Keep away from open flames and other sources of ignition.

Electrical Safety

WARNING: POTENTIAL ELECTRIC SHOCK!

- Do not unplug the appliance by pulling on the cord.
- Do not plug in or unplug the appliance with wet hands.
- Do not damage the power cord or plug. If the power cable is damaged, it must be replaced by the manufacturer, a service agent, or a similarly qualified person to avoid hazard.
- **This appliance is for indoor use only.**
- Ensure ventilation openings are not obstructed by carpets or other coverings.

Injury Prevention

- Do not disassemble or install the dryer without instruction or supervision.
- Do not stack this dryer on top of a washing machine without a proper stacking kit. If stacking is required, an appropriate stacking kit must be purchased and installed by the manufacturer, a service agent, or a similarly qualified person.
- Do not lean on the open door of the dryer.
- Do not place objects on top of the dryer such as candles or electrical cookers.

Preventing Damage

- Do not overload the dryer beyond the rated capacity.
- Do not operate the dryer without the filter door or filter base in place.
- Do not dry clothes that have not been properly spun.
- Do not place the dryer in direct sunlight.
- Do not install the dryer in damp or wet environments.
- When cleaning or performing maintenance, unplug the appliance. Do not wash the dryer with water.

Additional Fire Safety Notes

- Do not dry clothing stained with flammable substances such as coal oil or alcohol, as this may lead to an explosion.
- Clean the lint filter frequently.
- Do not allow lint to accumulate around the dryer.
- Ensure that air inlets and outlets are never blocked.

Safety Information (Continued)

Risk to Children

- The appliance can be used by children aged from 8 years and above and persons with reduced physical, sensory or mental capabilities or lack of experience and knowledge if they have been given supervision or instruction concerning use of the appliance in a safe way and understand the hazards involved. Children shall not play with the appliance. Cleaning and user maintenance shall not be made by children without supervision.
- Animals and children may climb into the machine. Check the machine before every operation.
- Young children should be supervised that they do not play with the appliance.
- Machine may be very hot during the operation. Keep kids and pets far away from the machine during the operation very wet rooms as well as in the rooms with explosive or caustic gas.
- If the appliance becomes abnormally hot, **disconnect it from the power source immediately.**

Risk of Explosion

- Do not wash or dry articles that have been cleaned in, washed in, soaked in, or dabbed with combustible or explosive substances (such as wax, oil, paint, gasoline, degreasers, dry-cleaning solvents, kerosene, etc.) This may result in fire or explosion.
- Before hand thoroughly rinse items of washing by hand.

Disposal of Packaging

The packaging is designed to protect the appliance from damage during transport. All packaging materials are environmentally friendly and should be recycled. Recycling helps reduce raw material usage and minimises landfill waste.

Heat Pump Drying

Heat pump dryers operate at lower temperatures than traditional vented or condenser dryers, offering energy efficiency and fabric care benefits. However, they also require specific precautions:

- Always ensure the heat exchanger and air intake vents are kept clean and free from obstructions. Blocked airflow can affect drying performance and cause the appliance to overheat. Refer to the maintenance section for instructions on cleaning the heat exchanger filter.
- Do not cover or block any ventilation grilles or openings. This appliance relies on a continuous flow of air for safe and efficient operation. Inadequate airflow may result in overheating or damage to internal components.
- Heat pump dryers collect moisture in a condensate tank. Always empty the tank after each cycle unless your model is plumbed for direct drainage.
- Do not attempt to open the heat pump compartment or service any internal components yourself. The internal system contains pressurised refrigerant (R290), which is flammable and must only be handled by a licensed technician.
- Avoid drying garments with metal accessories such as zippers, clasps, or underwire bras if they are likely to cause sparks or damage to the drum or heat exchanger. Use a laundry bag for delicate or metal-trimmed items.
- If the dryer is installed in a confined space such as a cabinet, ensure that installation clearances meet the minimum ventilation requirements in this user manual. Poor ventilation can impair heat exchange and increase drying time or energy use.
- Do not use the dryer in temperatures below 5°C or above 35°C. Extreme ambient conditions may affect compressor performance or cause the appliance to malfunction.
- As with all tumble dryers, heat pump dryers must not be used to dry items that have come into contact with flammable or volatile substances, even after washing. This includes cleaning solvents, oils, hair sprays, and fuels.
- Always allow the cycle to complete fully. Heat pump dryers use residual heat during the cool-down phase to reduce fire risk. Interrupting the cycle and leaving clothing heaped in the drum may pose a hazard.

Your Clothes Dryer

Key

- | | | | |
|----------------------|---------------------|----------------------|---------------------------|
| 1. Top Panel | 4. Galvanised Drum | 7. Door | 10. Hose Holder |
| 2. Power Cord & Plug | 5. Door Lint Filter | 8. Air Inlet | 11. Condensing Drain Hose |
| 3. Water Container | 6. Control Panel | 9. Maintenance Cover | 12. Connector |

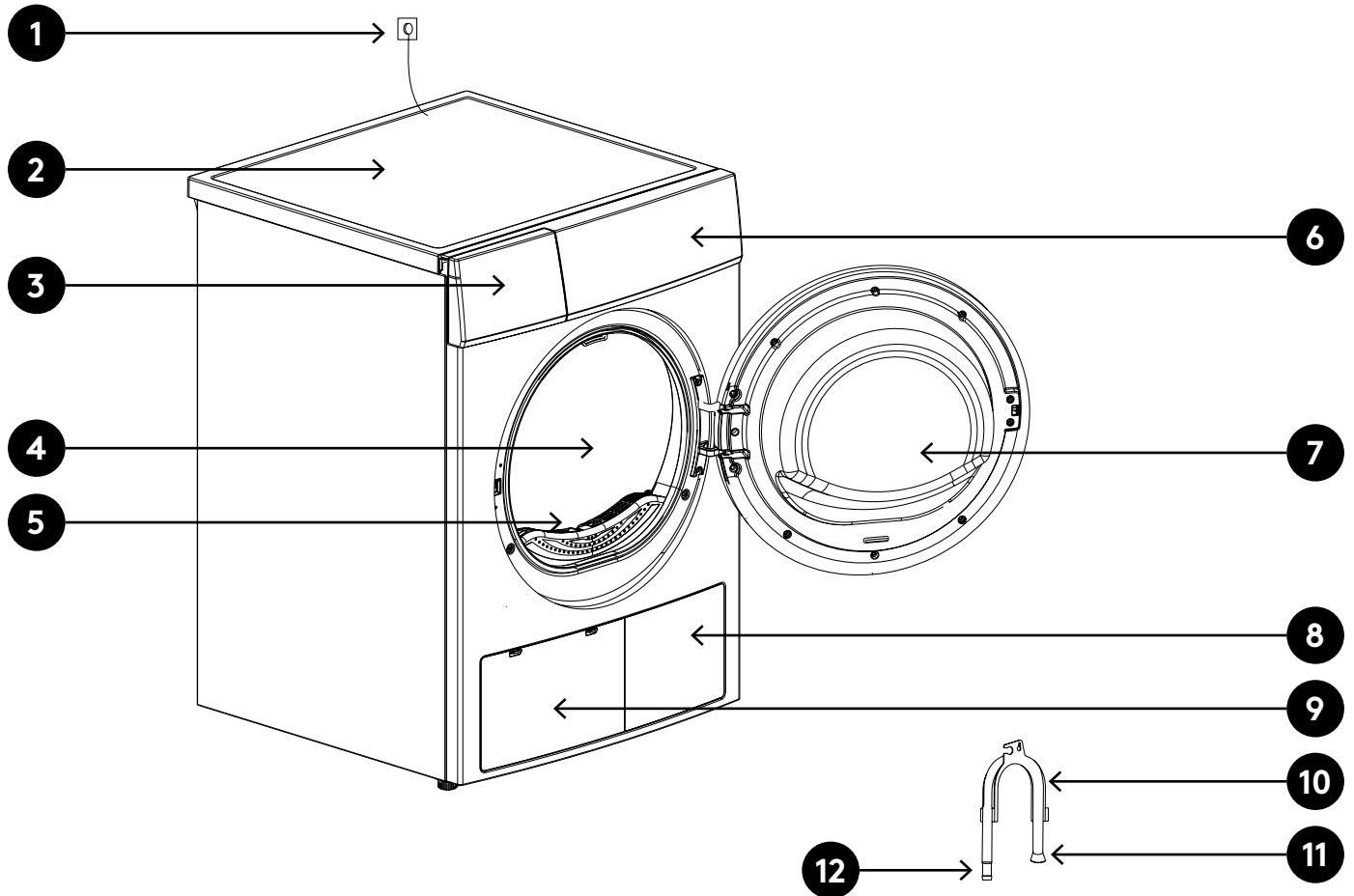

NOTE: The diagrams in this user manual is for explanation purposes only. Your product may appear differently.

Installing the Optional Bypass Drain Hose

1. Begin by pulling up the joint of the drain hose.

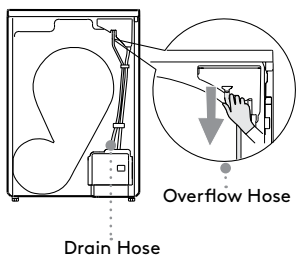

2. Next pull up the upper drain hose, avoiding any kinks in the hose.

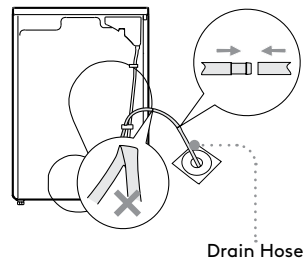

3. Connect the external drain hose using the hose holder.

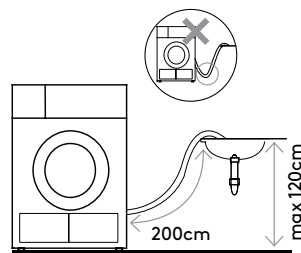

4. This can be done either through water drainage or your laundry sink.

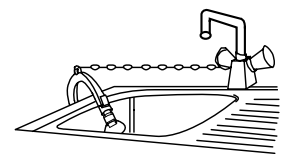

Installation Instructions

Important Safety Instructions

- Upon unpacking, inspect the appliance thoroughly. Do not proceed with installation if there are any signs of transport damage.
- Safe and proper operation can only be guaranteed if the appliance is professionally installed by a qualified technician in line with these instructions.
- The person responsible for installing or assembling the appliance is liable for any damage or faults arising from incorrect installation.
- Installation and servicing must be carried out by an authorised service agent or a similarly qualified professional.
- Before carrying out any installation or maintenance work, disconnect the appliance from the mains power supply.
- **IMPORTANT:** If the power cord is damaged, it must be replaced by Residentia Group or one of its authorised service representatives. Contact 1300 11 HELP (4357) and ensure the appliance is completely disconnected from the power source.

Transport & Handling

- Always handle the appliance carefully. Do not grasp any protruding parts, such as the door.
- The door must not be used as a handle during transport.
- If the appliance cannot be moved in an upright position, it may be tilted at an angle less than 30°.
- **WARNING:** Improper handling may cause injury or damage to the machine.
- The unit is heavy. Never attempt to carry it alone — always move it with assistance from another person.
- Before transport or installation, ensure the path is clear of obstacles — open doors, remove floor objects or coverings.
- Remove all packaging materials before use and dispose of them responsibly.
- Retain packaging materials until installation is complete in case the unit needs to be returned or transported again.
- Keep all packaging materials out of reach of children. Children may become entangled or suffocate on plastic film or swallow small parts.

Pre-Installation Checks

- Before setting up the dryer, inspect it for any visible signs of damage. Do not install or operate a damaged unit.
- The dryer must not be installed in areas where temperatures may fall to freezing, as frost can damage internal parts, particularly the condensation system and hoses.
 - The appliance must not be positioned:
 - Behind a lockable door
 - Behind a sliding door
 - Behind a door with a hinge on the opposite side to that of the dryer door, if this restricts full door opening.
- Do not restrict ventilation clearance below or around the appliance. Avoid installation on deep-pile carpets, timber strips, or similar obstructions, which can trap heat and affect performance.
- It is recommended that the dryer be installed close to your washing machine for ease of use.
- Leave sufficient space at the rear of the machine for air circulation and access to the filter and drain hose.

Stacking the Dryer

- Do not stack this dryer on top of a washing machine unless a suitable stacking kit is used.
- Only use stacking kits recommended by the manufacturer.
- Stacking must be carried out by the manufacturer, an authorised agent, or a similarly qualified person to avoid hazards.

Installation Location

- The dryer must be installed in a clean, well-ventilated area, where dust and debris do not accumulate.
- Ensure air can circulate freely around the appliance.
- Do not block the front air inlet or the rear air intake vents.
- Avoid placing the appliance near curtains or other materials that could obstruct airflow.

Installation Instructions (Continued)

Levelling the Dryer

- To minimise vibration and noise, place the dryer on a solid, level surface.
- The adjustable feet must never be removed.
- Once in position, check that the appliance is level using a spirit level.
- If the dryer is not level, adjust the feet by hand or with a suitable tool until it is.

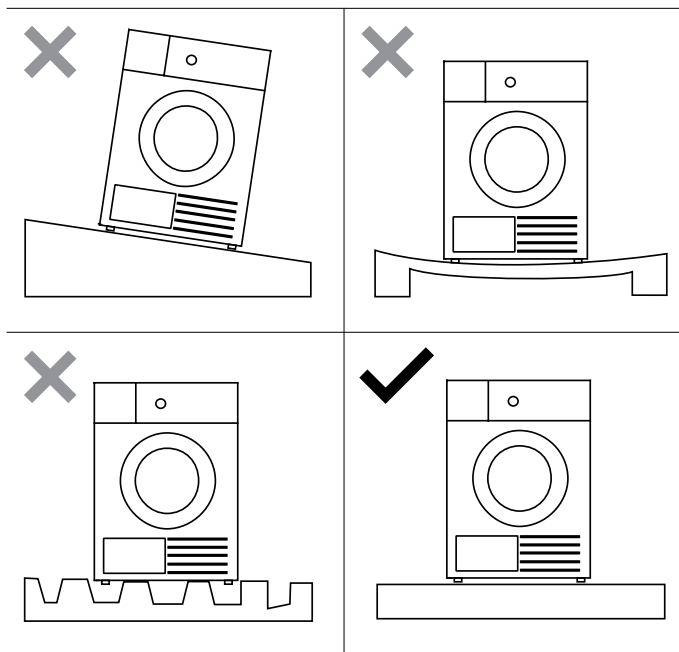

Electrical Connection

- Ensure that the mains voltage matches the voltage specified on the appliance rating label.
- The dryer must be connected directly to a standard power outlet. Do not use:
 - A power board
 - Universal plug
 - Multi-plug adapters
 - Extension cords
- Ensure the socket is accessible after installation for easy disconnection if required.

Final Checks Before Use

- Remove all packaging and protective materials from inside the drum before operating the dryer.
- Read the full user manual to familiarise yourself with the dryer's features and maintenance requirements prior to first use.

Operation Instructions

Control Panel

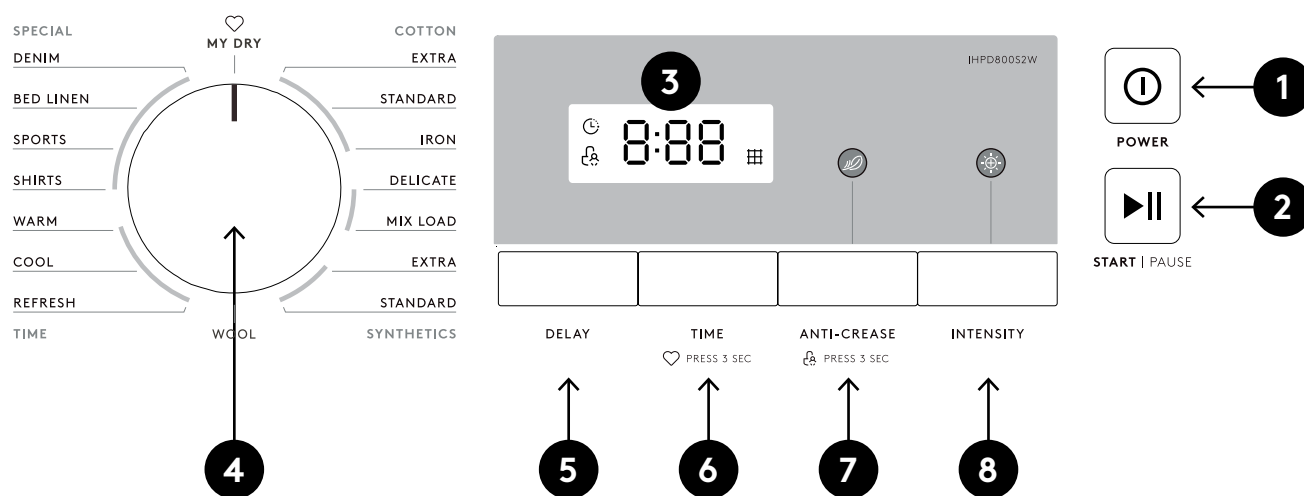

Item	Symbol	Description
1 Power		Press to switch the dryer on or off before or after selecting a program.
2 Start / Pause		Starts the selected program or pauses it mid-cycle if needed.
3 LED Display		Shows the remaining time, active functions and status indicators during operation.
4 Program Dial	N/A	Turn the dial to select the desired drying program based on fabric type and drying needs.
5 Delay	N/A	Allows you to delay the start of the drying program by up to 24 hours, so it runs at a time that suits you.
6 Time / My Dry	N/A	Lets you manually set the drying duration in 10-minute increments when using the Time program. Press and hold for 3 seconds to save your preset My Dry cycle.
7 Anti-crease / Child Lock		Gently tumbles laundry after the cycle ends to reduce wrinkles if clothes aren't removed immediately. Press and hold for 3 seconds to activate or deactivate the Child Lock function.
8 Intensity		Adjusts how dry you want your laundry at the end of the cycle, based on your preference.

Operation Instructions (Continued)

LED Display

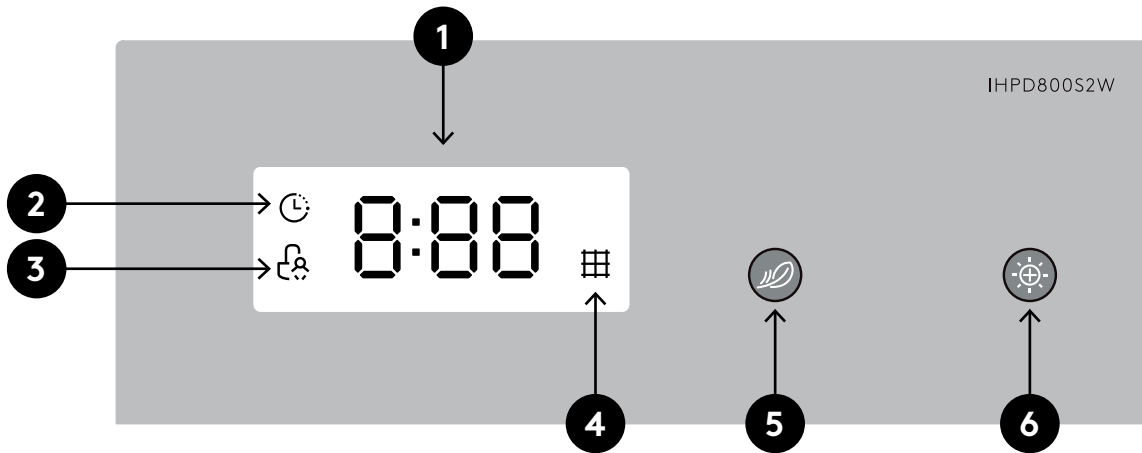

Display	Symbol	Description
1 LED Display	8:88	The display shows the time remaining for the current operation or provides important error messages should an issue occur.
2 Delay Indicator		This indicator light illuminates when the Delay Start function is active, letting you know the operation has been scheduled to begin at a later time.
3 Child Lock Indicator		The Child Lock indicator lights up when the child lock feature is activated. This means the dryer's controls are locked to prevent accidental changes or operation, ensuring safety.
4 Clean Filter Warning Indicator		Over time, lint and fibres from your laundry accumulate in the door filter, which can restrict airflow, reduce drying efficiency, and increase energy consumption. Regular cleaning helps maintain performance and safety.
7 Anti-crease Indicator		This indicator illuminates when the Anti-crease function is selected. When active, the dryer will periodically tumble the load after the cycle ends to help prevent wrinkles and creases from setting in.
8 Intensity Indicator		The Intensity indicator shows the selected drying intensity level. This helps you confirm the setting you've chosen for how thoroughly your clothes will be dried.

Operation Instructions (Continued)

Before First Use

- After transporting the dryer, allow it to stand upright for at least two hours before switching it on. This gives the refrigerant time to settle.
- Wipe the inside of the drum with a soft cloth to remove any dust or residues from manufacturing.
- Place a few clean rags into the drum.
- Plug in the power supply and press the Power button.
- Select the Refresh program, then press the Start/Pause button.
- Once the cycle is complete, refer to the Maintenance and Cleaning section to clean the door filter.
- Running an initial cycle with clean cloths helps remove any residual odours or particles from manufacturing.
- **NOTE:** It is normal for the compressor and water pump to make some operating noise during the drying cycle.

Before Drying

- **CAUTION:** Ensure the dryer has been correctly installed and connected before first use.
- Spin laundry at a high speed in your washing machine to reduce moisture content. This shortens drying time and improves energy efficiency.
- Sort laundry by fabric type to ensure even drying and choose the appropriate drying program.
- Close all zips, hooks, and fasten buttons. Tie fabric belts and secure loose items.
- Check and empty all pockets — remove items such as lighters, coins, and matches.
- Remove or sew in underwires from bras before drying.
- Fasten duvet covers and pillowcases to prevent small garments from getting trapped inside.
- Leave jackets open and unzip long zips to ensure even drying.
- Avoid over-drying, as this may cause creasing and damage to fabrics.
- Do not dry items containing rubber or similar heat-sensitive materials.
- Keep the area around the dryer clean. Do not operate the dryer near combustible dust such as coal dust or flour.

- Only open the door once the drying cycle is complete to avoid hot steam or heat exposure.
- Clean the lint filter and empty the water tank after each cycle to maintain performance and reduce energy use.
- Do not place garments in the dryer that have been dry-cleaned.

Approximate Dry Weight Guidelines

- Refer to the fabric care label and machine capacity chart in this manual for weight estimates by garment type.
- **NOTE:** Do not overload the dryer. Avoid drying dripping wet laundry as it may damage the appliance and clothing.

After Washing / Program Completion

- When the drying cycle finishes, the dryer will beep and the display will show "0:00".
- The cycle phase LED will illuminate to indicate completion.
- If laundry is not removed promptly, the Anti-crease function will activate automatically to reduce wrinkling.
- After removing laundry, press the Power button and unplug the dryer.
- Let the appliance cool down slightly before cleaning the filter or emptying the water tank.

Drying Process

- Once a program is started, the drum will begin to rotate.
- The LED indicator for the active cycle phase will light up, and the remaining time will appear on the display.

Operation Instructions (Continued)

Using the Additional Functions

Delay Start Function

The Delay function allows you to postpone the start of the drying program by up to 24 hours.

- Load your laundry and close the door.
- Press the Power button.
- Turn the program selector to choose your desired drying cycle.
- (Optional) Select any additional functions such as Anti-crease or Signal if required.
- Press the Delay button repeatedly to select your preferred delay time.
- Press the Start/Pause button. The dryer will enter standby mode and begin the countdown. The delay icon will blink on the display.
- Once the countdown reaches zero, the selected program will begin automatically.

NOTE:

- To pause the countdown, press Start/Pause again.
- To cancel the Delay function, press the Power button.

Time Adjustment Function

- When using the Time program, you can manually adjust the drying time in 10-minute increments by pressing the Time button.
- This function is ideal for items that require specific drying durations, such as pillows or jackets.

Anti-crease Function

At the end of the drying cycle, the Anti-crease function gently tumbles the laundry to reduce wrinkling.

- By default, the drum will intermittently rotate for 30 minutes after drying ends.
- You can extend this period to 120 minutes by pressing the Anti-crease button during cycle setup.
- If you remove the laundry promptly at the end of the drying cycle, this function may not be needed.

NOTE:

- This function is available with all programs except: Cool, Wool, and Refresh.
- Laundry can be removed at any time during the Anti-crease phase.

Intensity Function

The Intensity function allows you to adjust the final dryness level of the laundry, depending on your preference.

Ideal for achieving a cupboard-dry finish or reducing residual moisture for line-drying or ironing.

- Press the Intensity button before starting the program to increase the drying intensity.
- This function is available on most programs except: Cotton Iron, Delicate, Wool, and Time.

My Dry (Preset Drying settings)

The My Dry function lets you save your preferred drying program for easy access in future.

- Select your desired drying program and any additional settings (e.g. Intensity, Anti-crease).
- Press and hold the Time button for 3 seconds until a beep sounds to confirm your settings have been saved.
- Next time, simply turn the selector to My Dry and press Start/Pause to begin your preset program.

NOTE:

To update your saved cycle, repeat the steps above with your new selections.

Child Lock Function

The Child Lock helps prevent accidental or unsafe operation by disabling the control panel during a drying cycle.

- To activate: Press and hold the Anti-crease button for 3 seconds while a program is running.
- When activated, a Child Lock icon will appear on the display. All buttons will be disabled except the Power button.
- To deactivate: Press and hold the Anti-crease button again for 3 seconds.

NOTE:

This feature is particularly useful if there are young children in the home.

Operation Instructions (Continued)

Drying Programs

Program		Max Load	Application	Delay	Time
Cotton	Extra	8.0kg	Ideal for thick or multi-layered cotton items such as towels, bedding, or heavy shirts. This setting ensures clothes are dried thoroughly for immediate storage.	Yes	No
	Standard		Suitable for everyday cotton garments that need to be dried completely. Offers an energy-efficient option with good drying performance.		
	Iron		Best for shirts or other items that will be ironed after drying. Leaves garments slightly damp to make ironing easier.		
Delicate		1.0kg	Gentle drying for delicate fabrics such as lingerie or items labelled as hand-wash only. Operates at a lower temperature to protect fibres.	Yes	No
Mix Load		3.5kg	Designed for mixed loads of cotton and synthetic fabrics. Ensures even drying of garments with varied fibre types in a single cycle.	Yes	No
Synthetics	Standard	3.5kg	For thinner synthetic garments that don't require ironing, such as baby clothes, activewear, or casual shirts.	Yes	No
	Extra		Dries thicker or multi-layered synthetic garments thoroughly. Suitable for items such as polyester sportswear or microfibre items.		
Wool		1.0kg	Specially designed to refresh wool garments by gently drying them to restore softness and fluffiness without damage.	Yes	No

Operation Instructions (Continued)

Drying Programs

Program		Max Load	Application	Delay	Time
Special	Denim	4.0kg	Optimised for thick denim clothing, including jeans and jackets. Ideal for loads that have been spun at high speed in the washer.	Yes	No
	Bed Linen	4.0kg	Perfect for drying sheets, pillowcases, or bulky bedding items. Avoid overloading for best results.		
	Sports	3.0kg	Designed for activewear and sports clothing made from technical fabrics like polyester. Does not iron garments.		
	Shirts	1.0kg	Reduces creases in shirts and blouses by applying an Anti-crease phase. Loosely place items in the drum and hang promptly after drying.		
My Dry		—	Allows you to save your own customised drying settings for easy access.	Yes	—
Time	Warm	—	Used to finish drying individual items or to dry thick, multi-layered garments like jackets or pillows.	Yes	Yes
	Cool	—	A no-heat cycle for airing out clothing or freshening garments that have been stored.		
	Refresh	1.0kg	Refreshes clothes that have been folded for a long time, reducing creases. For best results, operate between 20–220 minutes in 10 minute steps.		

Technical Specifications

Product Specifications

Model	IHPD800S2W
Rated Capacity	8kg
Dimensions (W x D x H mm)	595 x 600 x 845
Energy Efficiency Rating (MEPS)	7 Stars
Ambient Temperature	+5°C ~ +35°C
Rated Input Power	800W
Rated Voltage	220-240V~
Rated Frequency	50Hz
Refrigerant/Amount	R290/120g
Net Weight	41kg
GWP	3
CO ² - eq	0.00t

NOTE:

- This product is subject to continuous improvement, specification are subject to change without prior notice.
- The rated capacity is the maximum capacity to be dried at one time. Make sure that the dry clothes which are loaded into the appliance do not exceed the rated capacity.
- Do not install the tumble dryer in a room when there is a risk of frost occurring. At temperatures around freezing point the tumble dryer may not be able to operate properly.
- There is a risk of damage if the condensate water is allowed to freeze in the pump, hoses and/or condensate water container
- This product was tested in accordance with AS/NZS 2442.1 and AS/NZS 2442.2 using the program: Standard Cotton, Normal Dry Intensity, which is the program recommended for drying a normally soiled cotton load at the rated capacity.

Cleaning & Maintenance

To keep your dryer operating efficiently and safely, regular cleaning and care are essential. Follow the steps below to maintain your appliance and extend its lifespan.

Cleaning the Dryer

Regular cleaning helps keep your dryer running efficiently and looking its best. Always follow safety precautions when cleaning any part of the appliance.

WARNING:

- Always disconnect the power cord before cleaning.
- Use only a soft cloth dampened with clean water.
- Do not use solvents, abrasive cleaners, glass cleaners, or general-purpose cleaners, as these may damage plastic surfaces or other components.
- It is recommended to wear gloves during cleaning to protect your hands.

How to Clean:

- Prepare a soft cloth dampened with clean water (not dripping wet).
- Wipe down the outside of the appliance, including the control panel.
- Open the dryer door and clean the inside of the door window, removing any lint or smudges.
- Clean the door seal (rubber gasket) around the drum opening to remove lint and moisture.
- Gently wipe the humidity sensor located inside the drum, using only a damp cloth.
- Remove all filters (door filter and lower filter), then wipe around the filter housing and airflow openings.
- Before using the dryer again, dry all cleaned areas thoroughly with a soft, dry cloth.

TIP: Clean the inside of the door and door seal weekly to avoid build-up of detergent residue or fabric softener.

Emptying the Water Container

After each cycle, the dryer collects moisture in the internal water container. This must be emptied to avoid interruptions.

If you have installed the Optional Bypass Drain Hose, you can skip this step. Refer to page 7 for drain hose setup instructions.

To empty the water container:

- Gently pull out the water container using both hands, keeping it level to avoid spills.

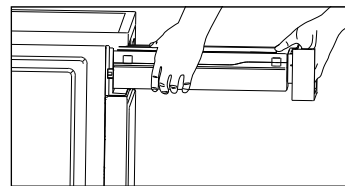

- Tilt the container over a sink or basin to pour out the collected water (condensate).

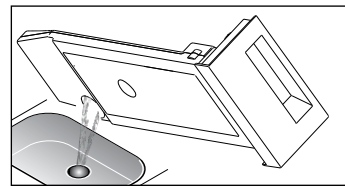

- Once empty, carefully slide the container back into place.

WARNING:

- Always empty the water container after each use.
- If the container becomes full during operation, the dryer will pause automatically and the display will show "FUL".
- After emptying the container, press the Start/Pause button to resume drying.
- Do not drink the water collected in the container.
- Never run the dryer without the water container installed.

Cleaning & Maintenance (Continued)

Cleaning the Door Filter

- There is a primary door lint filter your dryer. Ensure the lint filter is cleaned every cycle.
- Take it out and clean the filter. Then place it back into the washer.
- If cleaning with running water, ensure that the door filter is thoroughly dry before reinstallation.

WARNING:

- A blocked filter can restrict airflow, leading to longer drying times and increased energy use.
- Always disconnect the power before cleaning.
- Do not use the dryer without the filter installed.

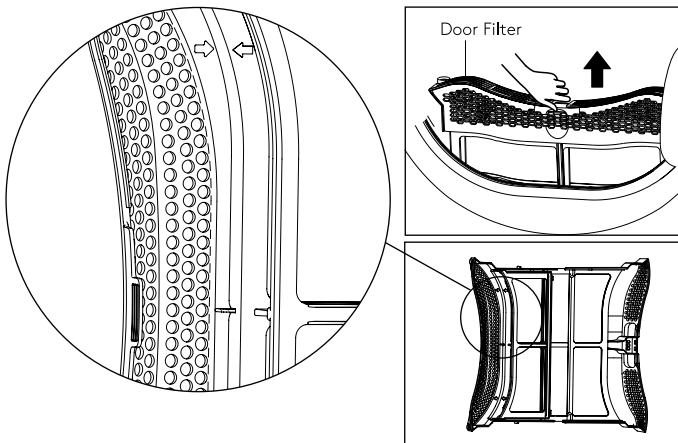

To ensure the double-layer filter can be closed smoothly, the arrows at both ends need to be aligned, and the middle slot and the rib need to be aligned.

NOTE: Take notice of the correct orientation before reinstalling the door filter.

Cleaning the Heat Exchanger

The heat exchanger helps remove moisture from your laundry. Over time, lint and fluff can build up on the cooling fins, reducing drying efficiency. Clean it approximately every 3 months, or more frequently if you notice reduced performance.

To clean the Heat Exchanger:

- Switch off the dryer and unplug it from the power outlet.
- Open the service panel to access the heat exchanger compartment.
- Using a vacuum cleaner with a soft brush attachment, gently remove any visible lint or fluff from the surface of the heat exchanger fins.
- Be extremely careful not to apply pressure or bend the delicate metal fins.

WARNING:

- Do not touch the heat exchanger with your hands, as the sharp metal fins may cause injury.
- Avoid using water or cleaning chemicals.
- Never press, scrub, or poke the fins, as damage may prevent the dryer from functioning correctly.

TIP:

Mark your calendar to clean the heat exchanger every 3 months, or check monthly if you dry several loads per week.

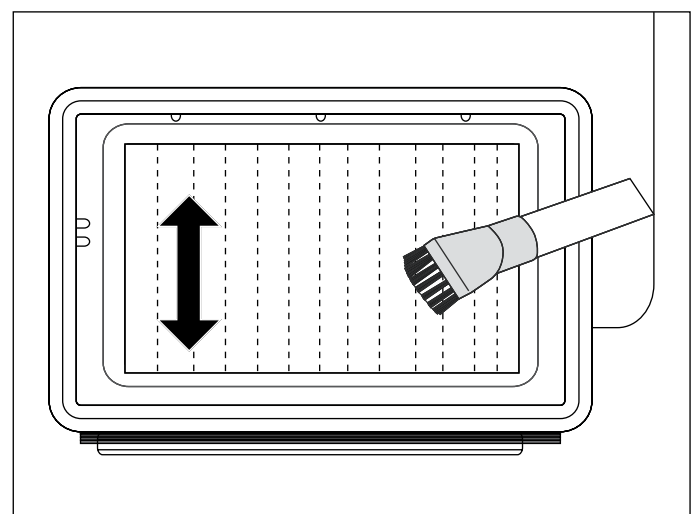

Troubleshooting

Troubleshooting

If your dryer is not operating as expected, refer to the guide below for possible causes and solutions.

If the issue persists, please contact our Customer Service team on 1300 11 4357 or email support@residentiagroup.com.au

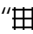
Problem	Possible Cause	Solution
Display is not turning on	<ul style="list-style-type: none">• Power outlet not working• Mains plug not inserted• Program not selected• Dryer not turned on	<ul style="list-style-type: none">• Check power supply• Insert plug properly• Select a program• Press Power button
Display shows "FUL"	<ul style="list-style-type: none">• Water container is full• Display error	<ul style="list-style-type: none">• Empty the water container• Press Start/Pause to resume• If not full, restart dryer• If issue remains, contact service
"  symbol is lit	<ul style="list-style-type: none">• Lint filter is full	<ul style="list-style-type: none">• Remove and clean the lint filter• Reinstall correctly
Dryer does not start	<ul style="list-style-type: none">• Not plugged in• Dryer not turned on• Door not closed• Program not selected	<ul style="list-style-type: none">• Connect to power• Press Power button• Close the door• Select a program• Press Start/Pause
Clothes not drying or the drying takes too long	<ul style="list-style-type: none">• Lint filter blocked• Water container full• Drain hose blocked• Poor ventilation• Low program setting	<ul style="list-style-type: none">• Clean the lint filter• Empty the water container• Check drain hose• Ensure proper installation• Use higher intensity or time program
Humming noise	Compressor is running	This is normal; no action required
Dryer switches off after program ends	Auto power-off function	This is normal; no action required

Troubleshooting

Operation in case of emergency

In the event of an emergency you should:

- Switch off the appliance using the Power button
- Switch the appliance off at the power outlet and immediately unplug.
- Call the Customer Service team on 1300 11 4357 or email support@residentiagroup.com.au

Some minor faults can be fixed by referring to the instructions given in this Troubleshooting section. There is also a self-help section online at <https://support.residentiagroup.com.au>

IMPORTANT: If your appliance appears to be operating incorrectly, then you should disconnect it from your electrical supply and then contact After Sales Support.

WARNING:

- Never dismantle the clothes dryer.
- Do not attempt to repair the appliance yourself.
- If overflow occurs, turn off the main water supply before calling a service.

Please note that if a technician is asked to attend whilst the product is under warranty and finds that the problem is not the result of an appliance fault, then you may be liable for the cost of the call out charge.

The appliance must be accessible for the engineer to perform any necessary repair.

If your appliance is installed in such a way that an engineer is concerned that damage will be caused to the appliance or your laundry, then they will not complete a repair.

Please refer to the conditions of that appear on the warranty card at the rear of this user manual.

Error Codes

Display Code	Possible Cause	Solution
E32	Humidity sensor error.	Please contact the Residentia Group support team on 1300 11 HELP (4357) or email support@residentiagroup.com.au
E33	Temperature sensor error.	
FUL	Water pump failure or water level sensor failure.	
	Water Container is full.	Empty the water container.

If problems still occur, please contact the support team with the number at the top of this page.

Purchase Details

For future reference, please record the following information which can be found on the rating plate and the date of purchase which can be found on your sales invoice.

STORE DETAILS

STORE NAME | _____

ADDRESS | _____

TELEPHONE | _____ PURCHASE DATE | _____

PRODUCT DETAILS

MODEL NO. | _____

SERIAL NO. | _____

Attach your receipt
to this page



Warranty Information

AUSTRALIAN WARRANTY TERMS AND CONDITIONS

CLOTHES DRYERS

This document sets out the terms and conditions of the product warranties for Residentia Group Appliances. It is an important document. Please keep it with your proof of purchase documents in a safe place for future reference should you require service for your Appliance.

1. In this warranty
 - (a) 'acceptable quality' as referred to in clause 10 of this warranty has the same meaning referred to in the ACL;
 - (b) 'ACL' means Trade Practices Amendment (Australian Consumer Law) Act (No.2) 2010;
 - (c) 'Appliance' means any Residentia Group product purchased by you accompanied by this document;
 - (d) 'ASR' means Residentia Group authorised service representative;
 - (e) 'Residentia Group' means Residentia Group Pty Ltd of 165 Barkly Ave, Burnley VIC 3121, ACN 70 600 546 656 in respect of Appliances purchased in Australia;
 - (f) 'major failure' as referred to in clause 10 of this warranty has the same meaning referred to in the ACL and includes a situation when an Appliance cannot be repaired or it is uneconomic for Residentia Group, at its discretion, to repair an Appliance during the Warranty Period;
 - (g) 'Warranty Period' means:
 - (i) where the Appliance is used for personal, domestic or household use (i.e. normal single family use) as set out in the instruction manual, the Appliance is warranted against manufacturing defects for 24 months (or 36 months where a valid extended warranty registration has occurred), following the date of original purchase of the Appliance;
 - (h) 'you' means the purchaser of the Appliance not having purchased the Appliance for re-sale, and 'your' has a corresponding meaning.
2. This warranty only applies to Appliances purchased and used in Australia and is in addition to (and does not exclude, restrict, or modify in any way) any non-excludable statutory warranties in Australia.
3. During the Warranty Period Residentia Group or its ASR will, at no extra charge if your Appliance is readily accessible for service, without special equipment and subject to these terms and conditions, repair or replace any parts which it considers to be defective. Residentia Group or its ASR may use remanufactured parts to repair your Appliance. You agree that any replaced Appliances or parts become the property of Residentia Group. This warranty does not apply to light globes, batteries, seals, filters or similar perishable parts.
4. Parts and Appliances not supplied by Residentia Group are not covered by this warranty.
5. You will bear the cost of transportation, travel and delivery of the Appliance to and from Residentia Group or its ASR. If you reside outside of the service area, you will bear the cost of:
 - (a) travel of an authorised representative;
 - (b) transportation and delivery of the Appliance to and from Residentia Group or its ASR, in all instances, unless the Appliance is transported by Residentia Group or its ASR, the Appliance is transported at the owner's cost and risk while in transit to and from Residentia Group or its ASR.
6. Proof of purchase is required before you can make a claim under this warranty.

SCAN ME

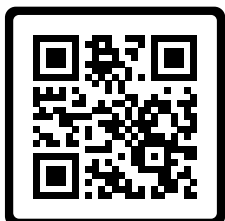

Scan to Register your InAlto Appliance or go to:
www.inalto.house/en-au/registration

By registering your product, you will receive advanced support, stay updated with the latest from InAlto and find out about new products and promotions.

Warranty Information (Continued)

7. You may not make a claim under this warranty unless the defect claimed is due to faulty or defective parts or workmanship. Residentia Group is not liable in the following situations (which are not exhaustive):
 - (a) the Appliance is damaged by:
 - (i) accident
 - (ii) misuse or abuse, including failure to properly maintain or service
 - (iii) normal wear and tear
 - (iv) power surges, electrical storm damage or incorrect power supply
 - (v) incomplete or improper installation
 - (vi) incorrect, improper or inappropriate operation
 - (vii) insect or vermin infestation
 - (viii) failure to comply with any additional instructions supplied with the Appliance;
 - (b) the Appliance is modified without authority from Residentia Group in writing;
 - (c) the Appliance's serial number or warranty seal has been removed or defaced;
 - (d) the Appliance was serviced or repaired by anyone other than Residentia Group, an authorised repairer or ASR.
8. This warranty, the contract to which it relates and the relationship between you and Residentia Group are governed by the law applicable where the Appliance was purchased.
9. To the extent permitted by law, Residentia Group excludes all warranties and liabilities (other than as contained in this document) including liability for any loss or damage whether direct or indirect arising from your purchase, use or non use of the Appliance.
10. For Appliances and services provided by Residentia Group in Australia, the Appliances come with a guarantee by Residentia Group that cannot be excluded under the Australian Consumer Law. You are entitled to a replacement or refund for a major failure and for compensation for any other reasonably foreseeable loss or damage. You are also entitled to have the Appliance repaired or replaced if the Appliance fails to be of acceptable quality and the failure does not amount to a major failure. The benefits to you given by this warranty are in addition to your other rights and remedies under a law in relation to the Appliances or services to which the warranty relates.
11. At all times during the Warranty Period, Residentia Group shall, at its discretion, determine whether repair, replacement or refund will apply if an Appliance has a valid warranty claim applicable to it.
12. Missing parts are not covered by warranty. Residentia Group reserves the right to assess each request for missing parts in a case by case basis. Any parts that are not reported missing in the first week after purchase will not provide free of charge.
13. To enquire about claiming under this warranty, please follow these steps:
 - (a) carefully check the operating instructions, user manual and the terms of this warranty;
 - (b) have the model and serial number of the Appliance available;
 - (c) have the proof of purchase (e.g. an invoice) available;
 - (d) telephone the numbers shown below.
14. You accept that if you make a warranty claim, Residentia Group and its ASR may exchange information in relation to you, in order to enable Residentia Group to meet its obligations under this warranty.

IMPORTANT

Before calling for service, please ensure that the steps in point 13 have been followed.

Contact Service: Please call 1300 11 HELP (4357)

The Australian Consumer Law requires the inclusion of the following statement with this warranty:

Our goods come with guarantees that cannot be excluded under the Australian Consumer Law. You are entitled to a replacement or refund for a major failure and for compensation for any other reasonably foreseeable loss or damage. You are also entitled to have the goods repaired or replaced if the goods fail to be of acceptable quality and the failure does not amount to a major failure.

This page is intentionally
left blank

Warranty Information (Continued)

NEW ZEALAND WARRANTY TERMS AND CONDITIONS

CLOTHES DRYERS

To help care for your investment, be sure to register your appliance online. Registration will help you if you need to arrange service in the future, and serves as a record of your purchase – including critical information like model number and serial number – that you can refer to at any time.

Simply visit the below website, or ask your retailer for help: www.inalto.house/en-nz/registration

WARRANTY

These products are covered by a warranty for a period of 24 months from the date of purchase, subject to the following conditions*. The warranty covers rectification free of charge of any fault arising from defective materials or components, or faulty workmanship or assembly.

* The conditions above mentioned are:

1. That the purchaser carefully follows all instructions packed with the product;
2. That the purchaser and/or installer carefully follows the installation instructions provided and complies with electrical wiring regulations, gas and/or plumbing codes;
3. That the purchaser carefully follows instructions provided in the owner's handbook relating to the proper use and care of the product and does not use the product for any purpose other than the domestic use for which it has been designed;
4. Commercial use of the product for professional or industrial purposes will void this warranty.;
5. That the product was purchased and installed in New Zealand;
6. That this warranty does not extend to:
 - a) optional glass lids for hobs apart from claims which relate to mechanical or physical damage thereof at the date of purchase;
 - b) 'consumable' parts such as light bulbs or filters;
 - c) damage to ceramic glass caused by liquid or solid spill-overs, lack of maintenance, or impact;
 - d) damage to surface coatings caused by cleaning or maintenance using products not recommended by the owner's handbook;
 - e) defects caused by normal wear and tear, accident, negligence, alteration, misuse or incorrect installations;
 - f) a product dismantled, repaired or serviced by any serviceman other than an authorised service agent;

- g) a product not in possession of the original purchaser;
 - h) damage caused by power outages or surges
 - i) damage caused by pests (eg. rats, cockroaches etc.)
7. That if the product is a freestanding microwave oven or small appliance it must be returned to the dealer/retailer for servicing. These products, unless stated otherwise, have a 12 month warranty from original date of purchase with 24 months on the microwave magnetron; Waste disposers have a 12 month warranty.
8. The provision of service under this warranty is limited by a 25km boundary from the retailer where the product was purchased except for microwaves. Such travelling outside of these limits will incur commercial cost to be paid by you, regulated by the number of kilometres travelled beyond the 25km limit (50km return trip). Microwaves are to be delivered to the nearest authorised service agent by the customer.

Please refer to your user manual for any further conditions that may apply to your specific model.

Nothing herein contained shall be construed in any way as excluding or limiting your rights under the Consumer Guarantees Acts 1993.

For Service please visit www.applico.co.nz/service or contact the dealer/retailer from whom you purchased the product from or call the 0800 number listed below. If you are unable to establish the date of purchase, or the fault is not covered by this warranty, or if the product is found to be in working order, you will be required to bear all service call charges.

Registration of this warranty constitutes acceptance of the terms and conditions of this warranty.

Should you require any assistance, please call Customer Services on 0800 763 448.

Distributed by Applico Ltd.
www.applico.co.nz
July 2019

After registering your appliance online, we recommend you fill out the below information for your reference and keep this warranty card in a safe place.

THIS WARRANTY IS VALID IN NEW ZEALAND ONLY.

This page is intentionally
left blank

This page is intentionally
left blank

**Elevate
your home,
for less.**

INALTO?

WWW.INALTO.HOUSE



E2447